

AIP India  
**AIRCRAFT PARKING / DOCKING CHART**  
**GENERAL AVIATION**  
**APRON**

TWR NORTH 118.75  
 TWR MIDDLE 118.10

SMC NORTH 121.75  
 SMC MIDDLE 121.90

CLD 121.95  
 DCL DELCFYA

AD 2 VIDP 1-305  
 01 JUL 2019  
**INDIA/DELHI**  
**IGI AIRPORT**

DATUM: WGS 84  
 GEOID MODEL - EGM 2008  
 ELEVATIONS IN FEET  
 DIMENSIONS IN METRES  
 BEARINGS ARE MAGNETIC

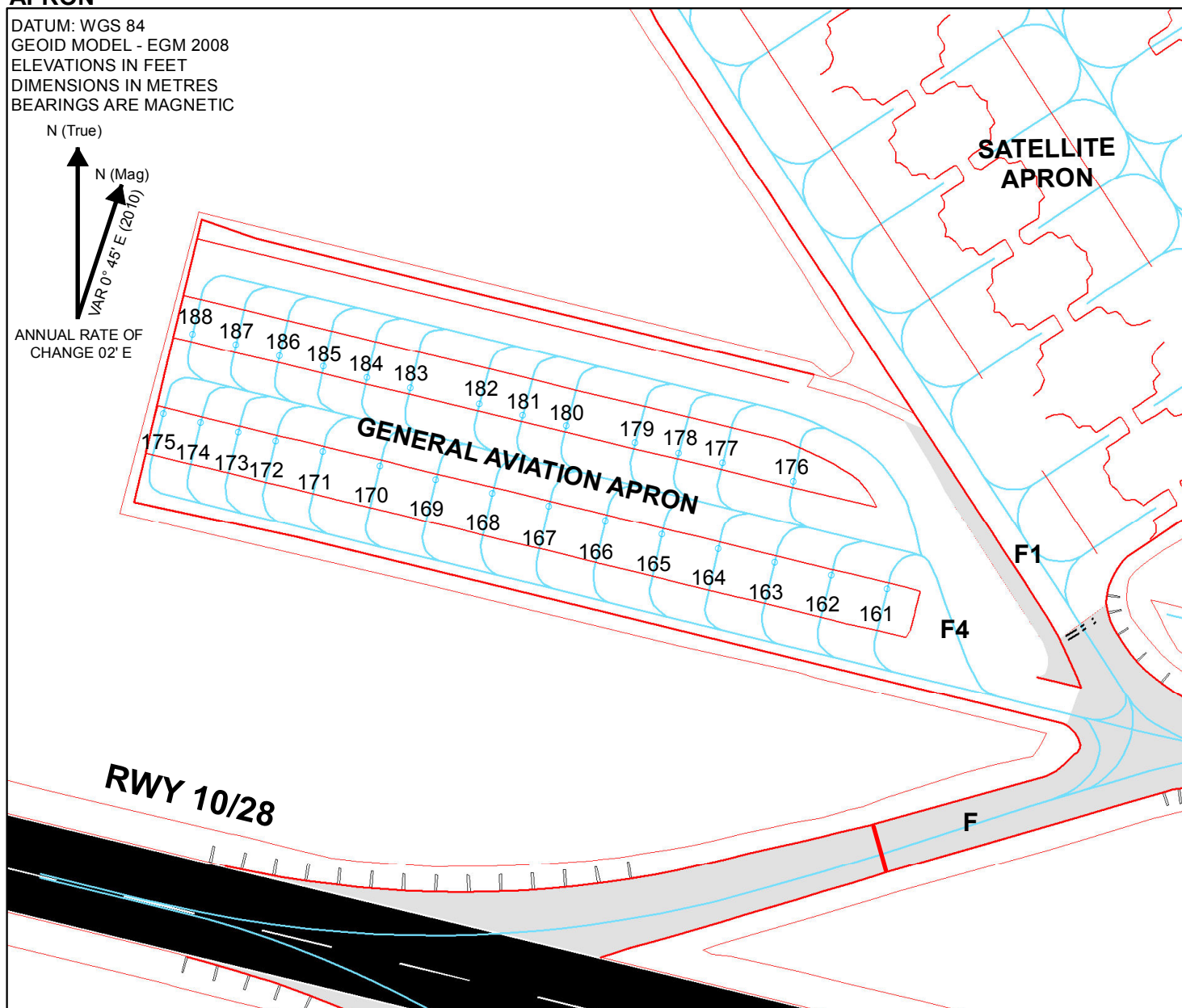
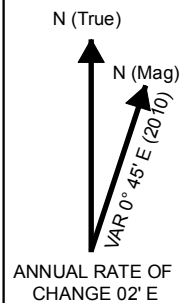

PARKING STAND DETAILS					
STAND NO.	PCN	WGS 84 CO-ORDINATES	TYPE OF AIRCRAFT (Max. Wing Span Upto)	REMARKS	CONTACT / REMOTE
161	26 / R / C / W / T	28° 33' 48.484" N 077° 06' 36.565" E	24 m	Power in - Power out	Remote
162	26 / R / C / W / T	28° 33' 48.722" N 077° 06' 35.607" E	24 m	Power in - Power out	Remote
163	26 / R / C / W / T	28° 33' 48.930" N 077° 06' 34.640" E	24 m	Power in - Power out	Remote
164	26 / R / C / W / T	28° 33' 49.157" N 077° 06' 33.674" E	24 m	Power in - Power out	Remote
165	26 / R / C / W / T	28° 33' 49.387" N 077° 06' 32.706" E	24 m	Power in - Power out	Remote
166	26 / R / C / W / T	28° 33' 49.604" N 077° 06' 31.736" E	24 m	Power in - Power out	Remote
167	26 / R / C / W / T	28° 33' 49.834" N 077° 06' 30.772" E	24 m	Power in - Power out	Remote
168	26 / R / C / W / T	28° 33' 50.050" N 077° 06' 29.802" E	24 m	Power in - Power out	Remote
169	26 / R / C / W / T	28° 33' 50.273" N 077° 06' 28.836" E	24 m	Power in - Power out	Remote
170	26 / R / C / W / T	28° 33' 50.495" N 077° 06' 27.871" E	24 m	Power in - Power out	Remote
171	26 / R / C / W / T	28° 33' 50.720" N 077° 06' 26.893" E	24 m	Power in - Power out	Remote
172	MAXIMUM AUW UPTO 5700 Kgs	28° 33' 50.907" N 077° 06' 26.084" E	15 m	Power in - Power out	Remote
173	MAXIMUM AUW UPTO 5700 Kgs	28° 33' 51.052" N 077° 06' 25.444" E	15 m	Power in - Power out	Remote
174	MAXIMUM AUW UPTO 5700 Kgs	28° 33' 51.200" N 077° 06' 24.803" E	15 m	Power in - Power out	Remote
175	MAXIMUM AUW UPTO 5700 Kgs	28° 33' 51.346" N 077° 06' 24.159" E	15 m	Power in - Power out	Remote
176	MAXIMUM AUW UPTO 5700 Kgs	28° 33' 51.495" N 077° 06' 23.522" E	18 m	Power in - Power out	Remote
177	MAXIMUM AUW UPTO 5700 Kgs	28° 33' 51.643" N 077° 06' 22.885" E	18 m	Power in - Power out	Remote
178	MAXIMUM AUW UPTO 5700 Kgs	28° 33' 51.792" N 077° 06' 22.248" E	18 m	Power in - Power out	Remote
179	MAXIMUM AUW UPTO 5700 Kgs	28° 33' 51.940" N 077° 06' 21.611" E	18 m	Power in - Power out	Remote
180	MAXIMUM AUW UPTO 5700 Kgs	28° 33' 52.088" N 077° 06' 20.974" E	18 m	Power in - Power out	Remote
181	MAXIMUM AUW UPTO 5700 Kgs	28° 33' 52.236" N 077° 06' 20.337" E	18 m	Power in - Power out	Remote
182	MAXIMUM AUW UPTO 5700 Kgs	28° 33' 52.384" N 077° 06' 19.700" E	18 m	Power in - Power out	Remote
183	MAXIMUM AUW UPTO 5700 Kgs	28° 33' 52.532" N 077° 06' 19.063" E	18 m	Power in - Power out	Remote
184	MAXIMUM AUW UPTO 5700 Kgs	28° 33' 52.680" N 077° 06' 18.426" E	18 m	Power in - Power out	Remote
185	MAXIMUM AUW UPTO 5700 Kgs	28° 33' 52.828" N 077° 06' 17.789" E	18 m	Power in - Power out	Remote
186	MAXIMUM AUW UPTO 5700 Kgs	28° 33' 52.976" N 077° 06' 17.152" E	18 m	Power in - Power out	Remote
187	MAXIMUM AUW UPTO 5700 Kgs	28° 33' 53.124" N 077° 06' 16.515" E	18 m	Power in - Power out	Remote
188	MAXIMUM AUW UPTO 5700 Kgs	28° 33' 53.272" N 077° 06' 15.878" E	18 m	Power in - Power out	Remote

Pre-flight altimeter check location  
 APRON ELEV. 750 ft.

LEGEND	
AIRCRAFT STAND	○
IHP	≡ ≡ ≡ ≡
BHP	—

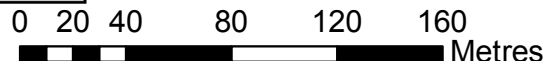

NOTE :  
 1. AERONAUTICAL GROUND LIGHTS ARE NOT AVAILABLE.  
 2. IHP - INTERMEDIATE HOLDING POSITION.  
 AERONAUTICAL INFORMATION UPTO JUNE 2016.

PRODUCING ORGANIZATION  
 DELHI INTERNATIONAL AIRPORT LIMITED  
 Airside.Planning@gmrgroup.in