

AERODROME CHART

ARP: 19° 05' 29.6" N
072° 51' 57.5" E

TWR 118.1
GND 121.9

MUMBAI, INDIA

AD ELEV. 40

COLOUR CODED AERODROME CHART FOR CONFIGURATION OF TWY/TAXILANE

CHHATRAPATI SHIVAJI MAHARAJ INTL AIRPORT

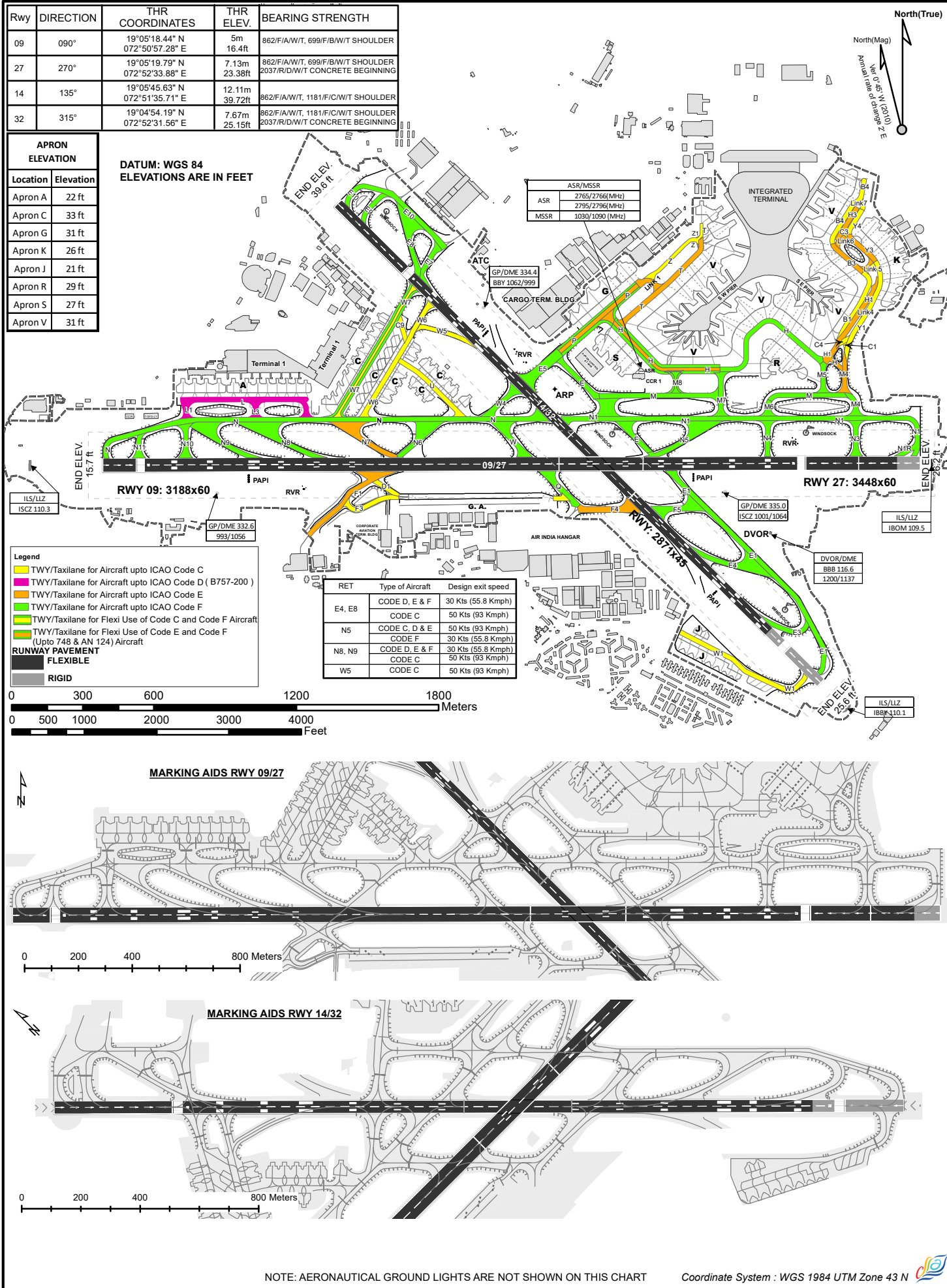

NOTE: AERONAUTICAL GROUND LIGHTS ARE NOT SHOWN ON THIS CHART

Coordinate System : WGS 1984 UTM Zone 43 N