

AIRCRAFT PARKING/  
DOCKING CHART

APRON ELEV - 33 ft

TWR 118.1  
GND 121.9

MUMBAI, INDIA

APRON - C

CHHATRAPATI SHIVAJI MAHARAJ INTL AIRPORT

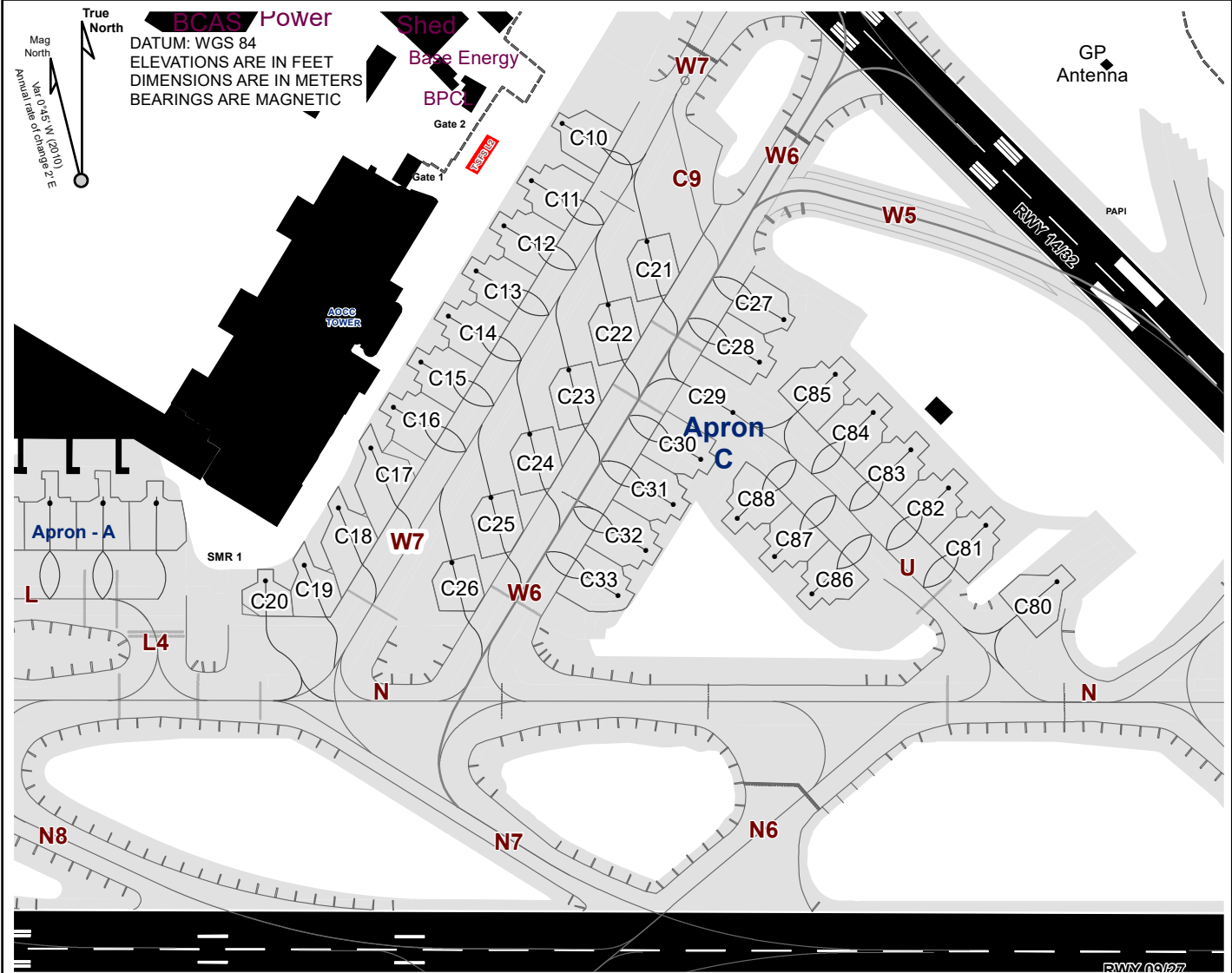

Scale : 1:5000

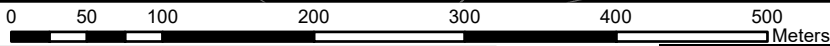

Stand No.	Latitude	Longitude	Type of Aircraft	PCN	Contact Remote	Remarks
C10	19° 05' 39.40" N	072° 51' 32.06" E	ATR 72	150 / R / D / W / T	REMOTE	Power in-push back
C11	19° 05' 37.98" N	072° 51' 31.28" E	B-739, A-321	150 / R / D / W / T	REMOTE	Power in-push back
C12	19° 05' 36.84" N	072° 51' 30.58" E	B-739, A-321	150 / R / D / W / T	REMOTE	Power in-push back
C13	19° 05' 35.71" N	072° 51' 29.88" E	B-739, A-321	150 / R / D / W / T	REMOTE	Power in-push back
C14	19° 05' 34.57" N	072° 51' 29.18" E	B-739, A-321	150 / R / D / W / T	REMOTE	Power in-push back
C15	19° 05' 33.43" N	072° 51' 28.48" E	B-739, A-321	150 / R / D / W / T	REMOTE	Power in-push back
C16	19° 05' 32.29" N	072° 51' 27.78" E	B-739, A-321	150 / R / D / W / T	REMOTE	Power in-push back
C17	19° 05' 31.29" N	072° 51' 27.22" E	B-739, A-321	150 / R / D / W / T	REMOTE	Power in-push back
C18	19° 05' 29.78" N	072° 51' 26.40" E	B-739, A-321	150 / R / D / W / T	REMOTE	Power in-push back
C19	19° 05' 28.36" N	072° 51' 25.54" E	B-739, A-321	150 / R / D / W / T	REMOTE	Power in-push back
C20	19° 05' 27.95" N	072° 51' 24.53" E	ATR-72	150 / R / D / W / T	REMOTE	Power in-push back
C21	19° 05' 36.51" N	072° 51' 34.32" E	B-739, A-321	64 / F / A / W / T	REMOTE	Power in-power out (Entry from South side and exit through North side only)
C22	19° 05' 34.92" N	072° 51' 33.34" E	B-739, A-321	64 / F / A / W / T	REMOTE	
C23	19° 05' 33.30" N	072° 51' 32.34" E	B-739, A-321	64 / F / A / W / T	REMOTE	
C24	19° 05' 31.70" N	072° 51' 31.35" E	B-739, A-321	64 / F / A / W / T	REMOTE	
C25	19° 05' 30.10" N	072° 51' 30.37" E	B-739, A-321	64 / F / A / W / T	REMOTE	
C26	19° 05' 28.49" N	072° 51' 29.38" E	B-739, A-321	64 / F / A / W / T	REMOTE	
C27	19° 05' 34.63" N	072° 51' 37.92" E	Q-400	150 / R / D / W / T	REMOTE	
C28	19° 05' 33.56" N	072° 51' 37.30" E	B-739, A-321	150 / R / D / W / T	REMOTE	Power in-push back
C29	19° 05' 32.31" N	072° 51' 36.64" E	B-739, A-321	150 / R / D / W / T	REMOTE	Power in-push back
C30	19° 05' 31.15" N	072° 51' 35.82" E	B-739, A-321	150 / R / D / W / T	REMOTE	Power in-push back
C31	19° 05' 30.01" N	072° 51' 35.12" E	B-739, A-321	150 / R / D / W / T	REMOTE	Power in-push back
C32	19° 05' 28.87" N	072° 51' 34.43" E	B-739, A-321	150 / R / D / W / T	REMOTE	Power in-push back
C33	19° 05' 27.73" N	072° 51' 33.72" E	B-739, A-321	150 / R / D / W / T	REMOTE	Power in-push back
C80	19° 05' 28.278" N	072° 51' 45.160" E	B-737-800WL, Q400	64 / F / A / W / T	Remote	Power in-pushback
C81	19° 05' 29.647" N	072° 51' 43.284" E	B-737-800WL, A320	150 / R / D / W / T	Remote	Power in-pushback
C82	19° 05' 30.551" N	072° 51' 42.291" E	B-737-900, A321	150 / R / D / W / T	Remote	Power in-pushback
C83	19° 05' 31.469" N	072° 51' 41.287" E	B-737-900, A321	150 / R / D / W / T	Remote	Power in-pushback
C84	19° 05' 32.382" N	072° 51' 40.290" E	B-737-900, A321	150 / R / D / W / T	Remote	Power in-pushback
C85	19° 05' 33.303" N	072° 51' 39.288" E	B-737-900, A320	150 / R / D / W / T	Remote	Power in-pushback
C86	19° 05' 27.865" N	072° 51' 38.775" E	B-737-900, A320	150 / R / D / W / T	Remote	Power in-pushback
C87	19° 05' 28.776" N	072° 51' 37.785" E	B-737-900, A320	150 / R / D / W / T	Remote	Power in-pushback
C88	19° 05' 29.697" N	072° 51' 36.794" E	B-737-900, A320	150 / R / D / W / T	Remote	Power in-pushback

Taxi Way	PCN
W5	58 / R / D / W / T (From edge of RWY for a length of 150m)
	56 / R / B / W / T (From edge of rigid portion up to TWY K3 for a length of 84m)
W6	150 / R / D / W / T
W7	149 / R / D / W / T
N	150 / R / D / W / T (from RWY 09/27 upto TWY N7/N Junction)
	64 / F / A / W / T (from TWY N7/N upto TWY N6/N Junction)
	150 / R / D / W / T (from TWY N6/N Junction upto RWY 14/32)
	71 / F / B / W / U
N6	71 / F / B / W / U
N7	79 / R / C / W / T
U	66 / R / D / W / T
L4	85 / R / B / W / T
C9	64 / F / A / W / T

NOTE : AERONAUTICAL GROUND LIGHTS ARE NOT SHOWN IN THIS CHART

Coordinate System : WGS 1984 UTM Zone 43 N