

**AIRCRAFT PARKING / DOCKING CHART**  
**APRON 35**

TWR MIDDLE 118.10  
TWR SOUTH 125.85

SMC MIDDLE 121.90  
SMC SOUTH 121.625

CLD 121.95  
DCL DELCFYA

**INDIA/DELHI**  
**IGI AIRPORT**

DATUM: WGS 84  
GEOID MODEL - EGM 2008  
ELEVATIONS IN FEET  
DIMENSIONS IN METRES  
BEARINGS ARE MAGNETIC

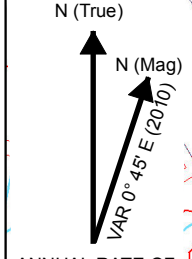

ANNUAL RATE OF CHANGE 02' E

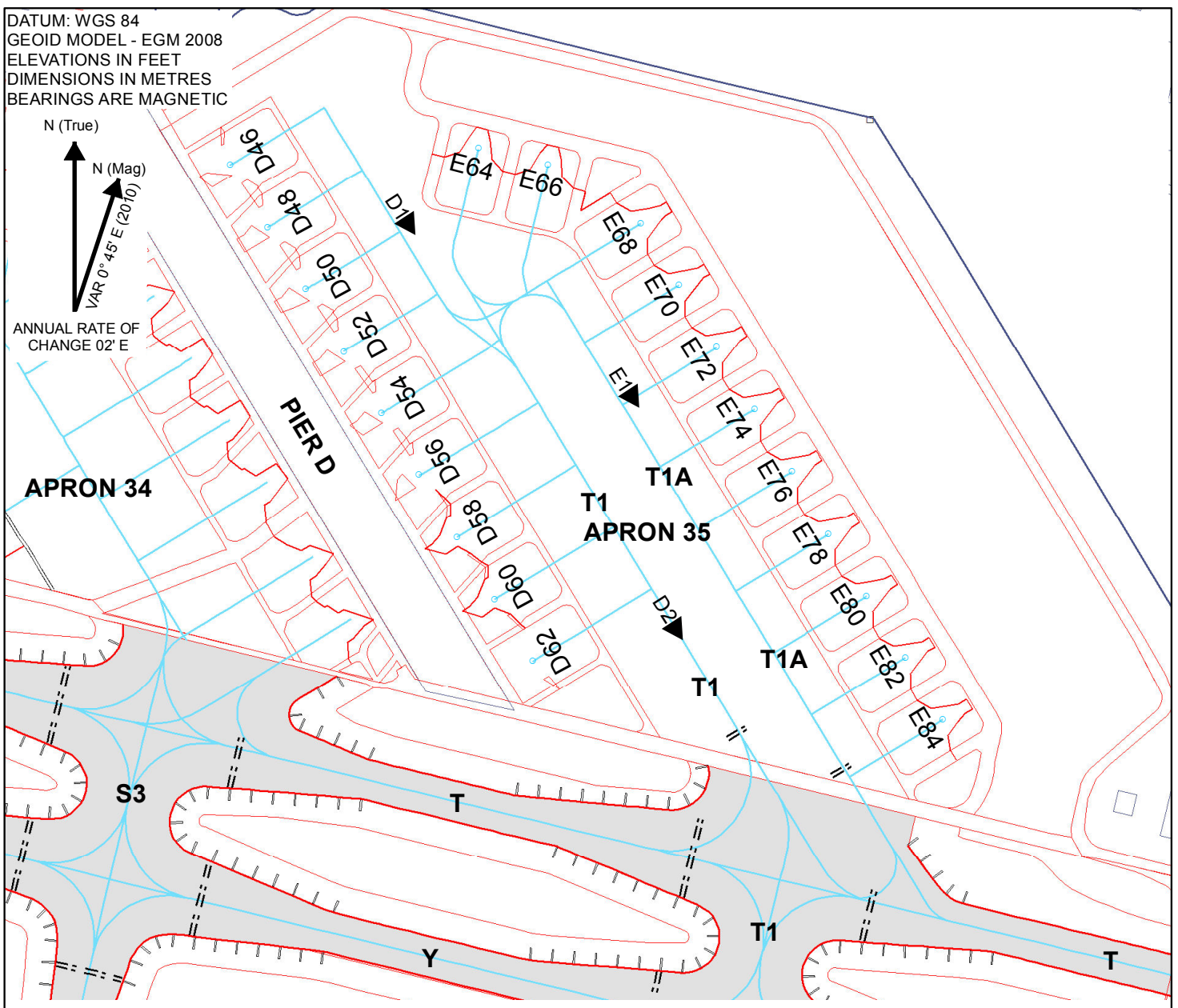

PARKING STAND DETAILS

STAND NO.	PCN	WGS 84 CO-ORDINATES		TYPE OF AIRCRAFT	REMARKS	CONTACT / REMOTE
D 46	110 / R / C / W / T	28° 33' 07.414" N	077° 05' 18.467" E	CODE-C	Power in - Push back	Contact
D 48	110 / R / C / W / T	28° 33' 06.153" N	077° 05' 19.299" E	CODE-C	Power in - Push back	Contact
D 50	110 / R / C / W / T	28° 33' 04.891" N	077° 05' 20.142" E	CODE-C	Power in - Push back	Contact
D 52	110 / R / C / W / T	28° 33' 03.628" N	077° 05' 20.977" E	CODE-C	Power in - Push back	Contact
D 54	110 / R / C / W / T	28° 33' 02.368" N	077° 05' 21.812" E	CODE-C	Power in - Push back	Contact
D 56	110 / R / C / W / T	28° 33' 01.105" N	077° 05' 22.649" E	CODE-C	Power in - Push back	Contact
D 58	110 / R / C / W / T	28° 32' 59.844" N	077° 05' 23.484" E	CODE-C	Power in - Push back	Contact
D 60	110 / R / C / W / T	28° 32' 58.582" N	077° 05' 24.319" E	CODE-C	Power in - Push back	Contact
D 62	110 / R / C / W / T	28° 32' 57.322" N	077° 05' 25.160" E	CODE-C	Power in - Push back	Contact
E 64	110 / R / C / W / T	28° 33' 07.664" N	077° 05' 24.129" E	CODE-C	Power in - Push back	Remote
E 66	110 / R / C / W / T	28° 33' 07.304" N	077° 05' 25.705" E	CODE-C	Power in - Push back	Remote
E 68	110 / R / C / W / T	28° 33' 06.097" N	077° 05' 27.804" E	CODE-C	Power in - Push back	Remote
E 70	110 / R / C / W / T	28° 33' 04.835" N	077° 05' 28.642" E	CODE-C	Power in - Push back	Remote
E 72	110 / R / C / W / T	28° 33' 03.573" N	077° 05' 29.479" E	CODE-C	Power in - Push back	Remote
E 74	110 / R / C / W / T	28° 33' 02.313" N	077° 05' 30.315" E	CODE-C	Power in - Push back	Remote
E 76	110 / R / C / W / T	28° 33' 01.051" N	077° 05' 31.153" E	CODE-C	Power in - Push back	Remote
E 78	110 / R / C / W / T	28° 32' 59.773" N	077° 05' 31.957" E	CODE-C	Power in - Push back	Remote
E 80	110 / R / C / W / T	28° 32' 58.511" N	077° 05' 32.791" E	CODE-C	Power in - Push back	Remote
E 82	110 / R / C / W / T	28° 32' 57.265" N	077° 05' 33.655" E	CODE-C	Power in - Push back	Remote
E 84	110 / R / C / W / T	28° 32' 56.003" N	077° 05' 34.491" E	CODE-C	Power in - Push back	Remote

Pre-flight altimeter check location  
Complete APRON  
APRON ELEV. 737 ft.

LEGEND	
AIRCRAFT STAND	○
IHP	====
TUG DISCONNECT POINT	▶

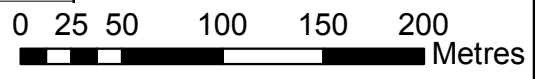

- NOTES :
1. AERONAUTICAL GROUND LIGHTS ARE NOT SHOWN IN THIS CHART.
  2. AIRCRAFT VISUAL MANOEUVRING GUIDANCE LIGHTS (ASMG) IS AVAILABLE AT EACH STAND.
  3. ADVANCE VISUAL DOCKING GUIDANCE SYSTEM (AVDGS) NOT AVAILABLE FROM STAND E64-E84.
  4. IHP - INTERMEDIATE HOLDING POSITION.

AERONAUTICAL INFORMATION UPTO JUNE 2016.

PRODUCING ORGANIZATION  
DELHI INTERNATIONAL AIRPORT LIMITED  
Airside.Planning@gmrgroup.in