

AIRCRAFT PARKING / DOCKING CHART

APRON ELEVATION
1991.4 FT

TWR : 118.450 MHz
GND : 121.850 MHz

INDIA / SHAMSHABAD
(HYDERABAD)

APRON PASSENGER TERMINAL

RAJIV GANDHI INTL. AIRPORT

DATUM: WGS 84
ELEVATION ARE IN FEET
DIMENSIONS ARE IN METER
BEARING ARE MAGNETIC

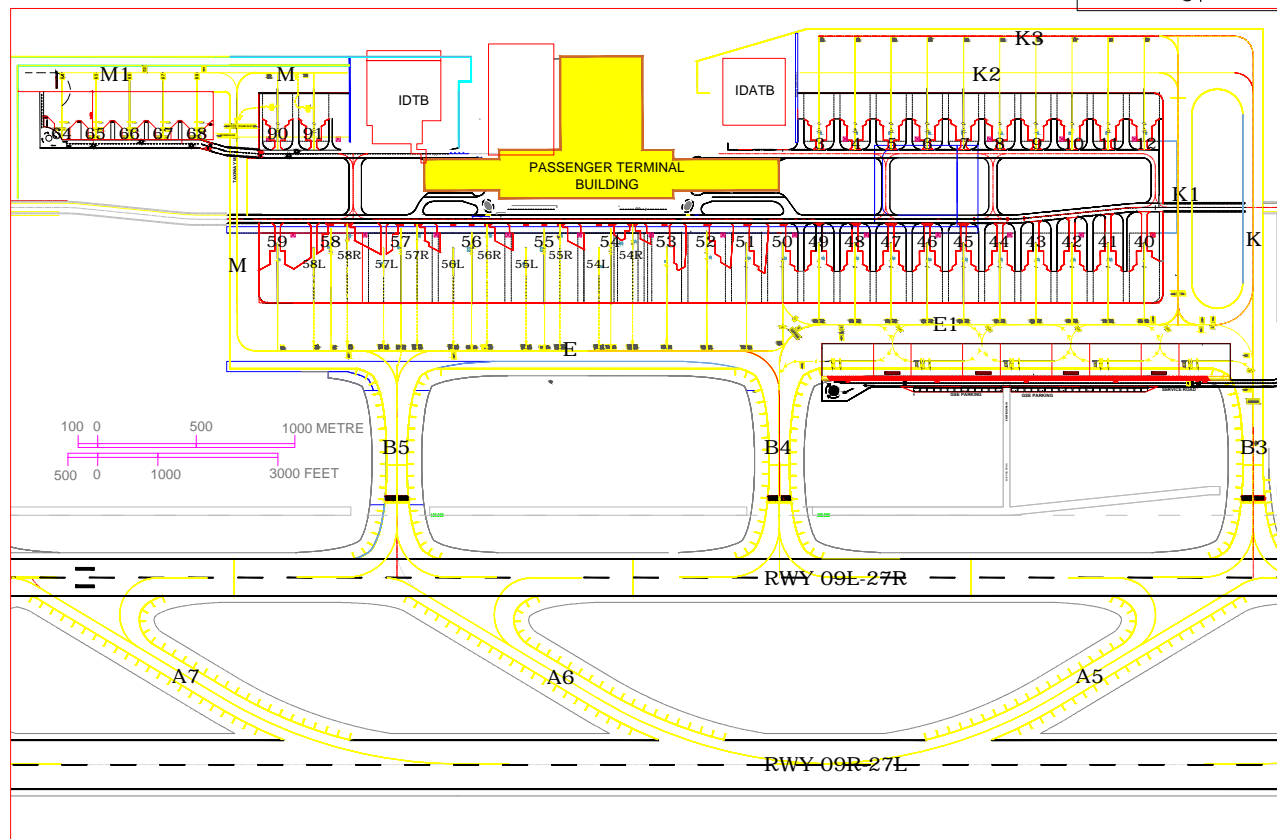
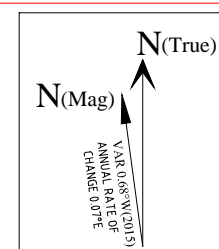

AIRCRAFT STAND	WGS 84 COORDINATES DD MM SS.SS		TYPE OF AIRCRAFT
3	17° 14' 08.62" N	078° 25' 55.30"E	CODE C
4	17° 14' 08.64" N	078° 25' 56.78"E	CODE C
5	17° 14' 08.66" N	078° 25' 58.25"E	CODE C
6	17° 14' 08.68" N	078° 25' 59.72"E	CODE C
7	17° 14' 08.70" N	078° 26' 01.19"E	CODE C
8	17° 14' 08.72" N	078° 26' 02.66"E	CODE C
9	17° 14' 08.74" N	078° 26' 04.14"E	CODE C
10	17° 14' 08.76" N	078° 26' 05.61"E	CODE C
11	17° 14' 08.78" N	078° 26' 07.08"E	CODE C
12	17° 14' 08.81" N	078° 26' 08.55"E	CODE C

AIRCRAFT STAND	WGS 84 COORDINATES DD MM SS.SS		TYPE OF AIRCRAFT
90	17° 14' 08.31" N	078° 25' 33.28"E	CODE C & Q 400
91	17° 14' 08.33" N	078° 25' 34.75"E	CODE C & Q 400
64	17° 14' 08.30" N	078° 25' 24.49"E	ATR & Q 400
65	17° 14' 08.31" N	078° 25' 25.87"E	CODE C & Q 400
66	17° 14' 08.33" N	078° 25' 27.33"E	CODE C & Q 400
67	17° 14' 08.35" N	078° 25' 28.61"E	CODE C & Q 400
68	17° 14' 08.37" N	078° 25' 29.97"E	CODE C & Q 400

AIRCRAFT STAND	WGS 84 COORDINATES DD MM SS.SS		TYPE OF AIRCRAFT
40	17° 14' 03.77" N	078° 26' 08.63"E	CODE C & Q 400
41	17° 14' 03.75" N	078° 26' 07.16"E	CODE C & Q 400
42	17° 14' 03.73" N	078° 26' 05.68"E	CODE C & Q 400
43	17° 14' 03.71" N	078° 26' 04.21"E	CODE C & Q 400
44	17° 14' 03.69" N	078° 26' 02.74"E	CODE C & Q 400
45	17° 14' 03.67" N	078° 26' 01.27"E	CODE C & Q 400
46	17° 14' 03.65" N	078° 25' 59.80"E	CODE C & Q 400
47	17° 14' 03.68" N	078° 25' 58.32"E	CODE C & Q 400
48	17° 14' 03.61" N	078° 25' 56.85"E	CODE C & Q 400
49	17° 14' 03.58" N	078° 25' 55.38"E	CODE C & Q 400
50	17° 14' 03.55" N	078° 25' 53.92"E	CODE C
51	17° 14' 03.53" N	078° 25' 52.45"E	CODE C
52	17° 14' 03.96" N	078° 25' 50.80"E	CODE C
53	17° 14' 03.34" N	078° 25' 49.19"E	CODE C
54L	17° 14' 03.29" N	078° 25' 46.43"E	CODE C
54	17° 14' 04.05" N	078° 25' 46.91"E	CODE E
54R	17° 14' 04.24" N	078° 25' 47.79"E	CODE C
55L	17° 14' 03.24" N	078° 25' 43.47"E	CODE C
55	17° 14' 04.01" N	078° 25' 44.20"E	CODE F
55R	17° 14' 04.37" N	078° 25' 44.82"E	CODE C
56L	17° 14' 03.19" N	078° 25' 40.49"E	CODE C
56	17° 14' 03.95" N	078° 25' 41.23"E	CODE F
56R	17° 14' 04.33" N	078° 25' 41.86"E	CODE C
57L	17° 14' 03.15" N	078° 25' 37.64"E	CODE C
57	17° 14' 03.91" N	078° 25' 38.34"E	CODE E
57R	17° 14' 04.13" N	078° 25' 39.00"E	CODE C
58L	17° 14' 03.11" N	078° 25' 34.79"E	CODE C
58	17° 14' 03.87" N	078° 25' 35.49"E	CODE E
58R	17° 14' 04.06" N	078° 25' 36.15"E	CODE C
59	17° 14' 03.27" N	078° 25' 33.35"E	CODE C
NP7	17° 13' 59.85" N	078° 26' 10.55" E	CODE C & Q 400
NP8	17° 13' 59.80" N	078° 26' 06.93" E	CODE C & Q 400
NP9	17° 13' 59.75" N	078° 26' 03.28" E	CODE C & Q 400
NP10	17° 13' 59.71" N	078° 25' 59.66" E	CODE C & Q 400
NP11	17° 13' 59.66" N	078° 25' 56.04" E	CODE C & Q 400

TAXIWAY / TAXILANE DETAILS		
TAXIWAY	WIDTH	PCN
B3	25.0 M	77/F/B/W/T
B4	25.0 M	77/F/B/W/T
B5	25.0 M	77/F/B/W/T
E	25.0 M	77/F/B/W/T
K	25.0 M	77/F/B/W/T
K1	18.6 M	73/F/B/W/T
K2	18.0 M	73/F/B/W/T
K3	18.0 M	73/F/B/W/T
M	18.6 M	73/F/B/W/T
M1	18.6 M	60/F/B/W/T
E1	18.6 M	77/F/B/W/T

AIRCRAFT STAND	PCN
03 TO 12	62/R/C/W/T
40 TO 59	88/R/C/W/T
90 TO 91	62/R/C/W/T
64 TO 68	71/R/B/W/T
NP7-NP11	77/F/B/W/T
CONTACT AIRCRAFT STAND	
50 TO 56	

NOTE : AERONAUTICAL GROUND LIGHTS ARE NOT SHOWN ON THIS CHART

DATE OF AERONAUTICAL INFORMATION:

PRODUCING ORGANISATION: GMR HYDERABAD INTERNATIONAL AIRPORT LTD.