

**SHAMSHABAD
(HYDERABAD), INDIA**
RAJIV GANDHI INTL. AIRPORT

AIRCRAFT PARKING /
DOCKING CHART

APRON ELEV 1980 ft.

TWR 118.450 MHz
GND : 121.850 MHz

- DATUM : WGS-84
- DIMENSIONS IN METER
- ELEVATIONS IN FEET
- BEARINGS ARE MAGNETIC
- ALL ELEVATIONS ARE W.R.T EGM 2008

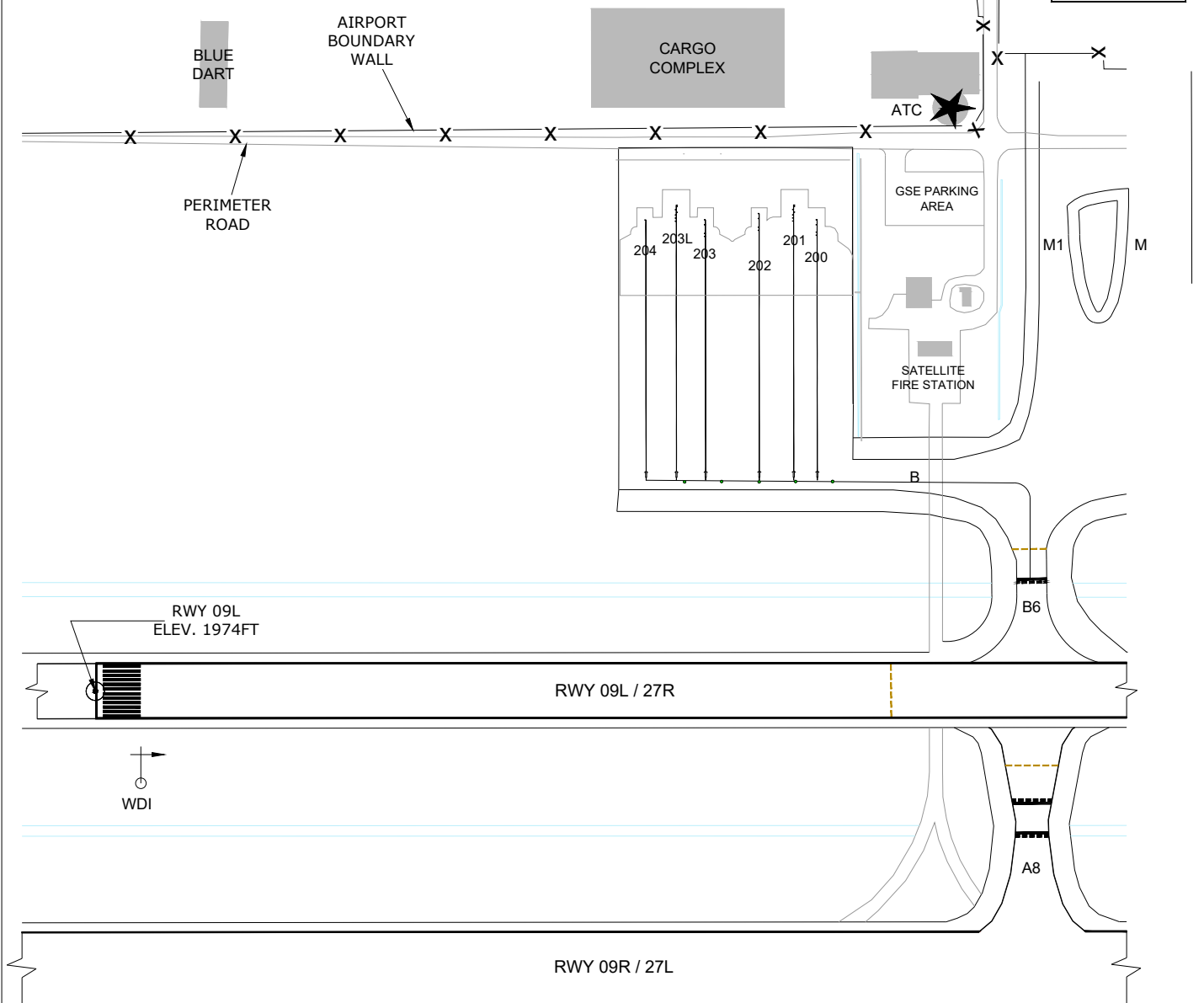
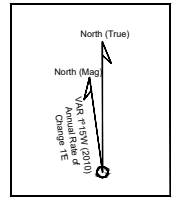

AIRCRAFT STAND	WGS 84 COORDINATES DD MM SS.SS		TYPE OF AIRCRAFT	PCN	REMARKS	CONTACT / REMOTE
200	17° 14' 03.23" N	078° 25' 14.56" E	CODE C	114/R/B/W/T	POWER IN - PUSH BACK	REMOTE
201	17° 14' 03.57" N	078° 25' 13.76" E	CODE F	114/R/B/W/T	POWER IN - PUSH BACK	REMOTE
202	17° 14' 03.19" N	078° 25' 12.97" E	CODE C	114/R/B/W/T	POWER IN - PUSH BACK	REMOTE
203	17° 14' 03.01" N	078° 25' 11.49" E	CODE C	114/R/B/W/T	POWER IN - PUSH BACK	REMOTE
203 L	17° 14' 03.53" N	078° 25' 10.54" E	CODE F	114/R/B/W/T	POWER IN - PUSH BACK	REMOTE
204	17° 14' 03.17" N	078° 25' 09.86" E	CODE C	114/R/B/W/T	POWER IN - PUSH BACK	REMOTE

TAXIWAY DETAILS		
TAXIWAY	WIDTH	PCN
B	23M	77/F/B/W/T
B6	25M	77/F/B/W/T
A8	25M	77/F/B/W/T

LEGEND	
RWY-HOLDING POSITION	
INTERMEDIATE HOLDING POSITION	
AIRCRAFT STAND (NOSE WHEEL POSITION)	
DRAIN	
TDP - TUG DISCONNECT POINT	
NSW - NOSE WHEEL STOP POSITION	

