

**AERODROME  
CHART**

**28°10'32"N  
077°36'22"E**

**ELEV. 653 Ft**

**TWR 118.675 MHz  
SMC 121.250 MHz  
DELIVERY 121.075 MHz**

**NOIDA / INDIA  
NOIDA INTERNATIONAL  
AIRPORT**

RWY	DIRECTION	THR. COORDINATES	THR. ELEV.	BEARING STRENGTH
RWY 10	101°	28°11'00.48"N 077°35'32.79"E	653 FT	1180/R/C/W/T- 0m to 258m
				790/F/C/W/T- 258m to 3487m
				1180/R/C/W/T- 3487m to 3900m
RWY 28	281°	28°10'34.71"N 077°37'52.69"E	650 FT	1180/R/C/W/T- 0m to 413m
				790/F/C/W/T- 413m to 3642m
				1180/R/C/W/T- 3642m to 3900m

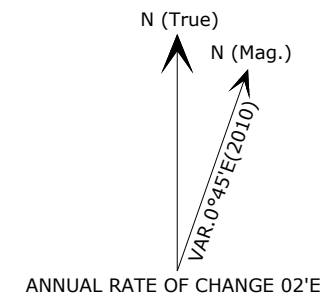
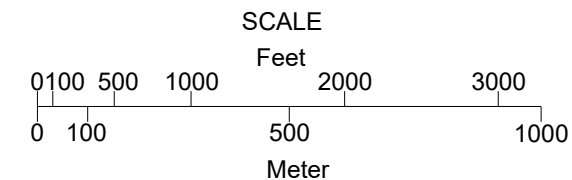

- DATUM: WGS-84
- ELEVATIONS IN FEET
- DIMENSIONS IN METER
- RWY BEARINGS ARE MAGNETIC
- ALL ELEVATIONS ARE W.R.T EGM 2008

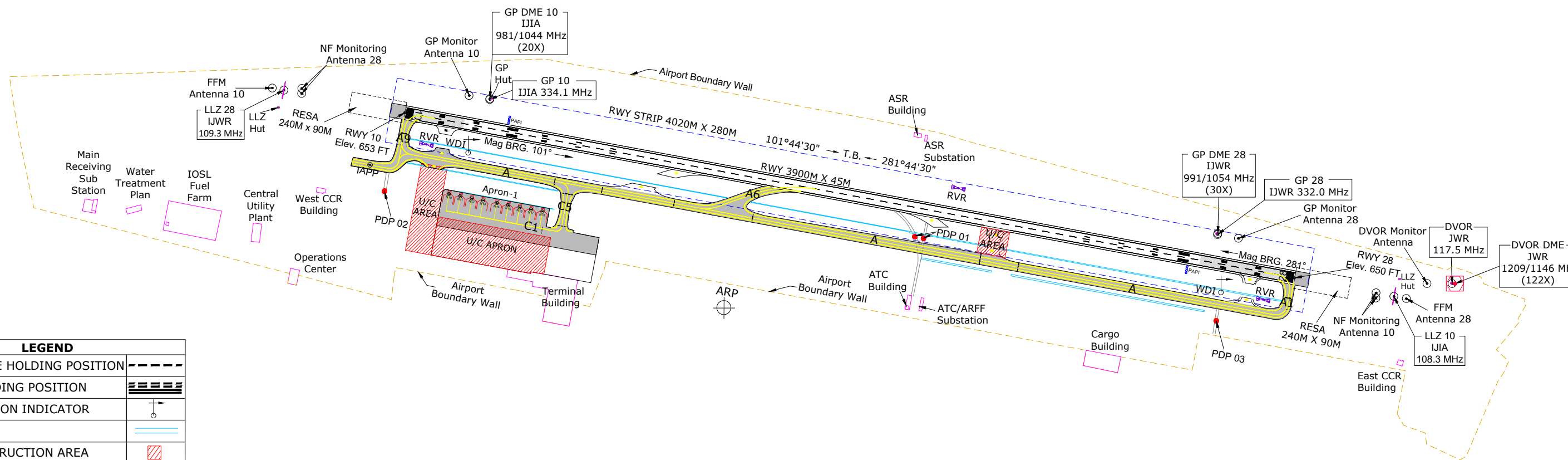

LEGEND	
INTERMEDIATE HOLDING POSITION	--- ---
RUNWAY HOLDING POSITION	==== ====
WIND DIRECTION INDICATOR	↗
DRAIN	====
UNDER CONSTRUCTION AREA	▨
PDP	●

**RWY 10/28 MARKING AIDS AND EXIT WAY**

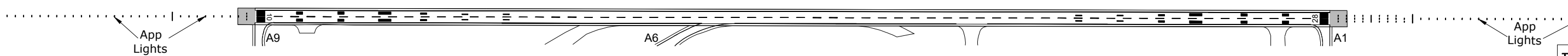

TAXIWAY	PCR	WIDTH
A	790/F/C/W/T	23M
A1	1180/R/C/W/T	23M
A6	555/F/C/X/T	23M
C5	790/F/C/W/T	23M
A9	1180/R/C/W/T	23M

**NOTE: 1) ALL AERONAUTICAL GROUND LIGHTS ARE NOT SHOWN IN THIS CHART.**

DATE OF AERONAUTICAL INFORMATION JAN 2025

NOIDA INTERNATIONAL AIRPORT

DRG.No.- Flight Ops/Noida Airport/Aerodrome Chart/2-25