

AERODROME CHART

21° 10' 51.63277" N
081° 44' 18.78859" E

ELEV. 1044 ft

TWR 124.3 /
124.75

RAIPUR, INDIA
RAIPUR AIRPORT

RWY	DIRECTION	THR. CO-ORDINATES	ELEV. (ft.)	PCN	SURFACE
06	059°	21°10'35.21"N 081°43'54.22" E	1017 ft.	68/F/B/W/T	ASFALT
24	239°	21°11'11.33"N 081°44'58.26" E	1036 ft.		

- DATUM : WGS 84
- DIMENSIONS / LENGTHS ARE IN METRES.
- ELEVATIONS ARE IN FEET (EGM-08).
- BEARING ARE MAGNETIC.
- TAXIWAYS ARE 23 m WIDE

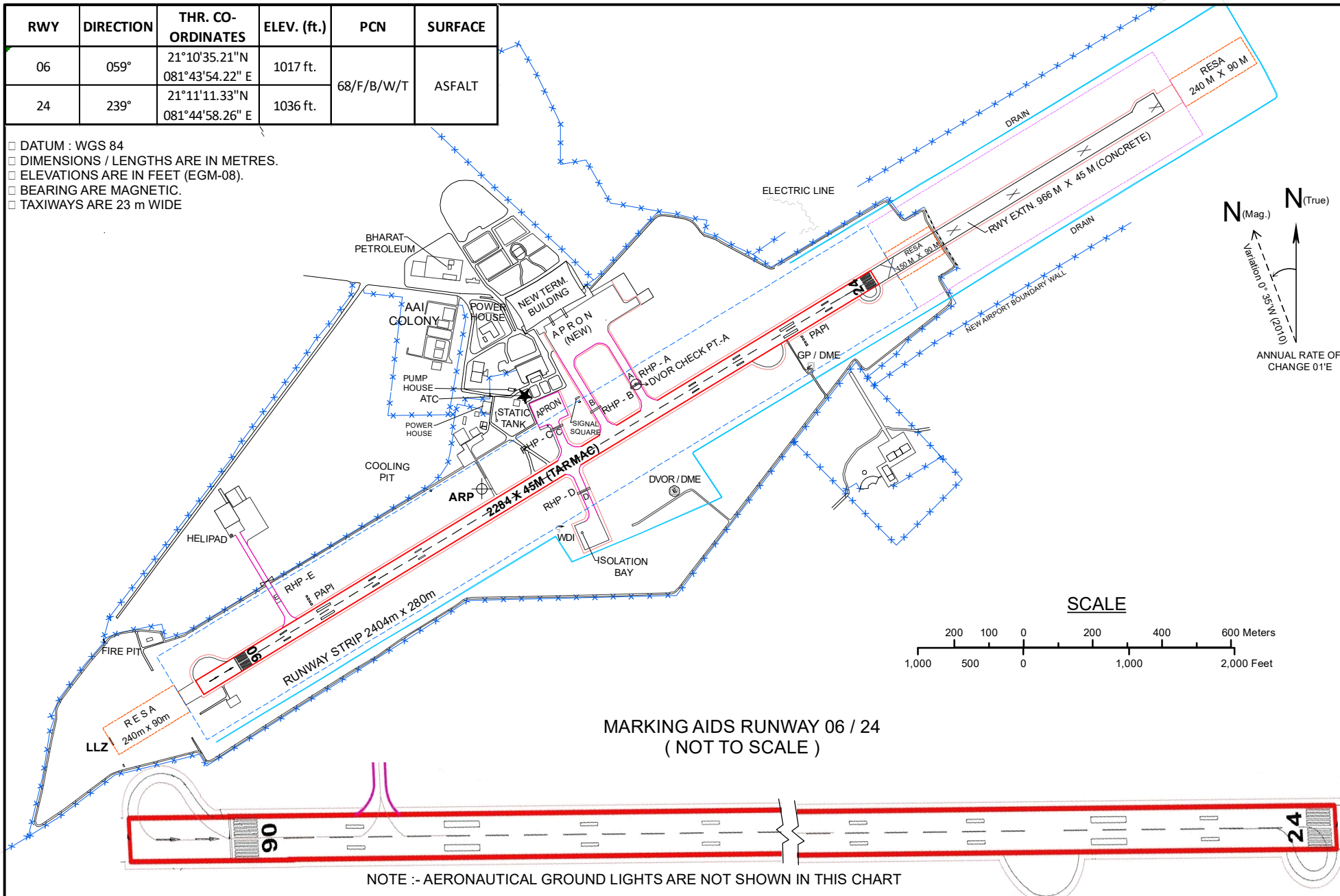

MARKING AIDS RUNWAY 06 / 24
(NOT TO SCALE)

NOTE :- AERONAUTICAL GROUND LIGHTS ARE NOT SHOWN IN THIS CHART