

AIRCRAFT PARKING/
DOCKING CHART

SMC NORTH 121.750 / SMC MIDDLE 121.900

CLD 121.950
DCL DELCFYA

INDIA/DELHI
IGI AIRPORT

STAND 801

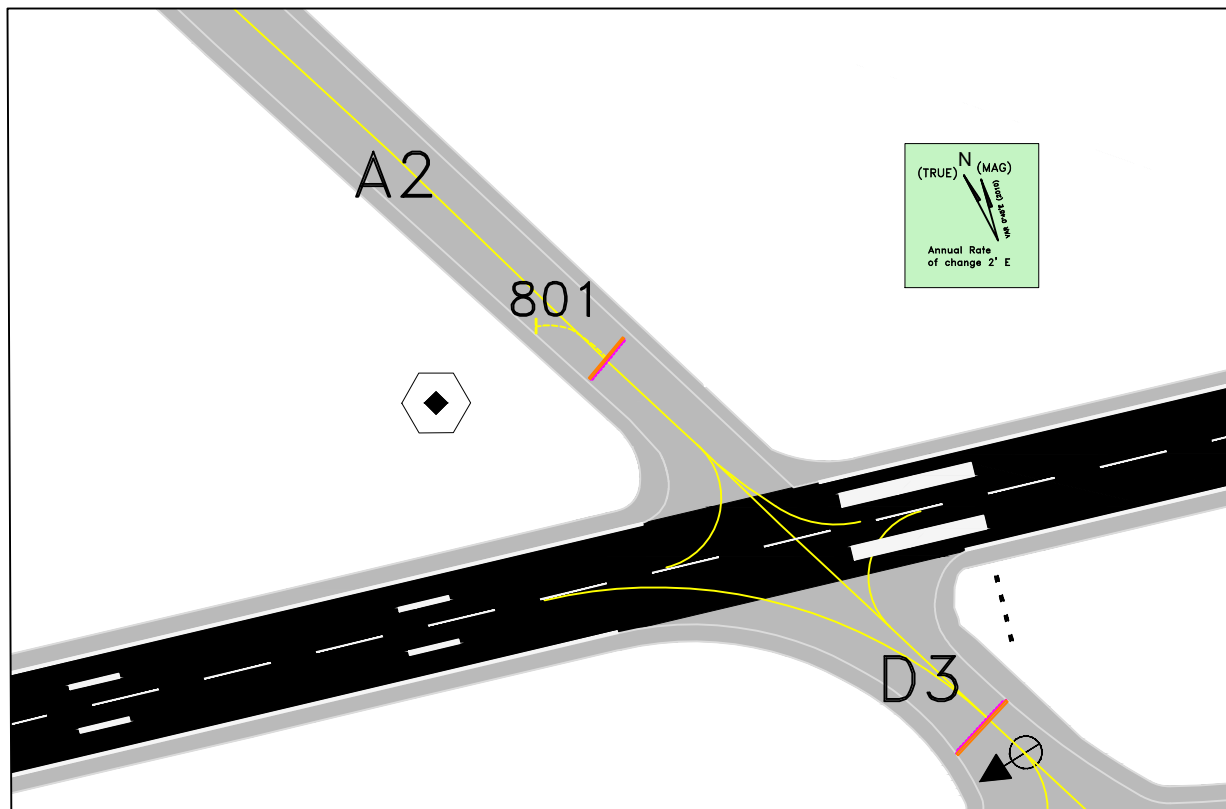

PRE -FLIGHT ALTIMETER CHECK LOCATION:

APRON ELEVATION : 740 FEET

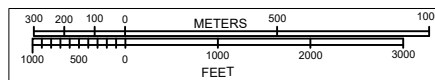

NOTE :

1. AERONAUTICAL GROUND LIGHTS ARE NOT AVAILABLE.
2. RHP- RUNWAY HOLDING POSITION.

LEGEND	
RHP	
STOPBAR	

DATUM - WGS 84
ELEVATIONS IN FEET
DIMENSIONS IN METRES
BEARINGS ARE MAGNETIC

PARKING STAND DETAILS						
STAND NO.	PCR	WGS 84 CO-ORDINATES		TYPE OF AIRCRAFT	REMARKS	CONTACT/ REMOTE
801	862/F/A/W/T	28°34'17.550"N	077°06'29.590"E	UPTO CODE LETTER E	POWER IN-PUSH BACK	REMOTE

CHART UPDATED ON 13FEB2025

PRODUCING ORGANIZATION: DELHI INTERNATIONAL AIRPORT LIMITED
DIAL-AIRSIDE-PLANNING@GMRGROUP.IN