

TEL: +91-11-24632950 Extn: 2219/2233 AFS: VIDDYXAX FAX: 91-11-24615508 Email: gmais@aai.aero	INDIA AERONAUTICAL INFORMATION SERVICE AIRPORTS AUTHORITY OF INDIA RAJIV GANDHI BHAVAN SAFDARJUNG AIRPORT NEW DELHI – 110003	13/2021
		14 JAN 2021

File No. AAI/ATM/AIS/09-09/2021

Following supplement is issued for information, guidance and necessary action.

sd/-
अरविंद सिंह
ARVIND SINGH
अध्यक्ष/CHAIRMAN
भारतीय विमानपत्तन प्राधिकरण
AIRPORTS AUTHORITY OF INDIA

[EFFECTIVE DATE: 25 FEB 2021]

AERODROME DATA
JUHU AIRPORT, JUHU (VAJJ)

VAJJ AD 2.2 AERODROME GEOGRAPHICAL AND ADMINISTRATIVE DATA

1	Aerodrome reference point coordinates and its site	190551.17 N 0725002.19 E MAG. BRG. 185.18DEG /88 M from intersection of RWY 08/26 and 16/34.
3	Aerodrome elevation and reference temperature	17 FT / 33.0 DEG C
4	Magnetic Variation, date of information and annual change	0.75 DEG W (2010) /0.0333 DEG E
7	Remarks	Elevation in EGM08

Amend VAJJ AD 2.2 e-AIP India accordingly.

VAJJ AD 2.8 APRONS, TAXIWAYS AND CHECK LOCATIONS/POSITIONS DATA

1	Designation, surface and strength of aprons	Refer Aircraft Parking/Docking Chart		
2	Designation, width, surface and strength of taxiways	Refer Aircraft Parking/Docking Chart		
	Remarks	1. Coordinates of RWY Holding Position		
		TWY	Coordinates	Elevation (FT)
		TWY B	190550.40N 0724953.90E	10

6	TWY D	190545.52N 0725007.90E	10
	TWY P	190556.85N 0725008.03E	10
	2. Coordinates of RWY and Taxi Intersection		
	TWY	Coordinates	Elevation (FT)
	TWY B	190552.82N 0724955.44E	11
	TWY D	190545.89N 0725006.01E	10
	TWY P	190554.67N 0725006.35E	11
3. Apron Size			
i. 240 M x 81.5 M,			
ii. 115 M x 25 M,			
iii. 30 M x 22.8 M,			
iv. 40 M x 30 M,			
v. 50 M x 27 M			
4. Elevations in EGM08			

Amend VAJJ AD 2.8 eAIP India accordingly.

VAJJ AD 2.10 AERODORME OBSTACLES

RWY/Area affected	Obstacle type	Coordinates	Elevation (FT) (EGM08)	Marking/ LGT	Remarks
1	2	3	4	5	6
APCH 08 TKOF 26	Other	190549.36N 0724936.75E	29	-	Hoarding
APCH 08 TKOF 26	Fencing	190549.75N 0724937.48E	27	-	Airport Boundary Wall With Fencing On Top
APCH 08 TKOF 26	Fencing	190551.14N 0724937.19E	28	-	Airport Boundary Wall With Fencing On Top
APCH 08 TKOF 26	Pole	190548.38N 0724936.81E	31	-	Light Pole
APCH 08 TKOF 26	Pole	190549.93N 0724935.48E	35	-	Light Pole
APCH 08 TKOF 26	Pole	190550.29N 0724936.53E	33	-	Light Pole
APCH 08 TKOF 26	Pole	190550.90N 0724935.28E	37	-	Light Pole
APCH 08 TKOF 26	Pole	190549.08N 0724936.67E	34	-	Pole
APCH 08 TKOF 26	Pole	190548.69N 0724936.87E	33	-	Light Pole
APCH 08 TKOF 26	Pole	190549.58N 0724936.67E	34	-	Light Pole
APCH 08 TKOF 26	Fencing	190547.38N 0724938.82E	31	-	Airport Boundary Wall With Fencing On Top

APCH 08 TKOF 26	Pole	190550.98N 0724936.37E	35	-	Light Pole
APCH 08 TKOF 26	Other	190549.70N 0724937.16E	35	-	Mobile Road Traffic (Road Elev 5.7 M + Mobile Traffic 5.0 M)
APCH 08 TKOF 26	Pole	190547.91N 0724936.03E	41	-	Light Pole
APCH 08 TKOF 26	Pole	190550.86N 0724936.03E	39	-	Pole
APCH 08 TKOF 26	Other	190552.15N 0724940.37E	34	-	Mobile Road Traffic (Road Elev 5.5 M + Mobile Traffic 5.0 M)
APCH 08 TKOF 26	Other	190549.78N 0724937.67E	34	-	Mobile Road Traffic (Road Elev 5.5 M + Mobile Traffic 5.0 M)
APCH 08 TKOF 26	Other	190547.42N 0724939.97E	34	-	Mobile Road Traffic (Road Elev 5.5 M + Mobile Traffic 5.0 M)
APCH 08 TKOF 26	Pole	190548.26N 0724936.85E	40	-	Pole
APCH 08 TKOF 26	Pole	190548.17N 0724937.03E	41	-	CCTV Pole
APCH 08 TKOF 26	Tree	190550.71N 0724936.35E	44	-	Tree
APCH 08 TKOF 26	Tree	190549.62N 0724936.56E	49	-	Tree
APCH 08 TKOF 26	Tree	190548.98N 0724936.66E	50	-	Tree
APCH 26 TKOF 08	Building	190600.57N 0725052.44E	133	-	Railing On Building (Building Top 39.6m)
APCH 26 TKOF 08	Building	190606.20N 0725049.97E	128	-	Railing On Building (Building Top 38.1m)
APCH 26 TKOF 08	Building	190600.90N 0725045.02E	105	-	Antenna On Building (Building Top 31.0m)
APCH 26 TKOF 08	Building	190602.49N 0725045.93E	110	-	Building U/C
APCH 26 TKOF 08	Building	190602.91N 0725053.71E	140	-	Dish On Building (Building Top 41.9m)
APCH 26 TKOF 08	Building	190559.39N 0725053.78E	138	-	Building
APCH 26 TKOF 08	Building	190604.32N 0725051.97E	135	-	Railing On Building (Building Top 39.9m)
APCH 26 TKOF 08	Building	190559.00N 0725049.32E	121	-	Building
APCH 26 TKOF 08	Building	190603.81N 0725046.18E	114	-	Building
APCH 26 TKOF 08	Building	190601.89N 0725047.76E	118	-	Building
APCH 26 TKOF 08	Building	190603.20N 0725055.57E	149	-	Building
APCH 26 TKOF 08	Building	190604.07N 0725041.77E	97	-	Railing On Building (Building Top 28.6m)
APCH 26 TKOF 08	Building	190558.49N 0725051.09E	129	-	Railing On Building (Building Top 38.3m)

APCH 26 TKOF 08	Building	190600.21N 0725050.58E	129	-	Building
APCH 26 TKOF 08	Building	190601.72N 0725048.91E	126	-	Railing On Building (Building Top 37.4m)
APCH 26 TKOF 08	Building	190601.61N 0725045.78E	116	-	Mast On Building (Building Top 24.6m)
APCH 26 TKOF 08	Building	190602.57N 0725043.63E	109	-	Mast On Building (Building Top 25.8m)
APCH 26 TKOF 08	Fencing	190557.14N 0725020.87E	20	-	Fencing
APCH 26 TKOF 08	Building	190559.74N 0725043.84E	109	-	Building
APCH 26 TKOF 08	Building	190559.78N 0725052.99E	144	-	Mast On Building (Building Top 37.4m)
APCH 26 TKOF 08	Building	190604.87N 0725046.03E	122	-	Building
APCH 26 TKOF 08	Pole	190556.94N 0725020.87E	21	-	Light Pole
APCH 26 TKOF 08	Fencing	190556.68N 0725021.54E	26	-	Airport Boundary Wall With Fencing On Top
APCH 26 TKOF 08	Fencing	190556.30N 0725021.77E	26	-	Airport Boundary Wall With Fencing On Top
APCH 26 TKOF 08	Chimney	190601.49N 0725044.18E	114	-	Chimney On Building (Building Top 30.7m)
APCH 26 TKOF 08	Fencing	190556.09N 0725021.80E	26	-	Airport Boundary Wall With Fencing On Top
APCH 26 TKOF 08	Building	190604.48N 0725046.52E	126	-	Building
APCH 26 TKOF 08	Other	190556.01N 0725022.15E	32	-	Mobile Road Traffic (Road Elev 4.8 M + Mobile Traffic 5.0 M)
APCH 26 TKOF 08	Building	190557.98N 0725031.93E	74	-	Sintex Tank On Building. (Building Top 21.9)
APCH 26 TKOF 08	Other	190557.19N 0725021.13E	33	-	Mobile Road Traffic (Road Elev 5.0 M + Mobile Traffic 5.0 M)
APCH 26 TKOF 08	Other	190556.06N 0725021.10E	32	-	Mobile Road Traffic (Road Elev 4.9 M + Mobile Traffic 5.0 M)
APCH 26 TKOF 08	Building	190600.53N 0725040.70E	114	-	Mast On Building (Building Top 24.8m)
APCH 26 TKOF 08	Building	190558.28N 0725028.66E	68	-	Building
APCH 26 TKOF 08	Building	190557.76N 0725030.30E	74	-	St. Xavier School Bldg. Vent Pipe (Bldg. Top- 20.8 M)
APCH 26 TKOF 08	Pole	190556.52N 0725021.85E	41	-	Light Pole
APCH 26 TKOF 08	Pole	190558.13N 0725021.79E	43	-	Light Pole
APCH 26 TKOF 08	Building	190556.33N 0725026.78E	61	-	Building
APCH 26 TKOF 08	Building	190557.76N 0725027.11E	63	-	Railing On Building (Building Top 18.1m)

APCH 26 TKOF 08	Building	190558.86N 0725022.97E	49	-	Building (Building Ellora Tourist)
APCH 26 TKOF 08	Building	190557.28N 0725022.77E	50	-	Building
APCH 26 TKOF 08	Building	190559.61N 0725029.09E	76	-	Sintex Tank On Building (Building Top 21.1m)
APCH 26 TKOF 08	Tree	190558.32N 0725021.72E	47	-	Group Of Tree
APCH 26 TKOF 08	Building	190558.44N 0725026.67E	66	-	Building
APCH 26 TKOF 08	Building	190557.04N 0725025.11E	60	-	Railing On Building (Building Top 17.8m)
APCH 26 TKOF 08	Building	190558.37N 0725023.03E	53	-	Building
APCH 26 TKOF 08	Building	190556.52N 0725022.74E	52	-	Building
APCH 26 TKOF 08	Building	190558.82N 0725023.53E	59	-	Railing On Building (Building Top 17.2m)
APCH 26 TKOF 08	Building	190558.53N 0725023.93E	62	-	Railing On Building (Building Top 17.6m)
APCH 26 TKOF 08	Building	190559.03N 0725023.79E	64	-	Sintex Tank On Building (Building Top 18.3m)
APCH 26 TKOF 08	Tree	190556.61N 0725027.46E	77	-	Group Of Tree
APCH 26 TKOF 08	Building	190557.86N 0725024.12E	65	-	Building
APCH 26 TKOF 08	Tree	190559.82N 0725027.38E	81	-	Group Of Tree
APCH 26 TKOF 08	Tree	190559.50N 0725034.71E	110	-	Group Of Tree
APCH 26 TKOF 08	Building	190559.01N 0725024.33E	71	-	Rod On Building (Building Top 17.8m)
APCH 26 TKOF 08	Tree	190557.93N 0725027.26E	81	-	Group Of Tree
APCH 26 TKOF 08	Tree	190557.21N 0725021.82E	61	-	Group Of Tree
APCH 26 TKOF 08	Building	190556.63N 0725023.21E	69	-	Antenna On Building (Building Top 20.3m)
APCH 26 TKOF 08	Building	190556.14N 0725022.78E	69	-	Antenna On Building (Building Top 18.7m)
APCH 26 TKOF 08	Tree	190557.38N 0725022.83E	75	-	Group Of Tree
APCH 26 TKOF 08	Tree	190558.84N 0725028.91E	109	-	Group Of Tree
APCH 26 TKOF 08	Tree	190559.15N 0725023.33E	92	-	Group Of Tree
APCH 26 TKOF 08	Tree	190557.93N 0725023.29E	91	-	Group Of Tree
APCH 26 TKOF 08	Tree	190557.47N 0725023.56E	92	-	Group Of Tree
APCH 26 TKOF 08	Tree	190557.24N 0725025.04E	100	-	Group Of Tree
APCH 26 TKOF 08	Tree	190558.32N 0725023.38E	94	-	Group Of Tree

APCH 26 TKOF 08	Tree	190556.94N 0725022.57E	91	-	Palm Tree
APCH 16 TKOF 34	Other	190605.03N 0724956.12E	31	-	Mobile Road Traffic (Road Elev 4.4 M + Mobile Traffic 5.0 M)
APCH 16 TKOF 34	Building	190605.16N 0724959.06E	33	-	Huts In Nehru Nagar
APCH 16 TKOF 34	Building	190605.51N 0724957.97E	35	-	Huts In Nehru Nagar
APCH 16 TKOF 34	Building	190605.23N 0724958.49E	36	-	Huts In Nehru Nagar
APCH 16 TKOF 34	Building	190605.71N 0724957.59E	40	-	Huts In Nehru Nagar
APCH 16 TKOF 34	Building	190606.08N 0724956.42E	41	-	Huts In Nehru Nagar
APCH 16 TKOF 34	Building	190605.79N 0724955.93E	41	-	Huts In Nehru Nagar
APCH 16 TKOF 34	Building	190606.16N 0724957.32E	41	-	Huts In Nehru Nagar
APCH 16 TKOF 34	Building	190605.58N 0724958.56E	43	-	Huts In Nehru Nagar
APCH 16 TKOF 34	Building	190606.61N 0724955.72E	44	-	Huts In Nehru Nagar
APCH 16 TKOF 34	Building	190606.56N 0724956.85E	44	-	Huts In Nehru Nagar
APCH 16 TKOF 34	Building	190607.13N 0724955.87E	47	-	Huts In Nehru Nagar
APCH 16 TKOF 34	Building	190608.00N 0724957.94E	50	-	Huts In Nehru Nagar
APCH 16 TKOF 34	Building	190607.30N 0724957.38E	55	-	Huts In Nehru Nagar
APCH 16 TKOF 34	Building	190611.53N 0724956.98E	68	-	Building
APCH 16 TKOF 34	Building	190621.56N 0724952.51E	126	-	Railing On Building (Building Top-37.3)
APCH 16 TKOF 34	Building	190622.99N 0724950.49E	134	-	Building
APCH 16 TKOF 34	Building	190622.23N 0724952.33E	135	-	Building
APCH 16 TKOF 34	Building	190621.33N 0724949.72E	135	-	Rod On Building (Building Top 40.4m)
APCH 16 TKOF 34	Building	190623.40N 0724947.04E	153	-	Rod On Building (Building Top 44.1m)
APCH 16 TKOF 34	Building	190626.51N 0724946.89E	154	-	Dish Antenna On Building (Building Top 46.6m)
APCH 16 TKOF 34	Building	190640.46N 0724946.48E	165	-	Generator On Building (Building Top 48.0m)
APCH 16 TKOF 34	Building	190633.99N 0724944.05E	175	-	Building U/C
APCH 16 TKOF 34	Building	190624.48N 0724950.70E	177	-	Tree Plant On Building (Building Top 52.7m)
APCH 16 TKOF 34	Building	190641.93N 0724944.97E	185	-	Building

APCH 34 TKOF 16	Building	190502.55N 0725026.83E	167	-	Rod On Building (Building Top 50.1)
APCH 34 TKOF 16	Building	190519.38N 0725014.98E	107	-	Mast On Building (Building Top 23.5m)
APCH 34 TKOF 16	Fencing	190536.31N 0725011.53E	23	-	Wire Fencing
APCH 34 TKOF 16	Pole	190536.35N 0725011.29E	23	-	Light Pole
APCH 34 TKOF 16	Building	190459.70N 0725023.90E	170	LGT	Lighted Rod On Building (Building Top 49.4)
APCH 34 TKOF 16	Tree	190531.09N 0725014.27E	54	-	Group Of Tree
APCH 34 TKOF 16	Building	190519.95N 0725014.35E	106	-	Mast On Building (Building Top 23.5m)
APCH 34 TKOF 16	Pole	190536.32N 0725010.75E	23	-	Light Pole
APCH 34 TKOF 16	Building	190458.22N 0725023.08E	171	LGT	Lighted Rod On Building (Building Top 50.0)
APCH 34 TKOF 16	Pole	190536.25N 0725010.22E	23	-	Light Pole
APCH 34 TKOF 16	Building	190458.88N 0725023.15E	172	-	Building
APCH 34 TKOF 16	Pole	190536.23N 0725009.74E	23	-	Light Pole
APCH 34 TKOF 16	Tree	190529.31N 0725013.36E	62	-	Group Of Tree
APCH 34 TKOF 16	Pole	190536.17N 0725009.22E	23	-	Light Pole
APCH 34 TKOF 16	Building	190524.44N 0725013.97E	88	LGT	Lighted Rod On Building (Building Top 25.6)
APCH 34 TKOF 16	Other	190536.54N 0725009.41E	28	-	Mobile Road Traffic (Road Elev 3.4 M + Mobile Traffic 5.0 M)
APCH 34 TKOF 16	Building	190525.17N 0725013.91E	86	-	Masjid Dome
APCH 34 TKOF 16	Building	190524.11N 0725015.10E	94	-	Antenna On Building (Building Top 27.6)
APCH 34 TKOF 16	Other	190536.41N 0725009.19E	28	-	Mobile Road Traffic (Road Elev 3.4 M + Mobile Traffic 5.0 M)
APCH 34 TKOF 16	Building	190525.12N 0725014.49E	89	-	Rod On Masjid (Building Top 26.0)
APCH 34 TKOF 16	Other	190536.29N 0725009.03E	28	-	Mobile Road Traffic (Road Elev 3.4 M + Mobile Traffic 5.0 M)
APCH 34 TKOF 16	Tree	190535.82N 0725010.34E	48	-	Group Of Tree
In Circling Area And at AD	Fencing	190556.29N 0725020.89E	20	-	Fencing
In Circling Area And at AD	Pole	190556.45N 0725020.88E	21	-	Light Pole
In Circling Area And at AD	Pole	190555.97N 0725020.89E	21	-	Light Pole

In Circling Area And at AD	Tree	190554.25N 0724941.17E	69	-	Tree
In Circling Area And at AD	Pole	190547.82N 0724937.17E	35	-	Light Pole
In Circling Area And at AD	Tree	190544.72N 0724938.30E	101	-	Group Of Tree
In Circling Area And at AD	Tree	190546.54N 0724945.31E	83	-	Group Of Tree
In Circling Area And at AD	Tree	190546.52N 0724944.54E	85	-	Group Of Tree
In Circling Area And at AD	Building	190552.20N 0724937.55E	51	-	Tin Shed
In Circling Area And at AD	Tree	190547.67N 0724936.69E	45	-	Tree
In Circling Area And at AD	Tree	190546.25N 0724942.50E	93	-	Group Of Tree
In Circling Area And at AD	Other	190552.32N 0724937.78E	67	-	Hoarding
In Circling Area And at AD	Tree	190545.45N 0724937.49E	106	-	Group Of Tree
In Circling Area And at AD	Tree	190552.59N 0724939.78E	72	-	Group Of Tree
In Circling Area And at AD	Tree	190553.19N 0724939.63E	85	-	Group Of Tree
In Circling Area And at AD	Tree	190546.98N 0724936.90E	93	-	Group Of Tree
In Circling Area And at AD	Tree	190547.86N 0724942.17E	88	-	Group Of Tree
In Circling Area And at AD	Tree	190552.34N 0725022.75E	89	-	Group Of Tree
In Circling Area And at AD	Pole	190559.17N 0725016.24E	42	-	Light Pole
In Circling Area And at AD	Pole	190559.30N 0725018.20E	38	-	Light Pole
In Circling Area And at AD	Tree	190557.55N 0725044.64E	105	-	Group Of Tree
In Circling Area And at AD	Pole	190555.48N 0725020.89E	21	-	Light Pole
In Circling Area And at AD	Tree	190600.02N 0725017.96E	54	-	Group Of Tree
In Circling Area And at AD	Building	190606.60N 0725036.99E	156	-	Building
In Circling Area And at AD	Building	190606.10N 0725041.78E	139	-	Mast On Building (Building Top 35.6m)
In Circling Area And at AD	Building	190601.74N 0725030.18E	70	-	Building (Saumia Sadan)
In Circling Area And at AD	Building	190556.36N 0725036.40E	89	-	Missionaries Of Charities
In Circling Area And at AD	Tree	190558.69N 0725016.54E	39	-	Group Of Tree
In Circling Area And at AD	Tree	190602.06N 0725020.84E	94	-	Group Of Tree
In Circling Area And at AD	Pole	190559.46N 0725020.46E	43	-	Light Pole

In Circling Area And at AD	Gate	190558.86N 0725021.06E	30	-	Pawan Hans Security Gate
In Circling Area And at AD	Building	190555.11N 0725026.59E	66	-	Sintex Tank On Building (Building Top 18.7m)
In Circling Area And at AD	Building	190555.77N 0725026.94E	57	-	Building
In Circling Area And at AD	Pole	190555.15N 0725021.84E	42	-	Light Pole
In Circling Area And at AD	Building	190556.12N 0725029.75E	66	-	Building
In Circling Area And at AD	Pole	190559.89N 0725020.69E	55	-	Light Pole
In Circling Area And at AD	Building	190602.97N 0725025.39E	111	-	Building
In Circling Area And at AD	Tree	190601.63N 0725023.32E	88	-	Coconut Tree
In Circling Area And at AD	Building	190558.38N 0725019.55E	31	-	Security Hut
In Circling Area And at AD	Building	190602.17N 0725029.58E	92	-	Building
In Circling Area And at AD	Building	190556.31N 0725027.86E	57	-	Building
In Circling Area And at AD	Building	190604.79N 0725034.22E	138	-	Building
In Circling Area And at AD	Tree	190559.37N 0725019.54E	52	-	Group Of Tree
In Circling Area And at AD	Tree	190558.85N 0725018.87E	45	-	Group Of Tree
In Circling Area And at AD	Building	190607.17N 0725048.90E	166	-	Railing On Building (Building Top 49.8m)
In Circling Area And at AD	Tree	190558.89N 0725019.87E	44	-	Group Of Tree
In Circling Area And at AD	Tree	190600.95N 0725026.33E	77	-	Tree
In Circling Area And at AD	Pole	190555.81N 0725021.84E	41	-	Light Pole
In Circling Area And at AD	Building	190555.77N 0725024.17E	57	-	Railing On Building (Building Top 16.4m)
In Circling Area And at AD	Building	190600.68N 0725026.87E	77	-	Sintex Tank On Building (Building Top 22.5m)
In Circling Area And at AD	Tree	190600.71N 0725022.80E	86	-	Coconut Tree
In Circling Area And at AD	Tree	190600.16N 0725021.56E	77	-	Group Of Tree
In Circling Area And at AD	Building	190555.49N 0725022.83E	60	-	Building
In Circling Area And at AD	Tree	190555.14N 0725022.72E	68	-	Group Of Tree
In Circling Area And at AD	Building	190601.24N 0725025.68E	96	-	Gurudev Hotel
In Circling Area And at AD	Building	190556.65N 0725034.45E	103	-	Church
In Circling Area And at AD	Tree	190555.46N 0725027.72E	93	-	Group Of Tree

In Circling Area And at AD	Building	190555.87N 0725023.35E	66	-	Building
In Circling Area And at AD	Tree	190556.27N 0725030.09E	97	-	Group Of Tree
In Circling Area And at AD	Tree	190600.27N 0725022.53E	98	-	Coconut Tree
In Circling Area And at AD	Tree	190558.73N 0725021.12E	70	-	Group Of Tree
In Circling Area And at AD	Building	190605.13N 0724959.29E	34	-	Huts In Nehru Nagar
In Circling Area And at AD	Building	190605.97N 0724959.13E	47	-	Huts In Nehru Nagar
In Circling Area And at AD	Building	190605.51N 0724959.04E	50	-	Huts In Nehru Nagar
In Circling Area And at AD	Building	190614.09N 0724959.37E	154	-	Dish On Building (Building Top 46.4m)
In Circling Area And at AD	Building	190622.42N 0724955.17E	157	-	Building
In Circling Area And at AD	Building	190625.98N 0724953.36E	158	-	Rod On Building (Building Top 47.5m)
In Circling Area And at AD	Building	190612.66N 0725001.20E	177	LGT	Light On Building (Building Top 53.6m)
In Circling Area And at AD	Fencing	190536.04N 0725008.72E	23	-	Wire Fencing
In Circling Area And at AD	Pole	190536.10N 0725008.69E	23	-	Light Pole
In Circling Area And at AD	Building	190524.22N 0725018.78E	96	-	Mast On Building (Building Top 24.4)
In Circling Area And at AD	Tree	190530.73N 0725009.39E	69	-	Group Of Tree
In Circling Area And at AD	Tree	190537.58N 0725013.04E	60	-	Group Of Tree
In Circling Area And at AD	Building	190526.31N 0725011.04E	99	-	Antenna On Building (Building Top 27.4)
In Circling Area And at AD	Tree	190535.97N 0725008.71E	36	-	Group Of Tree
In Circling Area And at AD	Tree	190533.77N 0725009.05E	56	-	Group Of Tree
In Circling Area And at AD	Building	190538.51N 0725001.56E	206	-	Rod On ARSR Radar (Building Top 59.6)
In Circling Area And at AD	Mast	190547.30N 0725011.75E	127	-	VHF Mast
In Circling Area And at AD	Building	190602.69N 0724932.70E	168	-	Building U/C
In Circling Area And at AD	Building	190553.65N 0725052.34E	166	-	Railing On Building (Building Top 49.9m)
In Circling Area And at AD	Building	190555.15N 0725101.52E	166	-	Building
In Circling Area And at AD	Building	190545.87N 0725041.74E	167	-	Railing On Building (Building Top 50.1m)
In Circling Area And at AD	Building	190551.84N 0725041.84E	167	-	Building
In Circling Area And at AD	Building	190611.71N 0725013.71E	167	-	Antenna On Building (Building Top 50.0m)

In Circling Area And at AD	Building	190550.78N 0725045.57E	168	-	Building
In Circling Area And at AD	Building	190547.34N 0725056.56E	171	-	Railing On Building (Building Top 50.7m)
In Circling Area And at AD	Building	190610.74N 0725011.48E	177	-	Rod On Building (Building Top 50.6m)
In Circling Area And at AD	Building	190546.31N 0725051.26E	185	-	Antenna On Building (Vireshwar Height) (Bldg.Top-54.0m)
In Circling Area And at AD	Building	190611.41N 0725035.14E	186	-	Rod On Building (Building Top 52.2m)
In Circling Area And at AD	Building	190612.00N 0725019.82E	190	-	Rod On Building (Building Top 57.0m)
In Circling Area And at AD	Building	190611.17N 0725034.03E	190	-	Railing On Building (Building Top 57.0m)
In Circling Area And at AD	Building	190629.52N 0724956.71E	166	-	Sintex Tank On Building (Building Top 48.3m)
In Circling Area And at AD	Building	190626.44N 0724933.86E	170	-	Rod On Building (Building Top 48.0m)
In Circling Area And at AD	Building	190654.16N 0724928.39E	171	-	Dish On Building (Building Top 51.4m)
In Circling Area And at AD	Building	190611.98N 0725007.91E	176	-	Railing On Building (Building Top 52.7m)
In Circling Area And at AD	Building	190611.45N 0725006.44E	177	-	Building
In Circling Area And at AD	Building	190616.63N 0725000.80E	178	-	Building U/C
In Circling Area And at AD	Building	190646.23N 0724950.11E	178	-	Building (Om Niwas)
In Circling Area And at AD	Building	190611.10N 0725008.57E	181	-	Building U/C
In Circling Area And at AD	Building	190609.06N 0725006.79E	181	-	Railing On Building (Building Top 54.0m)
In Circling Area And at AD	Building	190634.96N 0724951.53E	184	-	Building
In Circling Area And at AD	Building	190644.26N 0724953.02E	184	-	Railing On Building (Building Top 55.1m)
In Circling Area And at AD	Building	190617.48N 0725000.71E	185	-	Building
In Circling Area And at AD	Building	190622.79N 0725011.45E	185	-	Building
In Circling Area And at AD	Building	190646.31N 0724951.48E	186	-	Dish On Building (Building Top 56.1m)
In Circling Area And at AD	Building	190649.15N 0724952.89E	187	-	Building U/C
In Circling Area And at AD	Building	190648.04N 0724951.80E	187	-	Rod On Building (Building Top 56.1m)
In Circling Area And at AD	Building	190635.71N 0724951.75E	188	-	Railing On Building (Building Top 56.7m)
In Circling Area And at AD	Building	190633.40N 0724954.32E	188	-	Building U/C
In Circling Area And at AD	Building	190633.31N 0724959.54E	189	-	Railing On Building (Building Top 56.3m)

In Circling Area And at AD	Building	190624.87N 0724957.03E	189	-	Railing On Building (Building Top 56.7m)
In Circling Area And at AD	Building	190649.55N 0724950.12E	190	-	Dish On Building (Building Top 56.1m)
In Circling Area And at AD	Building	190654.64N 0724950.11E	190	-	Antenna On Building (Building Top 56.6m)
In Circling Area And at AD	Building	190640.12N 0725000.44E	190	-	Railing On Building (Building Top 57.1m)
In Circling Area And at AD	Building	190645.31N 0724954.64E	190	-	Railing On Building (Building Top 56.9m)
In Circling Area And at AD	Building	190656.01N 0724950.11E	190	LGT	Lighted Rod On Building (Building Top 56.5m)
In Circling Area And at AD	Building	190652.02N 0725017.91E	197	LGT	Lighted Rod On Building (Building Top 59.3m)
In Circling Area And at AD	Building	190635.41N 0724954.60E	202	-	Rod On Building (Building Top 56.4m)
In Circling Area And at AD	Building	190441.48N 0725037.31E	166	-	Building
In Circling Area And at AD	Building	190445.95N 0725032.66E	169	LGT	Lighted Rod On Building (Building Top 49.6)
In Circling Area And at AD	Building	190446.72N 0725038.63E	169	-	Tank On Building (Building Top 50.2)
In Circling Area And at AD	Building	190443.11N 0725023.30E	171	-	Building U/C
In Circling Area And at AD	Building	190441.43N 0725025.06E	171	-	Building
In Circling Area And at AD	Building	190454.33N 0725038.53E	171	-	Railing On Building (Building Top 51.2)
In Circling Area And at AD	Building	190445.70N 0725019.56E	180	-	Railing On Building (Building Top 53.7)
In Circling Area And at AD	Building	190441.71N 0725014.97E	181	-	Railing On Building (Building Top 54.5)
In Circling Area And at AD	Building	190445.85N 0725012.57E	183	-	Building
In Circling Area And at AD	Building	190448.25N 0725009.98E	186	-	Rod On Building (Building Top 54.8)
In Circling Area And at AD	Building	190445.13N 0725013.49E	187	-	Building
In Circling Area And at AD	Building	190454.52N 0725013.22E	197	-	Building U/C
In Circling Area And at AD	Building	190436.15N 0725024.19E	198	-	Rod On Building (Building Top 55.2)
In Circling Area And at AD	Building	190438.35N 0725014.37E	207	-	Building U/C
In Circling Area And at AD	Building	190433.56N 0725020.94E	187	-	Building

Replace VAJJ AD 2.10 of eAIP India with the above table.

VAJJ AD 2.12 RUNWAY PHYSICAL CHARACTERISTICS

Designations	True BRG	Dimensions of RWY (M)	Strength of pavement (PCN) and associated data) and surface of runway and associated stop ways	Geographical coordinates for threshold and runway end
1	2	3	4	5
08	79.83 DEG	1132 x 30 M	17/F/D/Y/T Asphalt	THR: 190550.87N 0724944.02E RWY END: 190556.79N 0725018.77E
26	259.83 DEG	1132 x 30 M	17/F/D/Y/T Asphalt	THR: 190553.99N 0725002.38E RWY END: 190550.29N 0724940.65E
16	157.29 DEG	725 X 20	8/F/D/Y/T Asphalt	THR: 190600.11N 0724959.75E RWY END: 190538.36N 0725009.33E
34	337.29 DEG	725 X 20	8/F/D/Y/T Asphalt	THR: 190538.36N 0725009.33E RWY END: 190600.11N 0724959.75E
THR elevation and highest elevation of TDZ of precision APP RWY	Slope of runway and associated stop way	Dimensions of stop way (M)	Dimensions of clearway (M)	Dimensions of strips (M)
6	7	8	9	10
THR: 15FT TDZ: 15FT		NIL	NIL	1252 X 80
THR: 11FT TDZ: 12FT		NIL	NIL	1252 X 80
THR: 10FT TDZ: 10FT		NIL	NIL	785 X 60
THR: 10FT TDZ: 11FT		NIL	NIL	785 X 60

Dimensions of runway end safety areas	Location and description of arresting system (if any)	Existence of an obstacle-free zone	Remarks.
11	12	13	14
Not Available	NIL	NIL	i. Turn Pad and Blast Pad Beginning of RWY not AVBL ii. Elevations in EGM08
Not Available	NIL	NIL	i. Turn Pad and Blast Pad Beginning of RWY not AVBL ii. Elevations in EGM08
Not Available	NIL	NIL	i. Turn Pad and Blast Pad Beginning of RWY not AVBL ii. Elevations in EGM08
Not Available	NIL	NIL	i. Turn Pad and Blast Pad Beginning of RWY not AVBL ii. Elevations in EGM08

Amend VAJJ AD 2.12 e-AIP India accordingly.

VAJJ AD 2.13 DECLARED DISTANCES

RWY Designator	TORA (M)	TODA (M)	ASDA (M)	LDA (M)	Remarks (including runway entry or start point where alternative reduced declared distances have been declared)
1	2	3	4	5	6
08	1132	1132	1132	1032	THR Displaced by 100M
26	1132	1132	1132	645	THR Displaced by 487M
16	725	725	725	725	
34	725	725	725	725	

Amend VAJJ AD 2.13 of e-AIP India accordingly

AMENDMENTS/CANCELLATION:

1. Replace Aerodrome Chart in VAJJ AD 2.24 of eAIP India with the Aerodrome Chart of this AIP supplement.
2. Replace Aircraft Parking/Docking Chart in VAJJ AD 2.24 of eAIP India with the Aircraft Parking/Docking Chart of this AIP supplement.
3. Replace Aerodrome Obstacle Chart Type - A (Operating Limitations) RWY 08 in VAJJ AD 2.24 of eAIP India with the Aerodrome Obstacle Chart Type - A (Operating Limitations) RWY 07 of this AIP supplement.
4. Replace Aerodrome Obstacle Chart Type - A (Operating Limitations) RWY 26 in VAJJ AD 2.24 of eAIP India with the Aerodrome Obstacle Chart Type - A (Operating Limitations) RWY 07 of this AIP supplement.
5. Replace Aerodrome Obstacle Chart Type - A (Operating Limitations) RWY 16 in VAJJ AD 2.24 of eAIP India with the Aerodrome Obstacle Chart Type - A (Operating Limitations) RWY 07 of this AIP supplement.
6. Replace Aerodrome Obstacle Chart Type - A (Operating Limitations) RWY 34 in VAJJ AD 2.24 of eAIP India with the Aerodrome Obstacle Chart Type - A (Operating Limitations) RWY 07 of this AIP supplement.

AIRCRAFT PARKING/
DOCKING CHART

APRON ELEV 14

TWR
MAIN 124.35
STN BY 118.75

JUHU, INDIA

JUHU AIRPORT

- * DATUM : WGS-84
- * DIMENSIONS IN METRES
- * ELEVATIONS IN FEET & EGM-08.

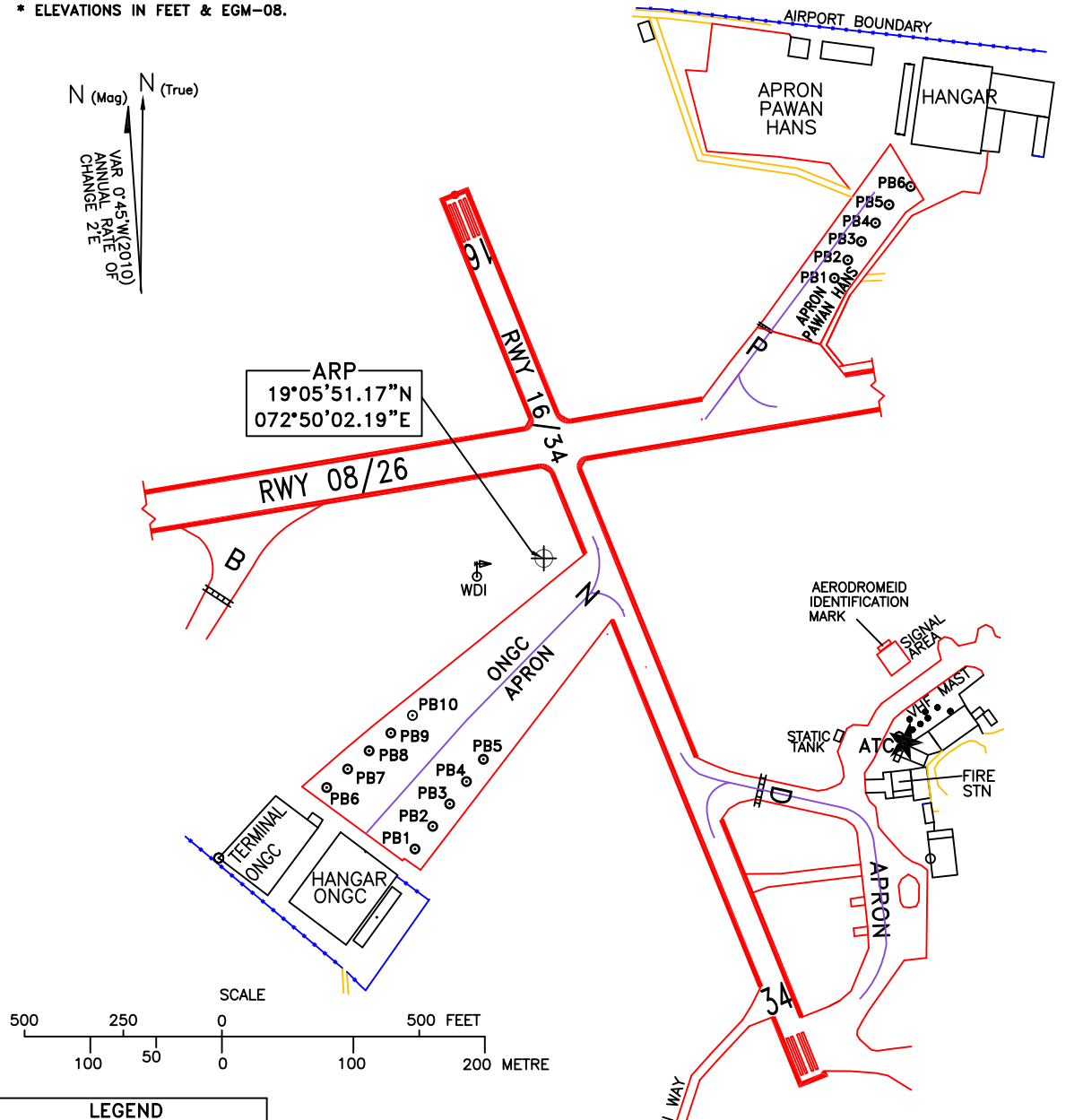
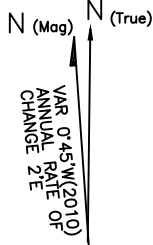

LEGEND	
AIRCRAFT STAND	10
RWY HOLDING POSITION	=====

STAND NO.	WGS CO-ORDINATES FOR AIRCRAFT STANDS ONGC APRON	SUITABILITY	PCN	ELEV.
1	19°05'43.94978" N 072°49'58.92696" E	MIXED PARKING FOR S-365 B-412 AW-139	43/R/B/W/T	14
2	19°05'44.51295" N 072°49'59.37685" E		43/R/B/W/T	14
3	19°05'45.07007" N 072°49'59.81256" E		43/R/B/W/T	14
4	19°05'45.62711" N 072°50'00.24494" E		43/R/B/W/T	14
5	19°05'46.18384" N 072°50'00.68304" E		43/R/B/W/T	14
6	19°05'46.80368" N 072°49'58.25805" E		43/R/B/W/T	14
7	19°05'45.90024" N 072°49'57.14993" E		43/R/B/W/T	14
8	19°05'46.35673" N 072°49'57.70103" E		43/R/B/W/T	14
9	19°05'45.43767" N 072°49'56.60802" E		43/R/B/W/T	14
10	19°05'47.24611" N 072°49'58.81822" E		43/R/B/W/T	14
STAND NO.	WGS CO-ORDINATES FOR AIRCRAFT STANDS PAWAN HANS	SUITABILITY	PCN	ELEV.
1	19°05'58.19109" N 072°50'09.66059" E	S-365	--	10
2	19°05'58.64131" N 072°50'10.00577" E	S-365	--	10
3	19°05'59.10021" N 072°50'10.35369" E	S-365	--	10
4	19°05'59.56653" N 072°50'10.71406" E	S-365	--	10
5	19°06'00.01975" N 072°50'11.05582" E	S-365	--	10
6	19°06'00.47840" N 072°50'11.61423" E	S-365	--	10

TAXIWAY	PCN	WIDTH
B	04/F/D/Y/T	10.5M
D	08/F/D/Y/T	20.0M
N	43/R/B/W/T	66.65M
P	03/F/D/Y/T	47.0M

STAND NO.	WGS CO-ORDINATES FOR AIRCRAFT STANDS GLOBLE APRON	SUITABILITY	PCN	ELEV.
1	19°05'34.96723" N 072°50'03.79145" E	--	--	13
2	19°05'35.11554" N 072°50'4.94768" E	--	--	13
3	19°05'34.09085" N 072°50'03.55970" E	--	--	13
4	19°05'34.17264" N 072°50'04.35538" E	--	--	13
5	19°05'34.25367" N 072°50'05.15291" E	--	--	13
6	19°05'33.41398" N 072°50'03.56604" E	--	--	13
7	19°05'33.49664" N 072°50'04.36347" E	--	--	13
8	19°05'32.74167" N 072°50'03.57285" E	--	--	13
9	19°05'32.82425" N 072°50'04.36930" E	--	--	13

DATE OF AERONAUTICAL INFORMATION
AUGUST 2020

DRG. NO.-AAI/41-PDC/2020

ELEVATIONS IN FEET
ALL OTHER DIMENSIONS IN METRES

AERODROME OBSTACLE CHART

TYPE -A (OPERATING LIMITATIONS)

INDIA / JUHU
JUHU AIRPORT/RWY 08

MAGNETIC VARIATION 1°W (2010)

RWY 08/26

DECLARED DISTANCES	
RWY 08	RWY 26
1132 TAKE-OFF RUN AVAILABLE	1132
1132 TAKE-OFF DISTANCE AVAILABLE	1132
1132 ACCELERATE STOP DISTANCE AVAILABLE	1132
1032 LANDING DISTANCE AVAILABLE	645

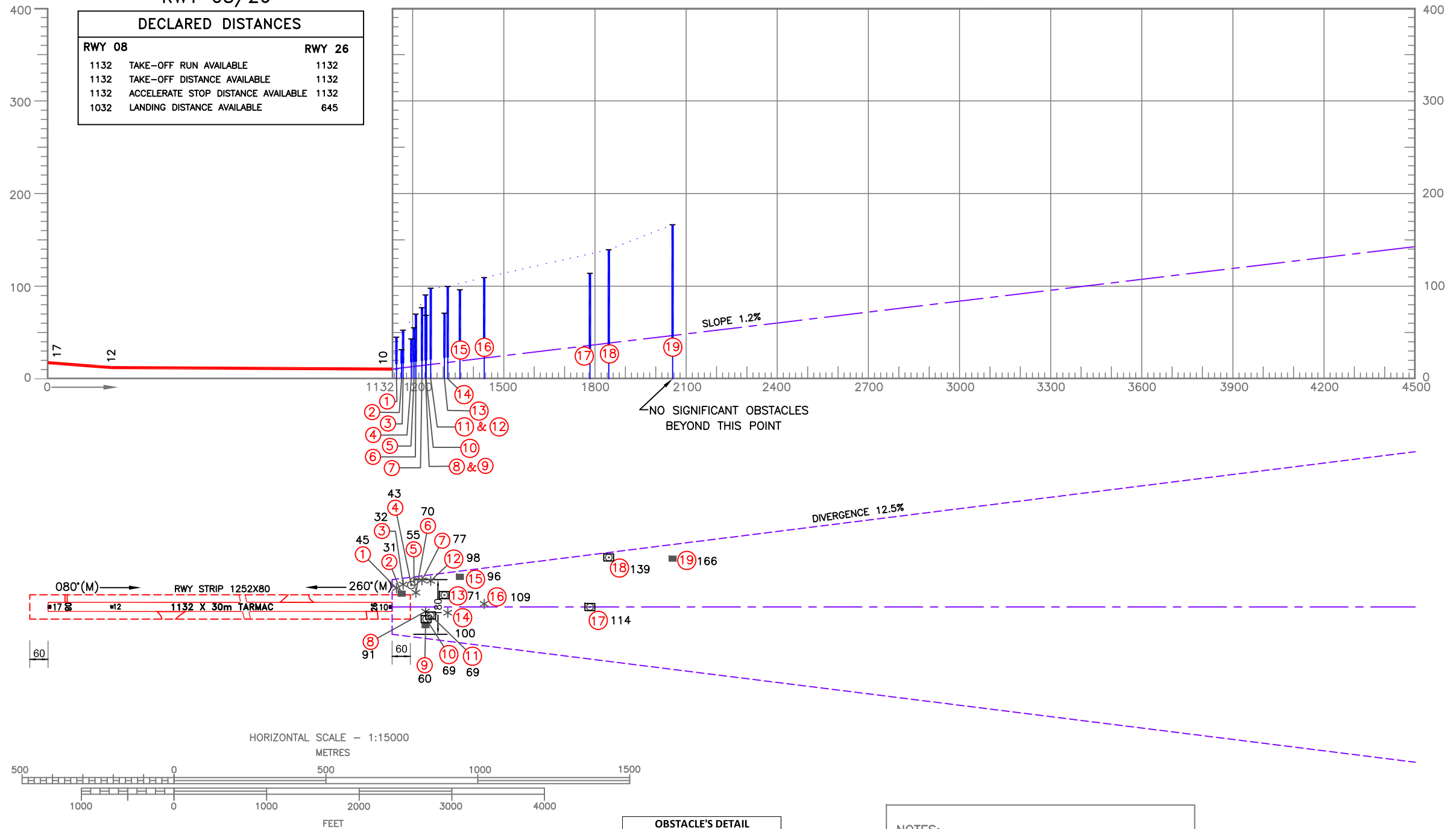
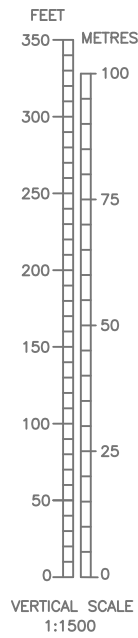

LEGEND		
	PLAN	PROFILE
IDENTIFICATION NUMBER	(19)	
TREE OR SHRUB	*	
BUILDING, STRUCTURE ETC.	■	
ROD/ANTENNA/MAST ON BUILDING	⊠	
POLE,TOWER,SPIRE,ANTENNA ETC...	⊙	

ORDER OF ACCURACY
HORIZONTAL - 3.0m
VERTICAL - 1ft.

OBSTACLE'S DETAIL		
SR.NO.	UID	NAME
1	3597	GROUP OF TREE
2	3246	SECURITY HUT
3	3598	GROUP OF TREE
4	3260	LIGHT POLE
5	3649	LIGHT POLE
6	3268	GROUP OF TREE
7	3165	GROUP OF TREE
8	3644	PALM TREE
9	3237	BUILDING
10	3157	ANTENNA ON BUILDING
11	3238	ANTENNA ON BUILDING
12	3648	COCONUT TREE
13	3186	ROD ON BUILDING
14	3203	GROUP OF TREE
15	3605	GURUDEV HOTEL
16	3204	GROUP OF TREE
17	3174	MAST ON BUILDING
18	3178	MAST ON BUILDING
19	3146	RAILING ON BUILDING

NOTES:-

- The objects that have been shielded due to presence of other higher objects have not been shown in this chart.
- Datum - All Elevations are in EGM-2008.
- Periphery road without traffic is no obstacle.
- Consult Notam for latest information.
- Rwy directions rounded to nearest degree.(Magnetic) (In degree minute: Rwy 08/26=080°35'/260°35')/2010. (In degree minute: Rwy 08/26=080°15'/260°15')/2020.
- Magnetic Variation rounded to nearest degree 0°45'W, Annual rate of change 02'E (2010).
- All obstacles shown in this chart are based on aeronautical obstacle Survey Feb.2020.
- Chart prepared based on DGCA CAR section 9 AS & ATM Series 'G', Part-1.

AMENDMENT RECORD		
NO.	DATE	ENTERED BY

AERONAUTICAL INFORMATION UPTO - SEPT. 2020
वैमानिक सूचना - सितंबर 2020 तक

COMPILED BY : CARTO, AIRPORTS AUTHORITY OF INDIA
संग्रहित किया : कार्टो, भारतीय विमानपत्तन प्राधिकरण

CHART No. AAI/50-OBS/CARTO/2020
चार्ट सं. भा.वि.प्रा./50-अव./कार्टो/2020

AERODROME OBSTACLE CHART

TYPE -A (OPERATING LIMITATIONS)

INDIA / JUHU
JUHU AIRPORT/RWY 26

ELEVATIONS IN FEET
ALL OTHER DIMENSIONS IN METRES

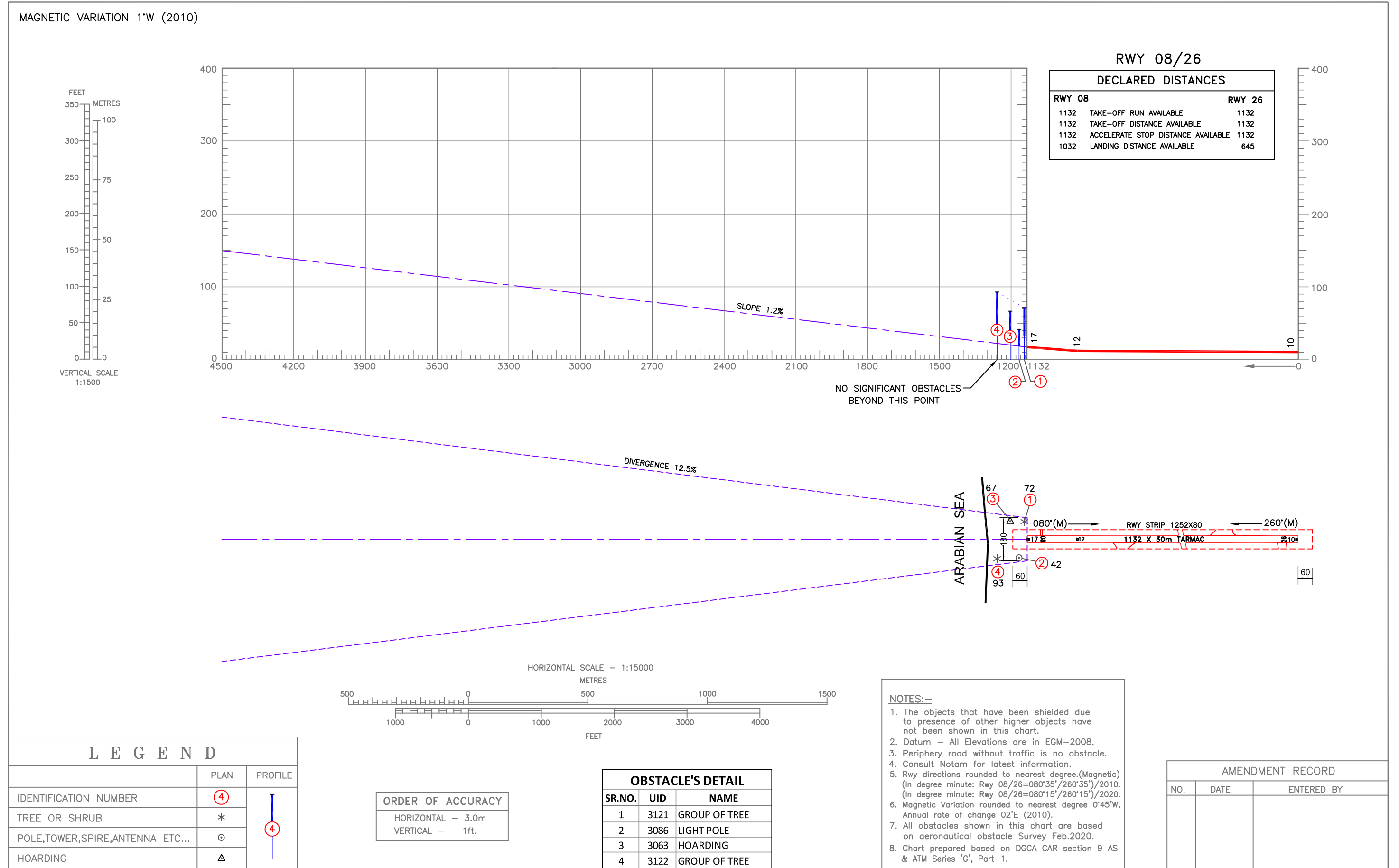

AERONAUTICAL INFORMATION UPTO - SEPT. 2020
वैमानिक सूचना - सितंबर 2020 तक

COMPILED BY- CARTO, AIRPORTS AUTHORITY OF INDIA
संग्रहित किया : कार्टो, भारतीय विमानपत्तन प्राधिकरण

CHART No. AAI/51-OBS/CARTO/2020
चार्ट सं. भा.वि.प्रा./51-अव./कार्टो/2020

ELEVATIONS IN FEET
ALL OTHER DIMENSIONS IN METRES

AERODROME OBSTACLE CHART

TYPE -A (OPERATING LIMITATIONS)

INDIA / JUHU
JUHU AIRPORT/RWY 16

MAGNETIC VARIATION 1°W (2010)

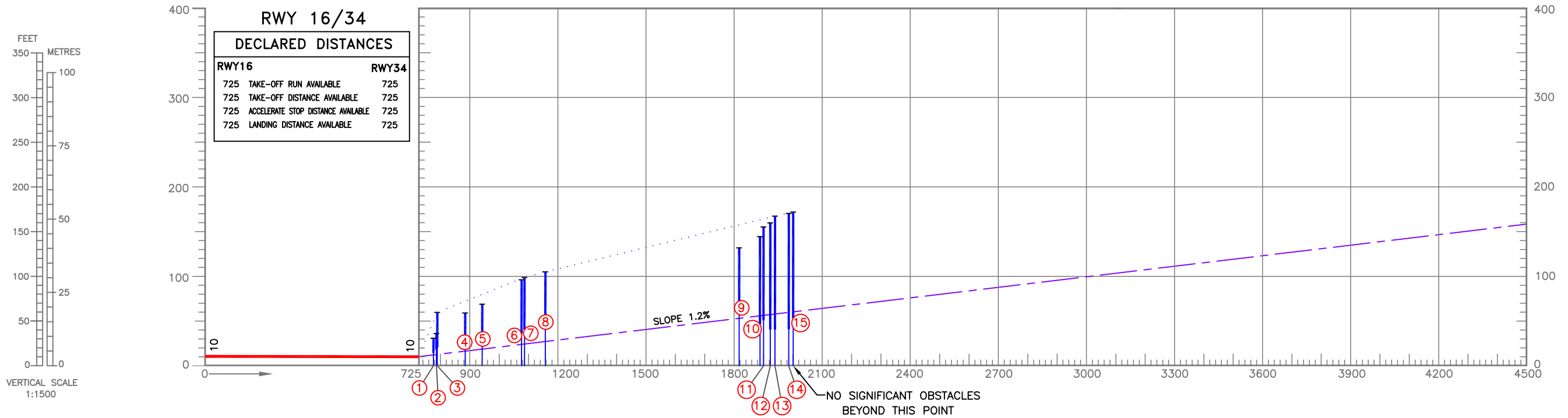

RWY 16/34	
RWY16	RWY34
725 TAKE-OFF RUN AVAILABLE	725
725 TAKE-OFF DISTANCE AVAILABLE	725
725 ACCELERATE STOP DISTANCE AVAILABLE	725
725 LANDING DISTANCE AVAILABLE	725

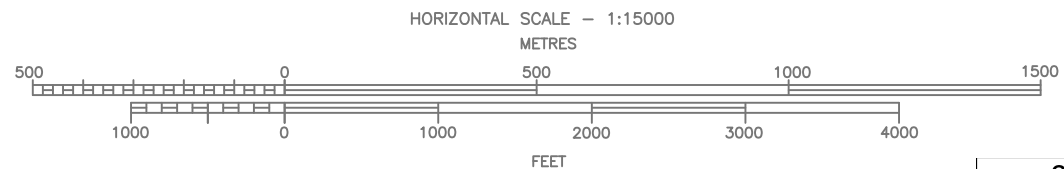
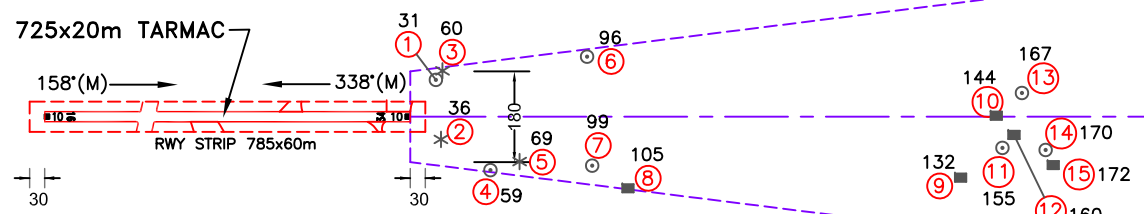
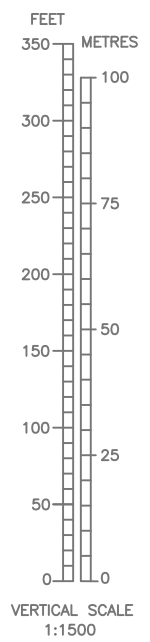

LEGEND		
	PLAN	PROFILE
IDENTIFICATION NUMBER	⑮	⋮
TREE OR SHRUB	*	⊙
BUILDING, STRUCTURE ETC.	■	■
POLE, TOWER, SPIRE, ANTENNA ETC...	⊙	⊙

ORDER OF ACCURACY	
HORIZONTAL	- 3.0m
VERTICAL	- 1ft.

OBSTACLE'S DETAIL		
SR.NO.	UID	NAME
1	3568	FLOOD LIGHT MAST
2	3585	GROUP OF TREE
3	3577	GROUP OF TREE
4	3534	ROD ON HANGAR
5	3517	GROUP OF TREE
6	3539	MAST
7	3514	ANTENNA ON BUILDING
8	3504	AC DUCT ON BUILDING
9	3450	BUILDING
10	3454	BUILDING
11	3452	DISH ON BUILDING
12	3453	RAILING ON BUILDING
13	3456	ROD ON BUILDING
14	3449	LIGHTED ROD ON BUILDING
15	3447	BUILDING
16	3273	ROD ON BUILDING

NOTES:-

- The objects that have been shielded due to presence of other higher objects have not been shown in this chart.
- Datum - All Elevations are in EGM-2008.
- Periphery road without traffic is no obstacle.
- Consult Notam for latest information.
- Rwy directions rounded to nearest degree.(Magnetic) (In degree minute: Rwy 16/34=158°02'/338°02')/2010. (In degree minute: Rwy 16/34=157°45'/337°45')/2020.
- Magnetic Variation rounded to nearest degree 0°45'W, Annual rate of change 02'E (2010).
- All obstacles shown in this chart are based on aeronautical obstacle Survey Feb.2020.
- Chart prepared based on DGCA CAR section 9 AS & ATM Series 'G', Part-1.

AMENDMENT RECORD		
NO.	DATE	ENTERED BY

AERONAUTICAL INFORMATION UPTO - SEPTEMBER 2020
वैमानिक सूचना - सितंबर 2020 तक

COMPILED BY : CARTO, AIRPORTS AUTHORITY OF INDIA
संग्रहित किया : कार्टो, भारतीय विमानपत्तन प्राधिकरण

CHART No. AAI/52-OBS/CARTO/2020
चार्ट सं. भा.वि.प्रा./52-अव./कार्टो/2020

AERODROME OBSTACLE CHART

TYPE -A (OPERATING LIMITATIONS)

INDIA / JUHU
JUHU AIRPORT/RWY 34

ELEVATIONS IN FEET
ALL OTHER DIMENSIONS IN METRES

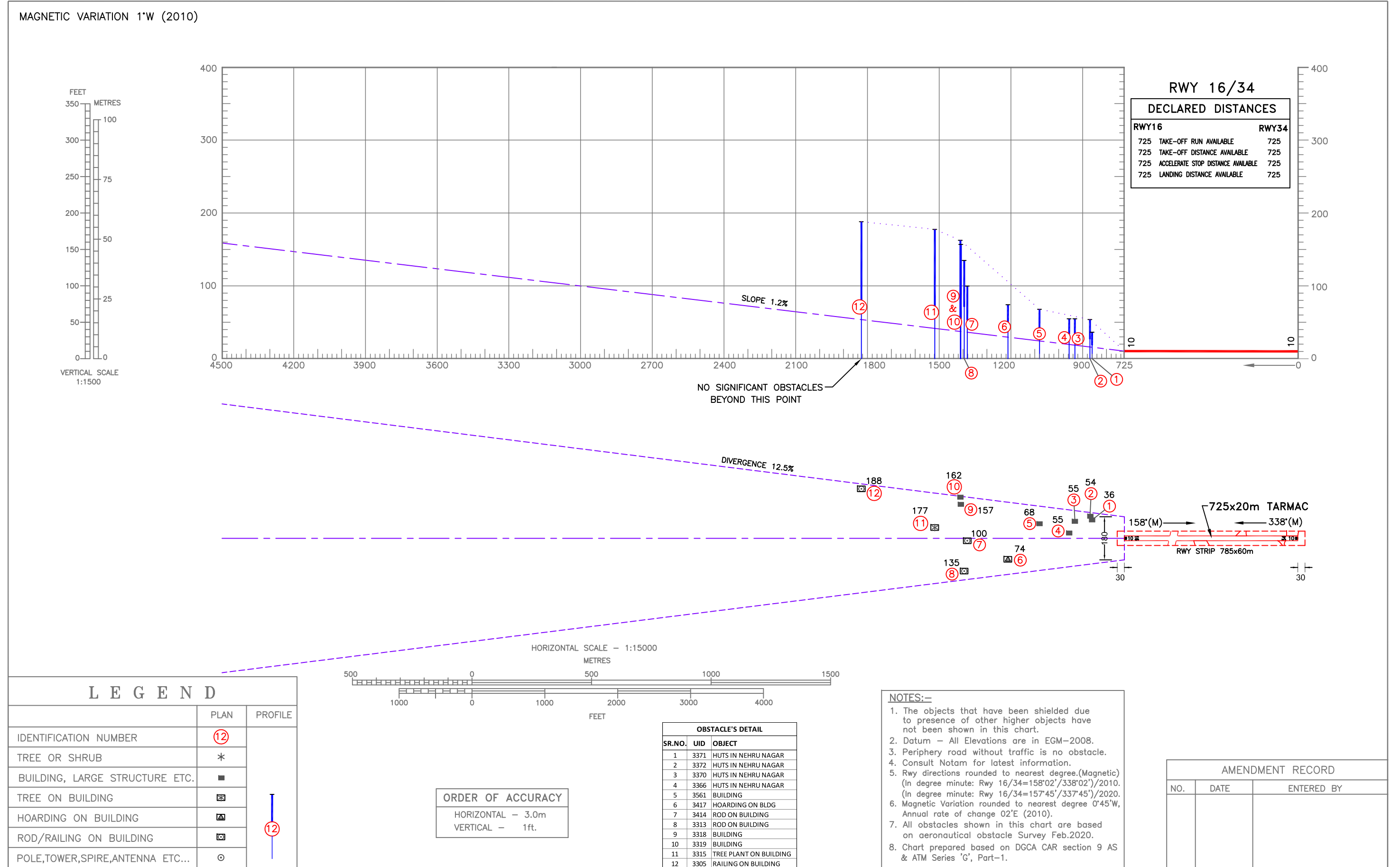

AERONAUTICAL INFORMATION UPTO - SEPT. 2020
वैमानिक सूचना - सितंबर 2020 तक

COMPILED BY- CARTO, AIRPORTS AUTHORITY OF INDIA
संग्रहित किया : कार्टो, भारतीय विमानपत्तन प्राधिकरण

CHART No. AAI/53-OBS/CARTO/2020
चार्ट सं. भा.वि.प्रा./53-अव./कार्टो/2020