

TEL: +91-11-24632950 Extn: 2219/2233 AFS: VIDDYXAX FAX: +91-11-24615508 Email: gmais@aai.aero	INDIA AERONAUTICAL INFORMATION SERVICE AIRPORTS AUTHORITY OF INDIA RAJIV GANDHI BHAVAN SAFDARJUNG AIRPORT NEW DELHI – 110003	29/2021
		11 FEB 2021

File No. AAI/ATM/AIS/09-09/2021

Following supplement is issued for information, guidance and necessary action.

sd/-

अनुज अग्रवाल

ANUJ AGGARWAL

अध्यक्ष/CHAIRMAN

भारतीय विमानपत्तन प्राधिकरण

AIRPORTS AUTHORITY OF INDIA

[EFFECTIVE DATE: 25 MAR 2021]

AERODROME DATA**MANGALORE AIRPORT, MANGALORE (VOML)****VOML AD 2.2 AERODROME GEOGRAPHICAL AND ADMINISTRATIVE DATA**

1	Aerodrome reference point coordinates and its site	125743.42N 0745323.23E MAG. BRG. 289.3DEG /697 M from physical extremity of RWY 24.
3	Aerodrome elevation and reference temperature	318 FT / 42.0 DEG C
4	Magnetic Variation, date of information and annual change	1.866 DEG W (2010) /0.033 DEG E
7	Remarks	i. Aerodrome located on hilltop. Valleys 200 FT to 250 FT immediately beyond Runway End Safety Area. ii. Elevation in EGM08

Amend VOML AD 2.2 eAIP India accordingly.

VOML AD 2.8 APRONS, TAXIWAYS AND CHECK LOCATIONS/POSITIONS DATA

1	Designation, surface and strength of aprons	Refer Aircraft Parking/Docking Chart		
2	Designation, width, surface and strength of taxiways	Refer Aircraft Parking/Docking Chart		
4	Location of VOR checkpoints	Location	Coordinates	Elevation (FT)

		TWY A	125744.54N 0745325.19E	337
		TWY C	125739.79N 0745344.36E	310
		TWY E	125657.86N 0745234.54E	305
		TWY G	125706.32N 0745249.17E	305
6	Remarks	i. Coordinates of RWY Holding Position		
		TWY	Coordinates	Elevation (FT)
		TWY A	125743.67N 0745325.21E	338
		TWY B	125743.76N 0745328.86E	336
		TWY C	125739.62N 0745344.36E	310
		TWY D	125728.94N 0745325.49E	321
		TWY E	125657.72N 0745234.62E	305
		TWY F	125741.89N 0745333.37E	328
		TWY G	125706.18N 0745249.26E	305
		TWY H	125744.14N 0745319.00E	334
		TWY J	125739.38N 0745338.37E	317
		ii. Coordinates of RWY & Taxi Intersection		
		TWY	Coordinates	Elevation (FT)
		TWY C	125736.0340N 0745344.4130E	311
		TWY D	125724.6620N 0745325.5730E	317
		TWY E	125654.9530N 0745236.3590E	309
		TWY G	125703.6870N 0745250.8270E	309
		iii. Coordinates of Intermediate Holding Positions		
		Intermediate Holding Position on TWY D	125739.32N 0745325.30E	337

	Intermediate Holding Position on TWY D	125701.04N 0745234.88E	300
	Intermediate Holding Position on TWY D	125732.74N 0745327.38E	324
iv. Elevations in EGM08			

Amend VOML AD 2.8 eAIP India accordingly.

VOML AD 2.10 AERODORME OBSTACLES

RWY/Area affected	Obstacle type	Coordinates	Elevation (FT) (EGM08)	Marking/ LGT	Remarks
1	2	3	4	5	6
APCH 06 TKOF 24	Other	125650.44N 0745235.25E	320	-	Mobile road traffic (road elevation=92.5 m +5m traffic height)
APCH 06 TKOF 24	Tree	125649.92N 0745234.12E	333	-	Group of trees
APCH 06 TKOF 24	Tree	125649.82N 0745231.01E	324	-	Group of trees
APCH 06 TKOF 24	Tree	125649.23N 0745235.97E	338	-	Group of trees
APCH 24 TKOF 06	Tree	125745.64N 0745353.40E	341	-	Group of trees
APCH 24 TKOF 06	Tree	125735.66N 0745351.29E	327	-	Group of trees
APCH 24 TKOF 06	Tree	125825.29N 0745543.43E	475	-	Group of trees
APCH 24 TKOF 06	Tree	125825.65N 0745543.58E	477	-	Group of trees
APCH 24 TKOF 06	Pole	125825.26N 0745546.30E	467	-	Electric pole
APCH 24 TKOF 06	Pole	125824.51N 0745547.66E	471	-	Electric pole
APCH 24 TKOF 06	Tree	125824.43N 0745547.98E	485	-	Group of trees
APCH 24 TKOF 06	Tank	125823.69N 0745548.96E	494	LGT	O.H.W.T.
In circling area and at AD	Other	125656.12N 0745232.85E	323	-	Mobile road traffic (road elevation 93.6 +5m traffic height)
In circling area and at AD	Other	125653.74N 0745234.34E	311	LGT	Approach light

In circling area and at AD	Fence	125650.64N 0745236.30E	311	-	Airport boundary wall with fence on top (B wall top=94.1 m)
In circling area and at AD	Fence	125653.70N 0745240.92E	314	-	Airport boundary wall with fence on top (B wall top=94.8 m)
In circling area and at AD	Other	125654.90N 0745241.76E	327	LGT	WDI
In circling area and at AD	Other	125654.78N 0745242.42E	311	-	Security hut
In circling area and at AD	Pole	125725.92N 0745333.41E	321	-	Light pole
In circling area and at AD	Other	125733.50N 0745333.78E	343	LGT	WDI
In circling area and at AD	Tree	125729.02N 0745340.80E	359	-	Group of trees
In circling area and at AD	Pole	125729.46N 0745339.99E	325	-	Electric pole
In circling area and at AD	Other	125735.15N 0745348.44E	313	-	Mobile road traffic (road elevation= 90.3 +5m traffic height)
In circling area and at AD	Nav Aid	125736.25N 0745336.91E	332	LGT	GP monitor antenna
In circling area and at AD	Nav Aid	125735.17N 0745334.85E	331	LGT	GP DME antenna
In circling area and at AD	Nav Aid	125735.16N 0745334.73E	327	LGT	GP hut top
In circling area and at AD	Nav Aid	125735.02N 0745334.88E	366	LGT	GP main antenna
In circling area and at AD	Other	125733.97N 0745333.26E	339	-	Met antenna
In circling area and at AD	Other	125725.56N 0745332.77E	325	-	Security hut
In circling area and at AD	Other	125733.47N 0745332.77E	326	-	RVR antenna
In circling area and at AD	Other	125733.88N 0745333.11E	349	-	Met antenna
In circling area and at AD	Other	125734.04N 0745333.59E	323	-	Met antenna
In circling area and at AD	Other	125733.99N 0745333.63E	326	-	RVR antenna
In circling area and at AD	Other	125733.93N 0745333.64E	340	-	Met antenna
In circling area and at AD	Other	125734.97N 0745334.27E	326	-	Bird chaser hut

In circling area and at AD	Tree	125732.14N 0745344.37E	348	-	Group of trees
In circling area and at AD	Building	125732.04N 0745344.48E	315	-	Building
In circling area and at AD	Tree	125729.31N 0745342.85E	355	-	Group of trees
In circling area and at AD	Tree	125730.83N 0745347.00E	354	-	Group of trees
In circling area and at AD	Tree	125734.07N 0745351.49E	332	-	Group of trees
In circling area and at AD	Tree	125723.67N 0745334.19E	358	-	Group of trees
In circling area and at AD	Tree	125745.63N 0745347.50E	342	-	Group of trees
In circling area and at AD	Pole	125823.68N 0745549.22E	474	-	Electric pole
In circling area and at AD	Tree	125822.58N 0745549.98E	477	-	Group of trees
In circling area and at AD	Tree	125822.19N 0745547.98E	473	-	Group of trees
In circling area and at AD	Other	125707.01N 0745251.81E	323	-	Mobile road traffic (road elevation=93.3 m +5m traffic height)
In circling area and at AD	Pole	125704.75N 0745258.73E	310	-	Light pole
In circling area and at AD	Fence	125707.40N 0745304.12E	327	-	Airport boundary wall with fence on top (B wall top=98.9 m)
In circling area and at AD	Pole	125713.48N 0745312.99E	315	-	Light pole
In circling area and at AD	Other	125717.78N 0745318.62E	323	-	Mobile road traffic (road elevation=93.3 m +5m traffic height)
In circling area and at AD	Tree	125722.43N 0745328.44E	383	-	Group of trees
In circling area and at AD	Pole	125723.41N 0745329.12E	323	-	Light pole
In circling area and at AD	Other	125723.50N 0745329.19E	327	-	Security hut
In circling area and at AD	Other	125722.92N 0745316.30E	316	-	Security hut
In circling area and at AD	Other	125721.94N 0745316.67E	326	-	Mobile road traffic (road elevation 94.5 +5m traffic height)

In circling area and at AD	Other	125712.68N 0745311.51E	323	-	Security hut
In circling area and at AD	Other	125714.27N 0745313.96E	329	-	Mobile road traffic (road elevation=95.2 m +5m traffic height)
In circling area and at AD	Other	125714.58N 0745314.57E	317	-	Security hut
In circling area and at AD	Tree	125718.56N 0745321.85E	342	-	Group of trees
In circling area and at AD	Tree	125720.91N 0745326.37E	373	-	Group of trees
In circling area and at AD	Building	125722.85N 0745328.60E	335	-	Building
In circling area and at AD	Tree	125724.58N 0745331.20E	356	-	Group of trees
In circling area and at AD	Tree	125704.94N 0745306.06E	341	-	Group of trees
In circling area and at AD	Building	125731.82N 0745318.14E	399	LGT	L/C rod on fire station building (Bldg. top=117.1 m)
In circling area and at AD	Building	125731.85N 0745314.99E	427	LGT	L/C rod on ATC building (Bldg. top=125.5 m)
In circling area and at AD	Pole	125724.90N 0745316.65E	323	-	Light pole
In circling area and at AD	Tree	125702.46N 0745300.35E	352	-	Group of trees
In circling area and at AD	Other	125711.81N 0745316.21E	336	-	Security hut
In circling area and at AD	Mast	125523.20N 0745402.60E	569	LGT	Doordarshan tower (TV tower)
In circling area and at AD	Mast	125903.01N 0745417.38E	498	LGT	Cellphone mast
In circling area and at AD	Mast	125722.86N 0745549.34E	500	-	Pylon mast
In circling area and at AD	Mast	125543.88N 0745333.48E	484	LGT	Cellphone mast
In circling area and at AD	Mast	125727.09N 0745544.90E	556	LGT	Cellphone mast

Replace VOML AD 2.10 of eAIP India with the above table. All elevations in EGM08

VOML AD 2.12 RUNWAY PHYSICAL CHARACTERISTICS

Designations	True BRG	Dimensions of RWY (M)	Strength of pavement (PCN) and associated data) and surface of runway and associated stop ways	Geographical coordinates for threshold and runway end
1	2	3	4	5
06	058.39 DEG	2450 x 45 M	80/R/B/W/T Concrete	THR: 125656.80N 0745239.42E RWY END: 125736.55N 0745345.27E
24	0238.39 DEG	2450 x 45 M	80/R/B/W/T Concrete	THR: 125736.55N 0745345.27E RWY END: 125654.76N 0745236.04E
THR elevation and highest elevation of TDZ of precision APP RWY	Slope of runway and associated stop way	Dimensions of stop way (M)	Dimensions of clearway (M)	Dimensions of strips (M)
6	7	8	9	10
THR: 309FT TDZ: 309FT	0.00%	NIL	NIL	2570 x 150 M
THR: 310FT TDZ: 318FT	0.00%	NIL	NIL	2570 x 150 M
Dimensions of runway end safety areas	Location and description of arresting system (if any)	Existence of an obstacle-free zone	Remarks.	
11	12	13	14	
240M x 90M			i. Runway Slope: 0 to 1344M: 0%, 1345M to 1884M: +0.56%, 1884M to 2450M: -0.46% ii. Elevation of EGM08	
244M x 90M			i. Runway Slope: 0 to 566M: +0.46%, 565M to 1105M: -0.56%, 1105M to 2450M: 0% ii. Elevation of EGM08	

Amend VOML AD 2.12 eAIP India accordingly.

VOML AD 2.13 DECLARED DISTANCES

RWY Designator	TORA (M)	TODA (M)	ASDA (M)	LDA (M)	Remarks (including runway entry or start point where alternative reduced declared distances have been declared)
1	2	3	4	5	6
06	2450	2450	2450	2330	THR Displaced by 120M
24	2450	2450	2450	2450	Nil

Amend VOML AD 2.13 of eAIP India accordingly

VOML AD 2.14 APPROACH AND RUNWAY LIGHTING

Runway Designator	Type, length and intensity of approach lighting system;	Runway threshold lights, colour and wing bars;	Type of visual slope indicator system	Length of runway touchdown zone Lights;
1	2	3	4	5
06	SALS 420 M LIH	Green	PAPI LEFT/3.00 DEG (MEHT 50.72FT)	NIL
24	SALS 420 M LIH	Green	PAPI LEFT/3.00 DEG (MEHT 50.26FT)	NIL
Length, spacing, colour and intensity of runway centre line lights	Length, spacing, colour and intensity of runway edge lights	Colour of runway end lights and wing bars	Length and colour of stopway lights	Remarks
6	7	8	9	10
NIL	2450 M 60 M WHITE LIH	RED	NIL	i. Turn pad lights available.
NIL	2450 M 60 M WHITE LIH	RED	NIL	i. Turn pad lights available.

Amend VOML AD 2.14 of eAIP India accordingly.

VOML AD 2.19 RADIO NAVIGATION AND LANDING AIDS

Type of aids, magnetic and type of supported operation for ILS/MLS, basic GNSS, SBAS and GBAS, and for VOR/ILS/MLS station used for technical line-up of the aid	Identification	Frequency(ies), Channel number(s), Service provider, and reference path identifier(s) (RPI), as appropriate	Hours of operation, as appropriate;	Geographical coordinates of the position of the transmitting antenna	Elevation of transmitting antenna of DME/ elevation of GBAS reference point	Service volume radius from the GBAS reference point	Remarks
1	2	3	4	5	6	7	8
LOC 24	IMNG	110.100 MHz	H24	125650.73N 0745229.36E			
GP 24		334.400 MHz	H24	125735.02N 0745334.88E			3 DEG
DME ILS 24	IMNG	CH38X	H24	125735.17N 0745334.85E	331FT		i. Collocated with GP. ii. Elevations in EGM08
DVOR	MML	114.200 MHz	H24	125705.83N 0745307.66E			
DME	MML	CH89X	H24	125705.63N 0745307.32E	333FT		i. Elevations in EGM08
NDB	ML	357KHz	H24	125747.32N 0745331.36E			

Amend VOML AD 2.19 and ENR4.1 of eAIP India accordingly.

AMENDMENTS / CANCELLATION:

1. **Replace** Aerodrome Chart in VOML AD 2.24 of eAIP India with the Aerodrome Chart of this AIP supplement.
2. **Replace** Aircraft Parking/Docking Chart in VOML AD 2.24 of eAIP India with the Aircraft Parking/Docking Chart of this AIP supplement.
3. **Replace** Aerodrome Obstacle Chart Type - A (Operating Limitations) RWY 06 in VOML AD 2.24 of eAIP India with the Aerodrome Obstacle Chart type - A (Operating Limitations) RWY 06 of this AIP supplement.
4. **Replace** Aerodrome Obstacle Chart Type - A (Operating Limitations) RWY 24 in VOML AD 2.24 of eAIP India with the Aerodrome Obstacle Chart type - A (Operating Limitations) RWY 27 of this AIP supplement.
5. **Delete** Sl. No. 6 (Parking Stand characteristic) and associated table in VOML AD 2.23 of eAIP India.
6. **Delete Sl. No. 8** (Slope of RWY –SWY) in VOML AD 2.23 of eAIP India.
7. **Delete Sl. No. 15** (Coordinates of Taxi Holding positions) in VOML AD 2.23 of eAIP India.

AERODROME CHART

12°57'43.42"N
074°53'23.23"E

ELEV. 318'

TWR 118.750
TWR 122.100

MANGALORE, INDIA

MANGALORE AIRPORT

RWY	DIRECTION	THR CO-ORDINATES	THR ELEV.	BEARING STRENGTH
06	60°	12°56'56.80"N 074°52'39.42"E	309	80/R/B/W/T
24	240°	12°57'36.55"N 074°53'45.27"E	310	
HS1	JUNCTION OF TWY E WITH PERIMETER ROAD			

- * DATUM : WGS-84
- * RWY BEARINGS ARE MAGNETIC
- * DIMENSIONS IN METRES
- * ELEVATIONS IN FEET (EGM-08)
- * TAXIWAY WIDTH-A,B,C,D,E,G,G,J-23M
- * TAXIWAY WIDTH-TWY H-15M
- * TAXIWAY WIDTH-TWY P & TWY F-45M

DECLARED DISTANCES (IN METRES)					
RWY	TORA	TODA	ASDA	LDA	NOTAM NO.
06	2450	2450	2450	2330	
24	2330	2330	2330	2330	

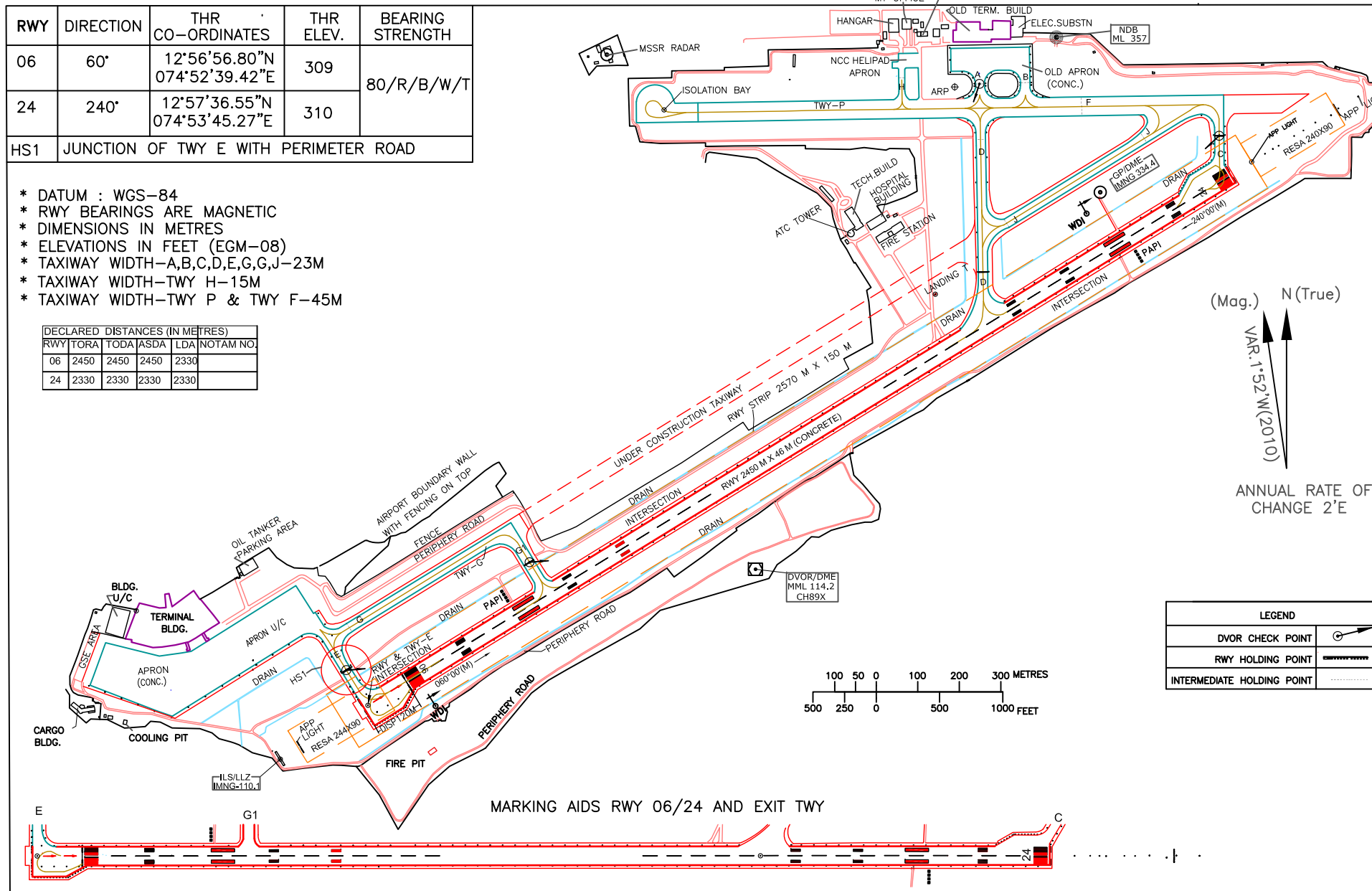

(Mag.) N (True)
VAR: 1°52'W (2010)
ANNUAL RATE OF CHANGE 2'E

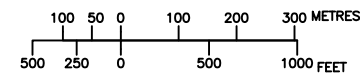

LEGEND	
DVOR CHECK POINT	
RWY HOLDING POINT	
INTERMEDIATE HOLDING POINT	

MARKING AIDS RWY 06/24 AND EXIT TWY

DATE OF AERONAUTICAL INFORMATION

AUGUST-2020(updated as on 11.02.2021)

**AIRCRAFT PARKING/
DOCKING CHART**

**OLD APRON ELEV. 335ft.
NEW APRON ELEV. 289ft.**

**TWR 118.750
TWR 122.100**

MANGALORE, INDIA

MANGALORE AIRPORT

- * DATUM : WGS 84
- * DISTANCES IN METRES
- * ELEVATION IN FEET(EGM-08)

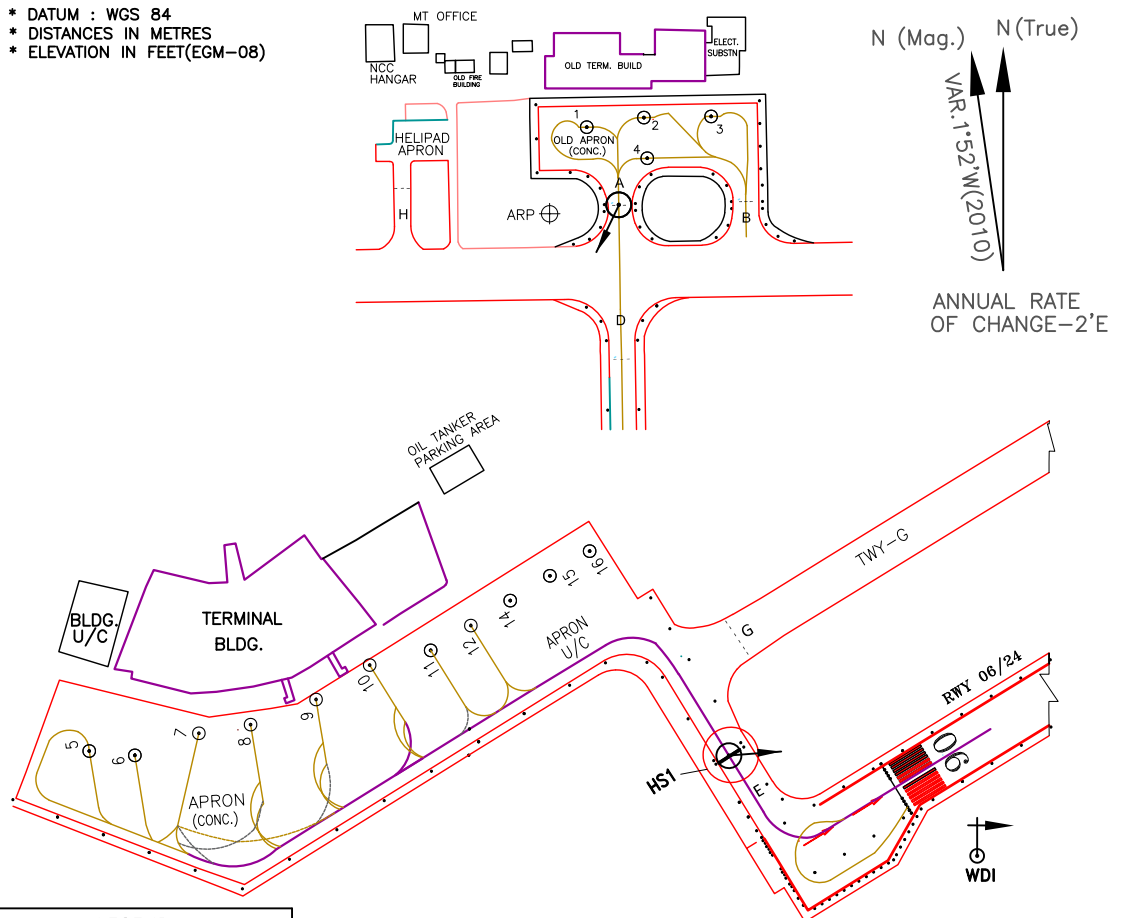

LEGEND	
AIRCRAFT STANDS	16
DVOR CHECK POINT	
RWY HOLDING POINT	
INTERMEDIATE HOLG.P	
HS1	

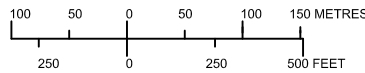

APRON					
PARKING STAND NO.	WGS CO-ORDINATES FOR AIRCRAFT STANDS	PCN	SUITABILITY OF AIRCRAFT	ELEV.	Status of Aircraft Stand
1	12°57'45.8606"N 074°53'24.2924"E	64/R/C/W/T	B738/A320	335ft	Power In/ Power Out
2	12°57'46.1314"N 074°53'25.9347"E	64/R/C/W/T	ATR72	336ft	Power In/ Power Out
3	12°57'46.1666"N 074°53'27.8649"E	64/R/C/W/T	B738/A320	336ft	Power In/ Power Out
4	12°57'44.9898"N 074°53'26.0308"E	64/R/C/W/T	ATR72	337ft	Power In/ Power Out
5	12°56'57.8431"N 074°52'16.2507"E	86/R/B/W/T	ATR72-500	291ft	Power In/ power out
6	12°56'57.7230"N 074°52'17.5616"E	86/R/B/W/T	BOMB-400	291ft	Power In/ Push back
7	12°56'58.3436"N 074°52'19.3967"E	86/R/B/W/T	A321/B738	292ft	Power In/ Push back
8	12°56'58.5893"N 074°52'20.8837"E	86/R/B/W/T	B767-400	292ft	Power In/ Push back
9	12°56'59.2994"N 074°52'22.7627"E	86/R/B/W/T	B767-400ER	292ft	Power In/ Push back
10	12°57'00.2657"N 074°52'24.3052"E	86/R/B/W/T	B767-400ER	292ft	Power In/ Push back
11	12°57'00.6815"N 074°52'26.0559"E	61/R/B/W/T	A320-200/B737-800W	293ft	Power In/ Push back
12	12°57'01.3848"N 074°52'27.2071"E	61/R/B/W/T	A321-200/B737-800	294ft	Power In/ Push back
14	12°57'02.0874"N 074°52'28.3409"E	59/R/B/X/T	B738-800/A321-200	295ft	Power In/ Push back
15	12°57'02.7867"N 074°52'29.4810"E	59/R/B/X/T	B738-800/A321-200	295ft	Power In/ Push back
16	12°57'03.4829"N 074°52'30.6217"E	59/R/B/X/T	B738-800/A321-200	296ft	Power In/ Push back

TWY	PCN	WIDTH
A	54/F/B/W/T	23M
B	54/F/B/W/T	23M
C	80/F/B/W/T	23M
D	80/F/B/W/T	23M
E	80/R/B/W/T	23M
F	54/F/B/W/T	45M
G	74/R/B/W/T	23M
G1	74/R/B/W/T	23M
H	20/F/B/X/U	15M
J	74/R/B/W/T	23M
P	54/F/B/W/T	45M

DATE OF AERONAUTICAL INFORMATION
AUGUST-2020

AIRPORTS AUTHORITY OF INDIA

DRG.NO.-AAI/16-PDC/2020
(updated as on 11.02.2021)

ELEVATIONS IN FEET
ALL OTHER DIMENSIONS IN METERS

AERODROME OBSTACLE CHART

TYPE-A (OPERATING LIMITATIONS)

INDIA / MANGALORE
MANGALORE AIRPORT/RWY 06

MAGNETIC VARIATION 2°W (2010)

RWY 06/24

DECLARED DISTANCES (m)

RWY 06	RWY 24
2450 TAKE-OFF RUN AVAILABLE	2330
2450 TAKE-OFF DISTANCE AVAILABLE	2330
2450 ACCELERATE STOP DISTANCE AVAILABLE	2330
2330 LANDING DISTANCE AVAILABLE	2330

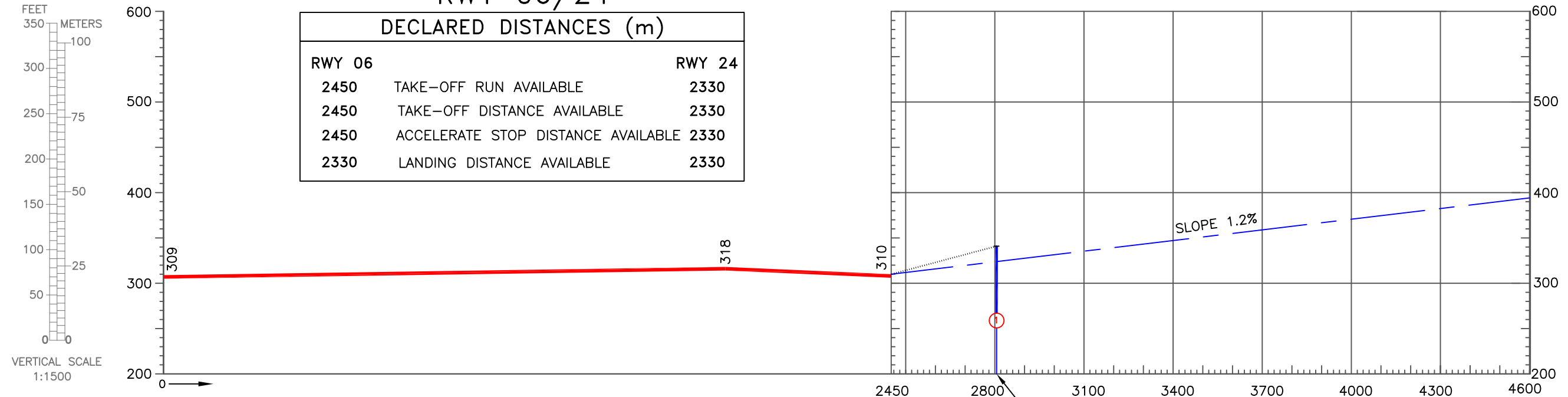

NO SIGNIFICANT OBSTACLES
BEYOND THIS POINT

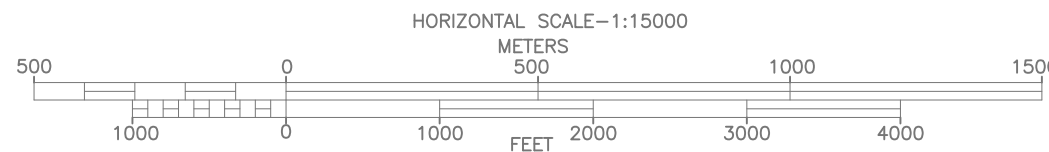
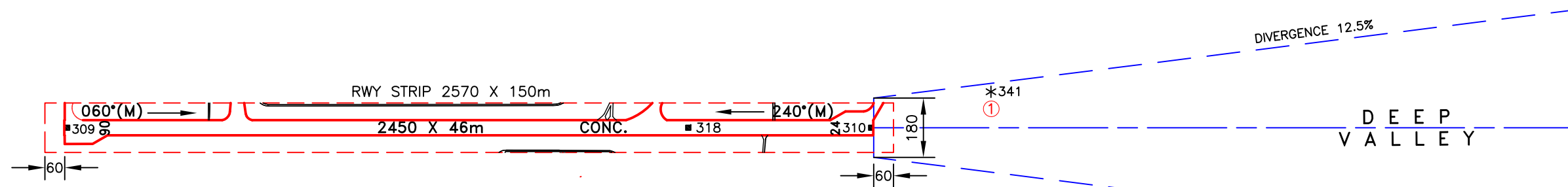

- NOTES:-**
- The objects that have been shielded due to presence of other higher objects have not been shown in this chart.
 - Datum - All Elevations are in EGM-2008.
 - Periphery road without traffic is no obstacle.
 - Consult Notam for latest information.
 - Rwy directions rounded to nearest degree.(Magnetic)
(In degree minute : Rwy 06/24 =060°17'/240°17') (2010)
(In degree minute : Rwy 06/24 =059°59'/239°59') (2019)
 - Magnetic variation rounded to nearest degree 1°52'W,
Annual rate of change 2' E (2010).
 - All obstacles shown in this chart are based on aeronautical obstacle Survey Oct.2019.
 - Chart prepared based on CAR Section 9 AS&ATM Series 'G', Part-I.

AMENDMENT RECORDS		
No.	DATE	REMARKS
1.	14.12.20	Dec distances Rwy 24 amend. as per JGM(ATM) mail dt.09Dec.2020.

LEGEND		
	PLAN	PROFILE
IDENTIFICATION NUMBER	①	
TREE OR SHRUB	*	①
RWY ELEV.(SPOT)	■ 318	
ROAD	=	

ORDER OF ACCURACY
HORIZONTAL - 3.0m
VERTICAL - 1ft

OBSTACLE TABLE APP. RWY 24		
S.NO.	APP.CHART UID	OBJECT
1.	6817	GROUP OF TREE

AERONAUTICAL INFORMATION UPTO - NOV. 2020
वैमानिक सूचना - नवम्बर 2020 तक

COMPILED BY-CARTO, AIRPORTS AUTHORITY OF INDIA
संग्रहित किया : कार्टो, भारतीय विमानपत्तन प्राधिकरण

(UPDATED AS ON 14.12.2020)

CHART NO. AAI/33-OBS/CARTO/2020
चार्ट सं. भा.वि.प्रा./33-अव./कार्टो/2020

ELEVATIONS IN FEET
ALL OTHER DIMENSIONS IN METERS

AERODROME OBSTACLE CHART

TYPE-A (OPERATING LIMITATIONS)

INDIA / MANGALORE
MANGALORE AIRPORT/RWY 24

MAGNETIC VARIATION 2°W (2010)

RWY 06/24

DECLARED DISTANCES (m)

RWY 06	RWY 24
2450 TAKE-OFF RUN AVAILABLE	2330
2450 TAKE-OFF DISTANCE AVAILABLE	2330
2450 ACCELERATE STOP DISTANCE AVAILABLE	2330
2330 LANDING DISTANCE AVAILABLE	2330

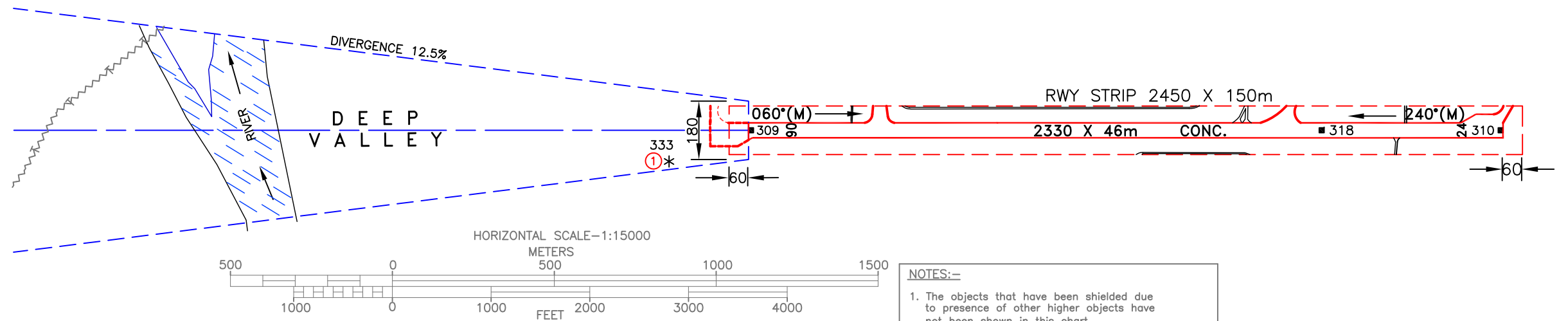
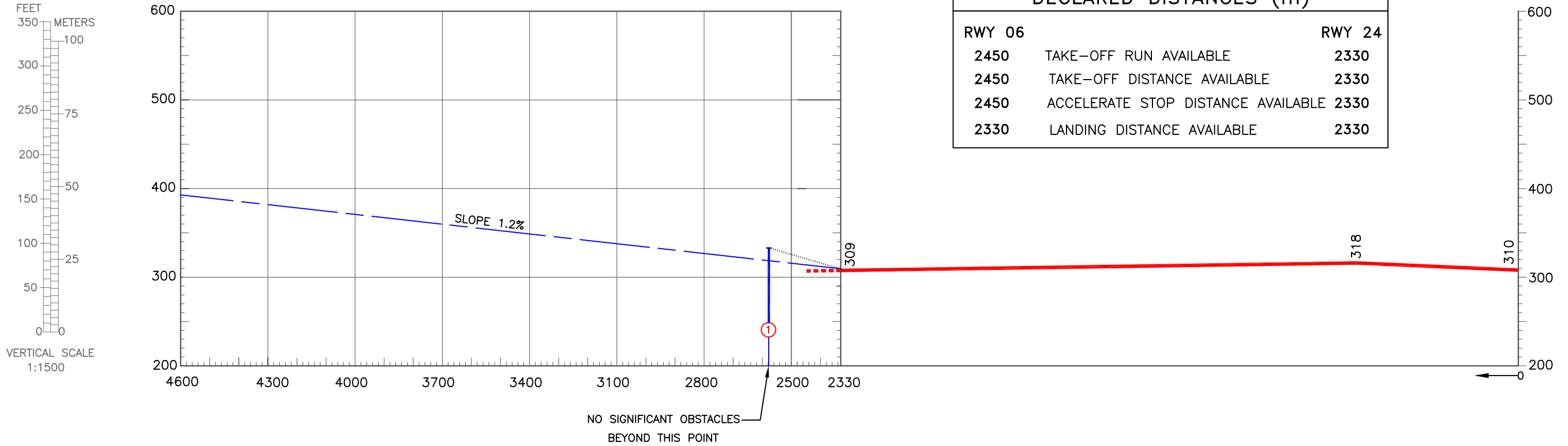

LEGEND

	PLAN	PROFILE
IDENTIFICATION NUMBER	①	①
TREE OR SHRUB	*	①*
HIGH TENSION LINE	~	
RWY ELEV.(SPOT)	■ 318	
ROAD	=	

ORDER OF ACCURACY
HORIZONTAL - 3.0m
VERTICAL - 1Ft

OBSTACLE TABLE APP.RWY 06

S.No.	APP. CHART UID	OBJECT
1	5945	GROUP OF TREE

NOTES:-

1. The objects that have been shielded due to presence of other higher objects have not been shown in this chart.
2. Datum - All Elevations are in EGM-2008.
3. Periphery road without traffic is no obstacle.
4. Consult Notam for latest information.
5. Rwy directions rounded to nearest degree.(Magnetic)
(In degree minute : Rwy 06/24 =060°17'/240°17') (2010)
(In degree minute : Rwy 06/24 =059°59'/239°59') (2019)
6. Magnetic variation rounded to nearest degree 1°52'W,
Annual rate of change 2' E (2010).
7. All obstacles shown in this chart are based on aeronautical obstacle Survey Oct.2019.
8. Chart prepared based on CAR Section 9 AS&ATM Series 'G', Part-I.

AMENDMENT RECORDS

No.	DATE	REMARKS
1.	14.12.20	Dec distances Rwy 24 amend. as per JGM(ATM) mail dt.09Dec.2020.

AERONAUTICAL INFORMATION UPTO - NOV. 2020
वैमानिक सूचना - नवम्बर 2020 तक

COMPILED BY-CARTO, AIRPORTS AUTHORITY OF INDIA
संग्रहित किया : कार्टो, भारतीय विमानपत्तन प्राधिकरण

(UPDATED AS ON 14.12.2020)

CHART NO. AAI/34-OBS/CARTO/2020
चार्ट सं. भा.वि.प्रा./34-अव./कार्टो/2020