

TEL: +91-11-24632950 Extn: 2219/2233 AFS: VIDDYXAX FAX: +91-11-24615508 Email: <a href="mailto:gmais@aai.aero">gmais@aai.aero</a>	<b>INDIA</b> <b>AERONAUTICAL INFORMATION SERVICE</b> <b>AIRPORTS AUTHORITY OF INDIA</b> <b>RAJIV GANDHI BHAVAN</b> <b>SAFDARJUNG AIRPORT</b> <b>NEW DELHI – 110003</b>	145/2025
		24 JUL 2025

File No. ATM-19013(19)/1/2025-ATM

Following supplement is issued for information, guidance and necessary action.

sd/-

विपिन कुमार

VIPIN KUMAR

अध्यक्ष/CHAIRMAN

भारतीय विमानपत्तन प्राधिकरण

AIRPORTS AUTHORITY OF INDIA

**[EFFECTIVE DATE: 04 SEP 2025]****AERODROME DATA****SOLAPUR AIRPORT, SOLAPUR (VASL)****VASL AD 2.1 AERODROME LOCATION INDICATOR AND NAME**

VASL – SOLAPUR AIRPORT, SOLAPUR

**VASL AD 2.2 AERODROME GEOGRAPHICAL AND ADMINISTRATIVE DATA**

1	Aerodrome reference point coordinates and its site	173739.55N 0755602.54E	
2	Direction and distance of aerodrome reference point from the centre of the city or town which the aerodrome serves	7 KM Southeast of Solapur Railway Station.	
3	Aerodrome elevation and reference temperature	1588 FT/ 40.7 DEG C	
4	Magnetic variation, date of information and annual change	1 DEG W (2010) /0.033 DEG E	
		Address	Airport Director, Airports Authority of India, Solapur Airport, Solapur 413224
		Telephone	0217-2607071
		email	<a href="mailto:apdvasl@aai.aero">apdvasl@aai.aero</a>

6	Types of traffic permitted (IFR/VFR)	VFR (Day Operations)
7	Remarks	Gravity Model: EGM-08

### VASL AD 2.3 OPERATIONAL HOURS

1	Aerodrome Operator	MON-FRI 0400 –1230 UTC (0930-1800 IST) SAT, SUN: NIL
2	Customs and immigration	Not Applicable
3	Health and sanitation	As ATS
4	AIS Briefing office	As ATS
5	ATS Reporting Office (ARO)	As ATS
6	MET Briefing office	As ATS
7	Air Traffic Service	Refer NOTAM
8	Fuelling	As ATS
9	Handling	Not Available
10	Security	Maharashtra State Police
11	De-icing	NIL
12	Remarks	Non-Schedule flight to obtain positive clearance at least 48 hrs. prior to departure for Solapur Airport.

### VASL AD 2.4 HANDLING SERVICES AND FACILITIES

1	Cargo-handling facilities	Not Available
2	Fuel and oil types	JET A1
3	Fuelling facilities and capacity	HPCL Bowsers
4	De-icing facilities	Not Available
5	Hanger space for visiting aircraft	Not Available
6	Repair facilities for visiting aircraft	Not Available
7	Remarks	NIL

### VASL AD 2.5 PASSENGER FACILITIES

1	Hotel(s) at or in the vicinity of aerodrome	Available in City
2	Restaurant(s) at or in the vicinity of aerodrome	Available
3	Transportation possibilities	Auto/Cab from AD
4	Medical Facilities	Available (First aid in Terminal building PHC facility hospital 2 km. Serious & critical case 9 km hospital)
5	Bank and post office at or in the vicinity of aerodrome	Available in City
6	Tourist office	Available in City
7	Remarks	NIL

### VASL AD 2.6 RESCUE AND FIRE FIGHTING SERVICES

1	Aerodrome category for fire fighting	CAT 5 within ATS Operational Hrs
2	Rescue equipment	CFT: 1 (One) Ambulance: 1 (One)
3	Capability for removal of disabled aircraft	<ol style="list-style-type: none"><li>1. The critical aircraft for Solapur Airports is ATR42.</li><li>2. Primary responsibility for removal of disabled aircraft rests with the concerned airline.</li><li>3. The airlines may contact 'Aerodrome Coordinator for Disabled Aircraft Removal Operations' for coordinating with agencies having Disabled Aircraft Recovery Kit.</li><li>4. Contact Details of Aerodrome Coordinator for Disabled Aircraft Removal Operations: Airport Director Contact Details: +91 217 2607071 <a href="mailto:apdvasl@aai.aero">apdvasl@aai.aero</a></li></ol>
4	Remarks	NIL

### VASL AD 2.7 SEASONAL AVAILABILITY – CLEARING

1	Type(s) of clearing equipment	NIL
2	Clearance priorities	NIL
3	Remarks	NIL

## VASL AD 2.8 APRONS, TAXIWAYS AND CHECK LOCATIONS/POSITIONS DATA

1	Designation, surface and strength of aprons	Refer Aircraft Parking/Docking Chart	
2	Designation, width, surface and strength of taxiways	TWY A PCN: 19/F/B/W/T Width: 23M Surface: Asphalt	
3	Location and elevation of altimeter checkpoints	Location	Centre of the apron on power out taxiway marking
		Elevation	482.434 M
4	Location of VOR checkpoints	NIL	
5	Position of INS checkpoints	NIL	
6	Remarks	<b>1. Coordinates of Runway Holding Position:</b> TWY A: 173735.76N 0755605.00E/ELEV: 1584FT <b>2. Coordinates of RWY &amp; Taxi Intersection:</b> TWY A: 173737.43N 0755607.51E/ELEV: 1584FT 3. Vertical Datum: EGM 08	

## VASL AD 2.9 SURFACE MOVEMENT GUIDANCE AND CONTROL SYSTEM AND MARKINGS

1	Use of aircraft stand identification signs, taxiway guidelines and visual docking/parking guidance system at aircraft stands	Taxiing guidance provided on R/T. Taxi Guidance lines, Apron Stand Markings, Nose wheel markings, Apron safety lines.		
2	Runway and taxiway markings and lights	RWY	Markings	TDZ and APM markings available. Runway designator, threshold marking, Runway centre line & edge line marking, turn pad marking
			Lights	Not Available
		TWY	Marking	Holding point marking, Taxiway Edge marking, Taxiway centre line, shoulder strip markings available
			Lights	Not Available
3	Stop bars (if any)	Not Available		
4	Remarks	NIL		

### VASL AD 2.10 AERODROME OBSTACLES

RWY/Area affected	Obstacle type	Coordinates	Elevation (FT) EGM-08	Marking/ LGT	Remarks
1	2	3	4	5	6
15/APCH 33/TKOF	BUILDING	173816.02N 0755538.27E	1620	-	Building
APCH 33 TKOF 15	STACK	173648.61N 0755641.20E	1705	-	Chimney
33/APCH 15/TKOF	STACK	173646.75N 0755642.61E	1704	-	Chimney
In circling area and at AD	BUILDING	173758.28N 0755440.20E	1744	-	Building
In circling area and at AD	MAST	173912.54N 0755559.74E	1943	-	TV Tower
In circling area and at AD	MAST	173903.04N 0755516.71E	1751	-	Mast
In circling area and at AD	OTHER	173301.24N 0755900.94E	2429	-	Lightning Arrester on NTPC Chimney (Chimney Top 737m)
In circling area and at AD	TREE	173815.74N 0755536.48E	1628	-	Group of Trees
In circling area and at AD	BUILDING	173754.37N 0755441.49E	1746	-	Building

### VASL AD 2.11 METEOROLOGICAL INFORMATION PROVIDED

1	Name of the associated meteorological office	IMD
2	Hours of service and, where applicable, the designation of the responsible meteorological office outside these hours	During ATC watch hours (TBN)
3	Office responsible for preparation of TAFs and periods of validity and interval of issuance of the forecasts	IMD personnel deputed/stationed in tower (Every half hour)
4	Availability of the trend forecast for the aerodrome and interval of issuance	Not available
5	Information on how briefing and/or consultation is provided	No digital means available (During the flight by ATC via VHF).
6	Types of flight documentation supplied and language(s) used in flight documentation	English as per ICAO code
7	Charts and other information displayed or available for briefing or consultation	Not available

8	Supplementary equipment available for providing information on meteorological conditions, e.g. weather radar and receiver for satellite images;	Not available
9	The air traffic services unit(s) provided with meteorological information	ATC
10	Additional information, e.g. concerning any limitation of service.	NIL

### VASL AD 2.12 RUNWAY PHYSICAL CHARACTERISTICS

Designations	TRUE Bearings	Dimensions of RWY (M)	Strength of pavement (PCR and associated data) and surface of runway and associated stopways	Geographical coordinates for threshold and runway end
1	2	3	4	5
15	144.98 DEG	2009 x 45 M	28/F/B/W/T ASPHALT	THR: 173808.46N 0755544.84E RWY END: 173714.93N 0755623.95E
33	324.98 DEG	2009 x 45 M	28/F/B/W/T ASPHALT	THR: 173717.14N 0755622.33E RWY END: 173808.46N 0755544.84E
THR elevation and highest elevation of TDZ of precision APP RWY	Slope of runway and associated stopway	Dimensions of stopway (M)	Dimensions of clearway (M)	Dimensions of strips (M)
6	7	8	9	10
THR: 1586 FT TDZ: 1588 FT	-0.2%	NIL	NIL	2129 x 80 M
THR: 1575 FT TDZ: 1585 FT	+0.2%	NIL	NIL	2129 x 80 M
Dimensions of runway end safety areas	Location and description of arresting system (if any)	Existence of an obstacle-free zone	Remarks.	
11	12	13	14	
90M x 90M	NIL	NA	NIL	
90M x 90M	NIL	NA	NIL	

### VASL AD 2.13 DECLARED DISTANCES

RWY Designator	Take-off run available TORA (M)	Take-off distance available TODA (M)	Accelerate stop distance available ASDA (M)	Landing distance available LDA (M)	Remarks (including runway entry or start point where alternative reduced declared distances have been declared)
1	2	3	4	5	6
15	1926	1926	1926	2009	--
33	2009	2009	2009	1926	THR displaced by 83M

### VASL AD 2.14 APPROACH AND RUNWAY LIGHTING

Runway Designator	Type, length and intensity of approach lighting system	Runway threshold lights, colour and wing bars	Type of visual slope indicator system	Length of runway touchdown zone lights
1	2	3	4	5
15	NIL	NIL	PAPI LEFT/3.20 DEG	NIL
33	NIL	NIL	PAPI LEFT/3.22 DEG	NIL
Length, spacing, colour and intensity of runway centre line lights	Length, spacing, colour and intensity of runway edge lights	Colour of runway end lights and wing bars	Length and colour of stopway lights	Remarks
6	7	8	9	10
NIL	NIL	NIL	NIL	NIL
NIL	NIL	NIL	NIL	NIL

### VASL AD 2.15 OTHER LIGHTING, SECONDARY POWER SUPPLY

1	Location, characteristics and hours of operation of aerodrome beacon/identification beacon (if any)	ABN	Available Installed on top of ATC Tower. Green and White flashes
		IBN	Not AVBL
2	Location and lighting (if any) of anemometer/landing direction indicator;	LDI	Available adjacent to ARP
		Anemometer	Not Available Windsock available near ARP
3		Edge	Not Available

	Taxiway edge and taxiway centre line lights;	Centre line	Not Available
4	Secondary power supply including switch-over time;	Substation: 2 Nos. DG Set 320 KVA each (01 main and 01 standby) Switch-over time: less than 15 SEC	
5	Remarks	NIL	

#### VASL AD 2.16 HELICOPTER LANDING AREA

1	Geographical coordinates of the geometric centre of touchdown and lift-off (TLOF) or of each threshold of final approach and take-off (FATO) area	Not Established
2	TLOF and/or FATO area elevation:	Not Established
3	TLOF and FATO area dimensions to the Nearest metre or foot, surface type, bearing strength and marking;	Not Established
4	True bearings of FATO;	Not Established
5	Declared distances available,	Not Established
6	Approach and FATO lighting;	Not Established
7	Remarks	Not Established

#### VASL AD 2.17 AIR TRAFFIC SERVICES AIRSPACE

1	Airspace designation, geographical coordinates and lateral limits	Circular area centered on 173740N 0755603E within a 10NM radius.
2	Vertical limits	FL 55
3	Airspace classification	Class D
4	Call sign and language(s) of the air traffic services unit providing service;	Solapur Tower ENGLISH
5	Transition altitude	5000 FT
6.	Hours of applicability	HO
6	Remarks	Beyond operational hours airspace classification is Class G

**VASL AD 2.18 AIR TRAFFIC SERVICES COMMUNICATION FACILITIES**

Service Designation	Call sign	Channel(s)	SATVOICE Number(s), if available
<b>1</b>	<b>2</b>	<b>3</b>	<b>4</b>
TWR	Solapur TWR	118.600 MHz	NIL
TWR	Solapur TWR	124.300 MHz	NIL
Logon address, as appropriate	Hours of operation	Remarks	
<b>5</b>	<b>6</b>	<b>7</b>	
NIL	HO	Main Frequency	
NIL	HO	Backup Frequency	

**VASL AD 2.19 RADIO NAVIGATION AND LANDING AIDS**

Type of aids, magnetic and type of supported operation for ILS/MLS, basic GNSS, SBAS and GBAS, and for VOR/ILS/MLS station used for technical line-up of the aid	Identification	Frequency(ies), Channel number(s), Service provider, and reference path identifier(s) (RPI), as appropriate	Hours of operation, as appropriate;
<b>1</b>	<b>2</b>	<b>3</b>	<b>4</b>
NDB	SO	345 KHz	As ATS
Geographical coordinates of the position of the transmitting antenna	Elevation of transmitting antenna of DME/ elevation of GBAS reference point	Service volume radius from the GBAS reference point	Remarks
<b>5</b>	<b>6</b>	<b>7</b>	<b>8</b>
173732.866N 075555.403E	1605 FT		Geoid Model: EGM08

**Amend** coordinates of NDB SO in ENR 4.1 of eAIP India as per above table.

**VASL AD 2.20 LOCAL AERODROME REGULATIONS:**

NIL

**VASL AD 2.21 NOISE ABATEMENT PROCEDURES:**

NIL

**VASL AD 2.22 FLIGHT PROCEDURES:**

**NIL**

**VASL AD 2.24 CHARTS RELATED TO AN AERODROME**

1. Aerodrome Chart
2. Aircraft Parking/Docking Chart
3. Aerodrome Obstacle Chart, Type A (Operating Limitations), RWY 15
4. Aerodrome Obstacle Chart, Type A (Operating Limitations), RWY 33
5. Aerodrome Obstacle Chart, Type B

**VASL AD 2.25 VISUAL SEGMENT SURFACE (VSS) PENETRATION**

<b>Procedure</b>	<b>Procedure Minima</b>	<b>Procedure Minima</b>
<b>1</b>	<b>2</b>	<b>3</b>
---	---	---



- \* DATUM :
- HORIZONTAL : WGS-84
- VERTICAL : EGM 08
- \* BEARINGS ARE MAGNETIC
- \* ELEVATIONS IN FEET..
- \* DIMENSIONS IN METRE

ARP  
17°37'39.5483"N  
075°56'02.5393"E

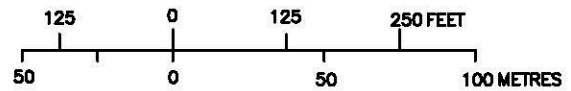
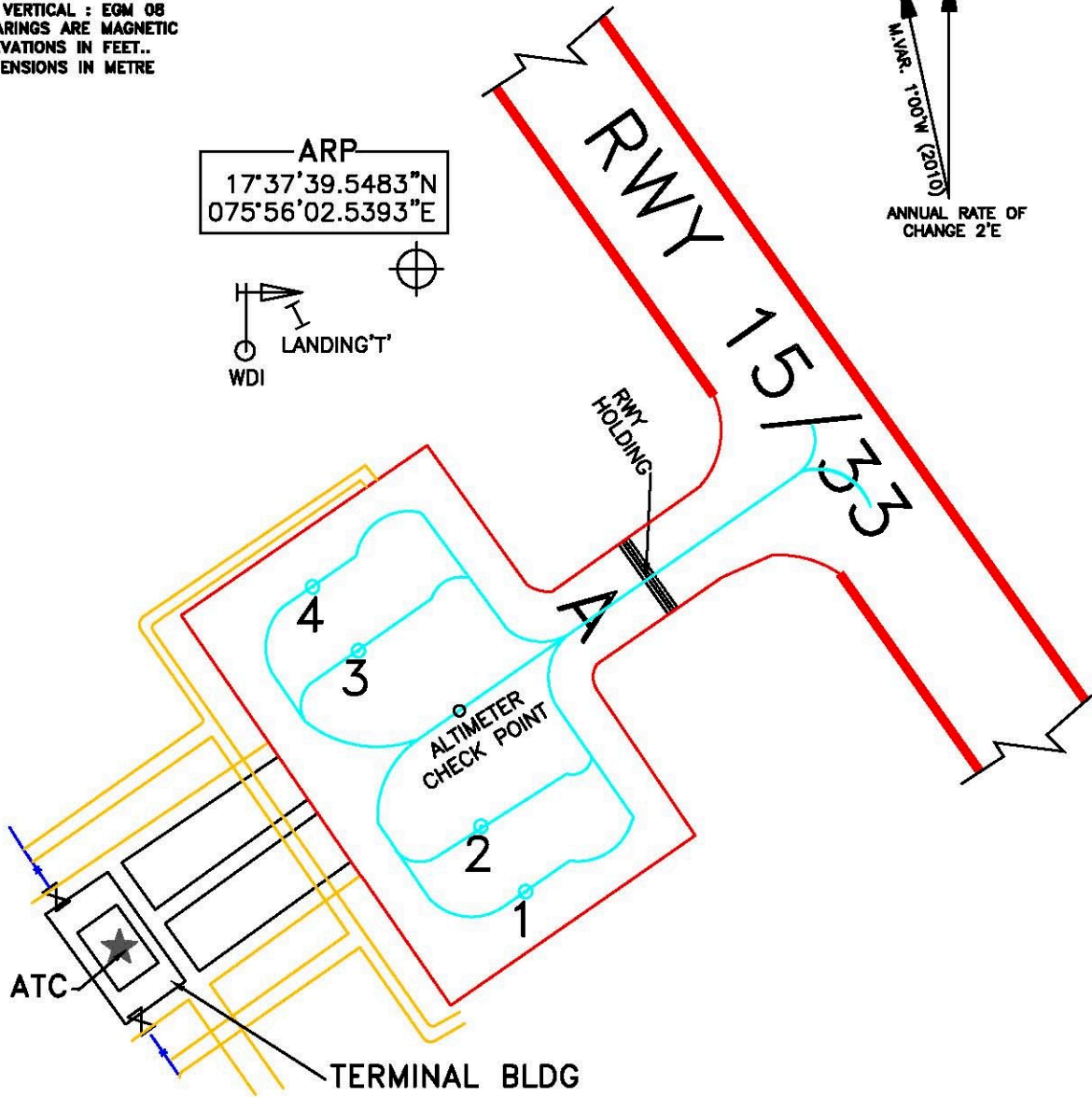
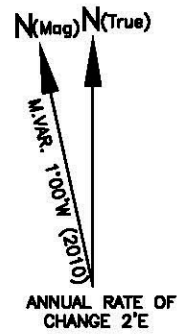
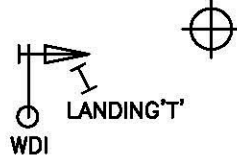

LEGEND	
AIRCRAFT STAND	②
TAXI-HOLDING POSITION	▬

TAXIWAYS		
TWY	PCN	WIDTH
A	19/F/B/W/T	23M

\* AERONAUTICAL GROUND LIGHTS ARE NOT SHOWN IN THIS CHART

BAY No.	WGS CO-ORDINATES FOR AIRCRAFT STANDS	PCN	SUITABILITY	STATUS OF AIRCRAFT STAND	ELEV.
1.	17°37'32.370"N 75°56'03.882"E	---	ATR-72	POWER IN POWER OUT	1581ft.
2.	17°37'33.118"N 75°56'03.283"E	---	ATR-72	POWER IN POWER OUT	1581ft.
3.	17°37'35.151"N 75°56'01.815"E	---	ATR-72	POWER IN POWER OUT	1581ft.
4.	17°37'35.898"N 75°56'01.273"E	---	ATR-72	POWER IN POWER OUT	1580ft.
ISOLATION BAY	17°37'17.590"N 75°56'24.014"E	---	ATR-72	POWER IN POWER OUT	1572ft.

DATE OF AERONAUTICAL INFORMATION  
MARCH 2023

DRG No.-AAI/07-PDC/2023  
UPDATED AS ON 22.07.2024

MAGNETIC VARIATION 1°W (2010)

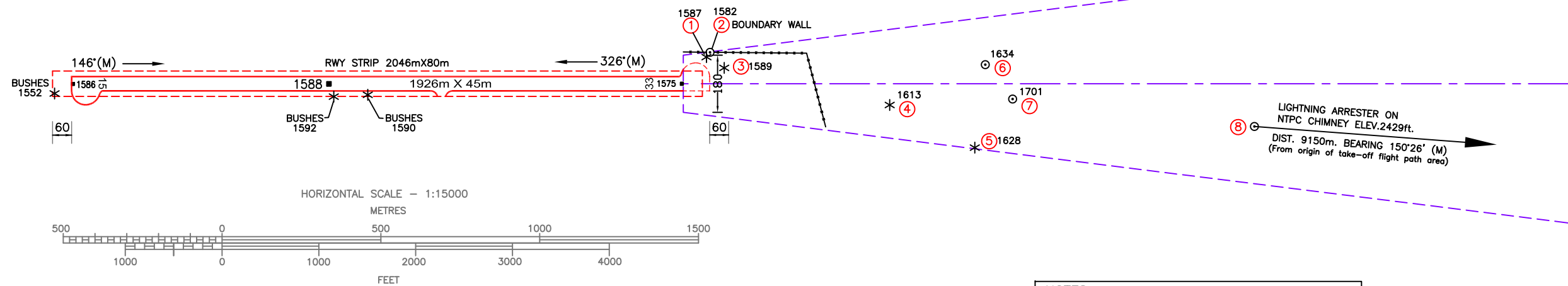
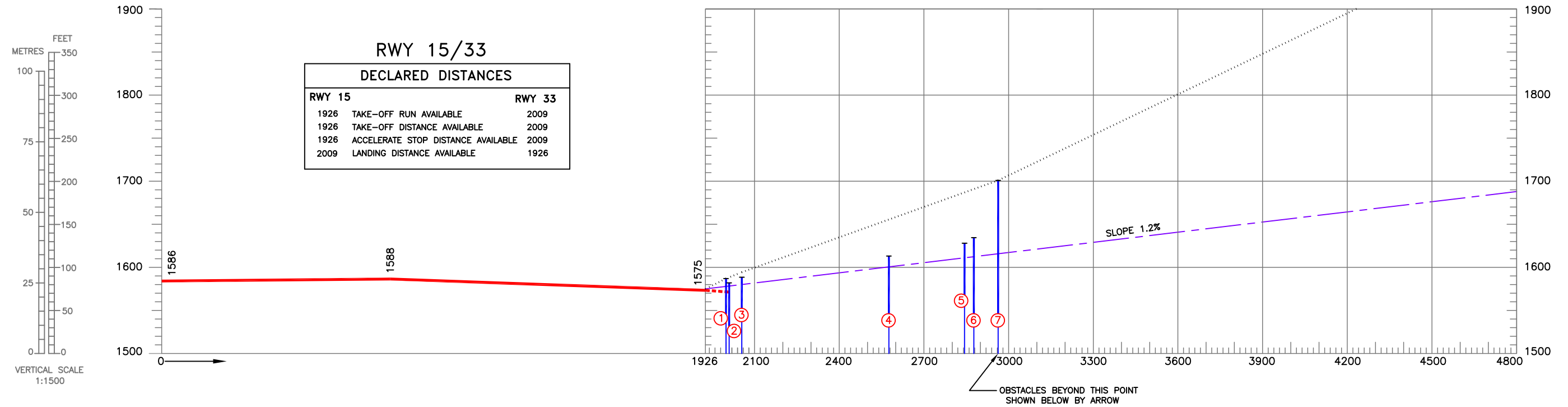

HORIZONTAL SCALE - 1:15000

ORDER OF ACCURACY

HORIZONTAL - 3.0m  
VERTICAL - 1ft.

S.NO.	UUID	OBJECT	ELEV. IN FEET
1	VASL_6043	BUSHES	1587
2	VASL_8016	AIRPORT BOUNDARY WALL WITH FENCING ON TOP	1582
3	VASL_6044	TREE	1589
4	VASL_6050	GROUP OF TREE	1613
5	VASL_6054	GROUP OF TREE	1628
6	VASL_7125	PYLON MAST	1634
7	VASL_9038	CHIMNEY (SSSSKL)	1701
8	VASL_9044	LIGHTNING ARRESTER ON NTPC CHIMNEY (CHIMNEY TOP 737.0M)	2429

NOTES:-

- The objects that have been shielded due to presence of other higher objects have not been shown in this chart.
- Datum - All Elevations are in EGM-08.
- Periphery road without traffic is no obstacle.
- Consult Notam for latest information.
- Rwy directions rounded to nearest degree.(Magnetic) (In degree minute : Rwy 15/33=145°59'/325°59')(2010) (In degree minute : Rwy 15/33=145°35'/325°35')(2022)
- Magnetic Variation rounded to nearest degree 1°00'W, Annual rate of change 02'E (2010).
- All obstacles shown in this chart are based on aeronautical obstacle Survey Nov. 2022.
- Chart prepared based on DGCA CAR section 9 AS & ATM Series 'G', Part-1.

AMENDMENT RECORD

NO.	DATE	REFERENCE

LEGEND		
	PLAN	PROFILE
IDENTIFICATION NUMBER	⑦	⑦
TREE OR SHRUB	*	⑦
POLE, CHIMNEY, ANTENNA, B.WALL ETC.	⊙	⑦
RWY ELEV. (SPOT)	1588■	⑦

MAGNETIC VARIATION 1°W (2010)

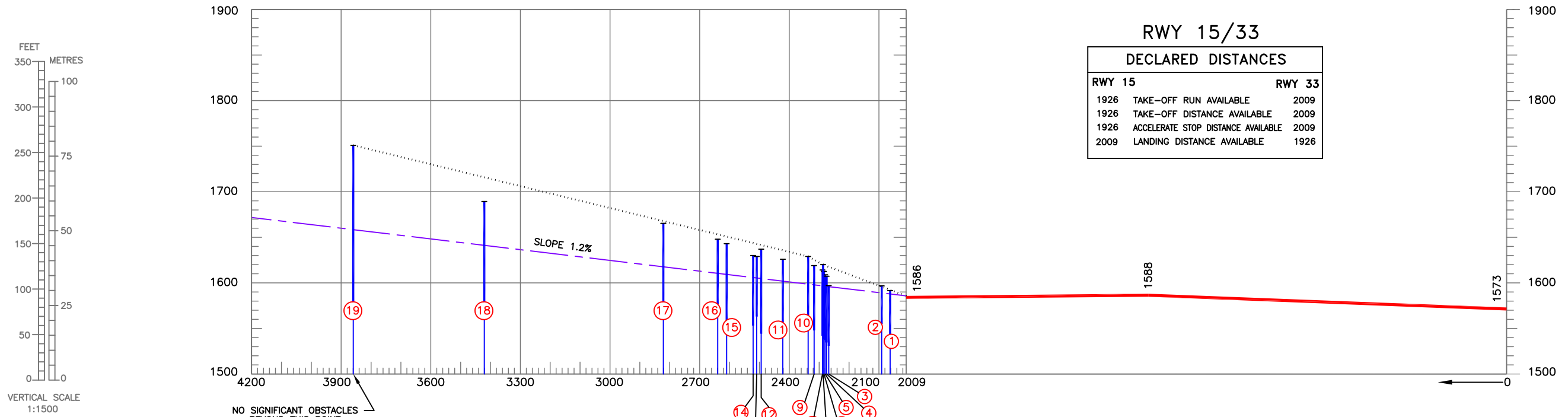

**RWY 15/33**

**DECLARED DISTANCES**

RWY 15	RWY 33
1926 TAKE-OFF RUN AVAILABLE	2009
1926 TAKE-OFF DISTANCE AVAILABLE	2009
1926 ACCELERATE STOP DISTANCE AVAILABLE	2009
2009 LANDING DISTANCE AVAILABLE	1926

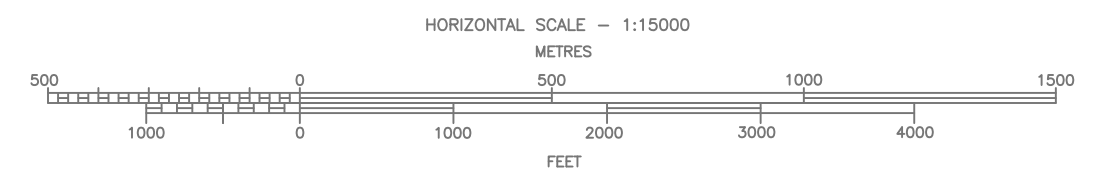
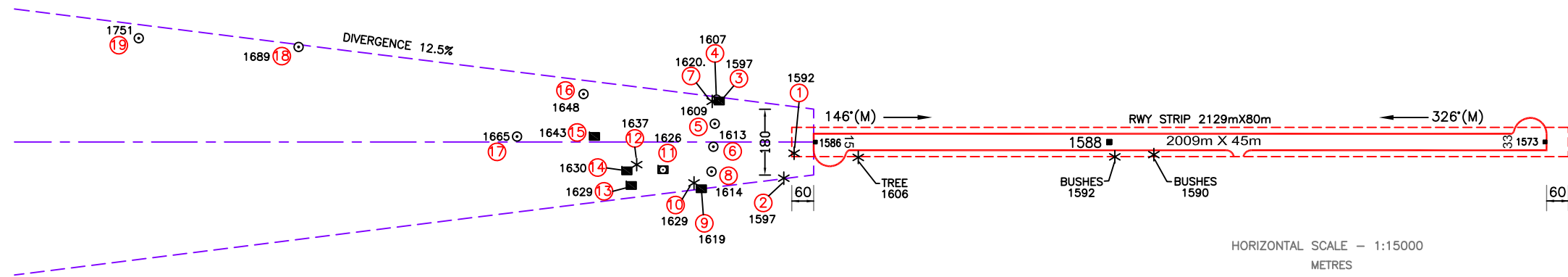

S.NO.	UUID	OBJECT	ELEV. FT.
1	VASL_6020	BUSHES	1592
2	VASL_6014	BUSHES	1597
3	VASL_5137	SECURITY HUT	1597
4	VASL_7071	ELECTRIC POLE	1607
5	VASL_7062	ELECTRIC POLE	1609
6	VASL_7059	ELECTRIC POLE	1613
7	VASL_6019	GROUP OF TREE	1620
8	VASL_7057	ELECTRIC POLE	1614
9	VASL_5093	BUILDING	1619
10	VASL_6007	GROUP OF TREE	1629
11	VASL_5092	SINTEX ON BUILDING (BUILDING TOP 494.8M)	1626
12	VASL_6003	GROUP OF TREE	1637
13	VASL_5077	BUILDING	1629
14	VASL_5081	BUILDING	1630
15	VASL_5221	MOSQUE	1643
16	VASL_7055	FLOOD LIGHT MAST	1648
17	VASL_7041	MAST	1665
18	VASL_9015	L/A ON BUILDING (BUILDING TOP 514.3M)	1689
19	VASL_7030	MAST	1751

**NOTES:-**

- The objects that have been shielded due to presence of other higher objects have not been shown in this chart.
- Datum - All Elevations are in EGM-08.
- Periphery road without traffic is no obstacle.
- Consult Notam for latest information.
- Rwy directions rounded to nearest degree.(Magnetic)  
(In degree minute : Rwy 15/33=145°59'/325°59')(2010)  
(In degree minute : Rwy 15/33=145°35'/325°35')(2022)
- Magnetic Variation rounded to nearest degree 1°00'W,  
Annual rate of change 02'E (2010).
- All obstacles shown in this chart are based on aeronautical obstacle Survey Nov. 2022.
- Chart prepared based on DGCA CAR section 9 AS & ATM Series 'G', Part-1.

**LEGEND**

	PLAN	PROFILE
IDENTIFICATION NUMBER	⑰	
TREE OR BUSHES	*	
POLE, CHIMNEY, MAST, ANTENNA ETC.	○	
BUILDING, STRUCTURE	■	
TANK ON BUILDING, STRUCTURE	▣	
RWY ELEV. (SPOT)	1588 ■	

**ORDER OF ACCURACY**  
HORIZONTAL - 3.0m  
VERTICAL - 1ft.

**AMENDMENT RECORD**

NO.	DATE	ENTERED BY

**AERODROME ELEVATION 1588FT.**

DISTANCE IN METRE.  
 ELEVATION IN FEET(EGM-08).  
 GRID LINES AND CO-ORDINATES SHOWN ARE BASED ON WGS-84 DATUM.  
 UTM ZONE-43N

# AERODROME OBSTACLE CHART

## TYPE - B

# SOLAPUR,INDIA SOLAPUR AIRPORT

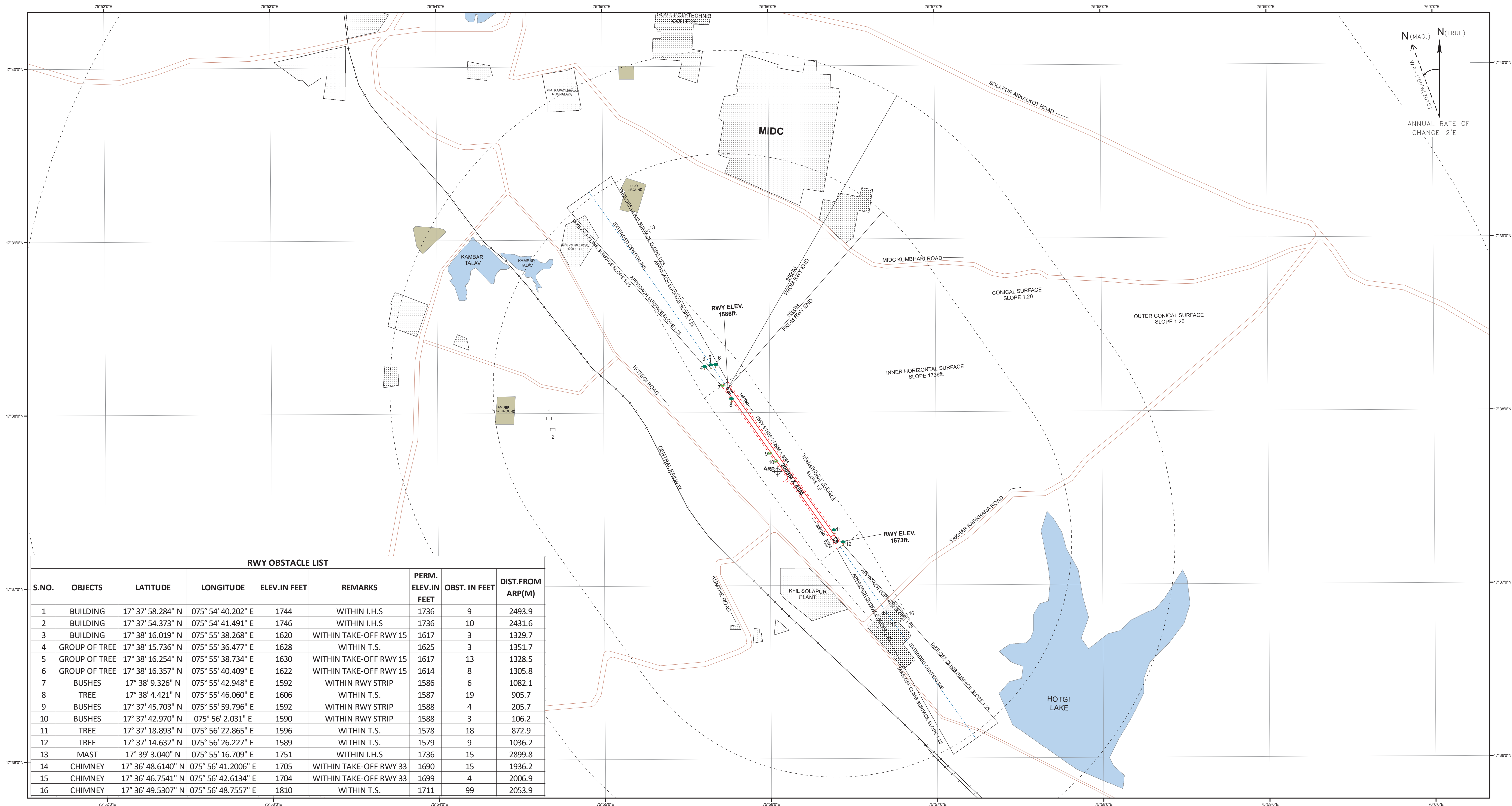

**RWY OBSTACLE LIST**

S.NO.	OBJECTS	LATITUDE	LONGITUDE	ELEV.IN FEET	REMARKS	PERM. ELEV.IN FEET	OBST. IN FEET	DIST.FROM ARP(M)
1	BUILDING	17° 37' 58.284" N	075° 54' 40.202" E	1744	WITHIN I.H.S	1736	9	2493.9
2	BUILDING	17° 37' 54.373" N	075° 54' 41.491" E	1746	WITHIN I.H.S	1736	10	2431.6
3	BUILDING	17° 38' 16.019" N	075° 55' 38.268" E	1620	WITHIN TAKE-OFF RWY 15	1617	3	1329.7
4	GROUP OF TREE	17° 38' 15.736" N	075° 55' 36.477" E	1628	WITHIN T.S.	1625	3	1351.7
5	GROUP OF TREE	17° 38' 16.254" N	075° 55' 38.734" E	1630	WITHIN TAKE-OFF RWY 15	1617	13	1328.5
6	GROUP OF TREE	17° 38' 16.357" N	075° 55' 40.409" E	1622	WITHIN TAKE-OFF RWY 15	1614	8	1305.8
7	BUSHES	17° 38' 9.326" N	075° 55' 42.948" E	1592	WITHIN RWY STRIP	1586	6	1082.1
8	TREE	17° 38' 4.421" N	075° 55' 46.060" E	1606	WITHIN T.S.	1587	19	905.7
9	BUSHES	17° 37' 45.703" N	075° 55' 59.796" E	1592	WITHIN RWY STRIP	1588	4	205.7
10	BUSHES	17° 37' 42.970" N	075° 56' 2.031" E	1590	WITHIN RWY STRIP	1588	3	106.2
11	TREE	17° 37' 18.893" N	075° 56' 22.865" E	1596	WITHIN T.S.	1578	18	872.9
12	TREE	17° 37' 14.632" N	075° 56' 26.227" E	1589	WITHIN T.S.	1579	9	1036.2
13	MAST	17° 39' 3.040" N	075° 55' 16.709" E	1751	WITHIN I.H.S	1736	15	2899.8
14	CHIMNEY	17° 36' 48.6140" N	075° 56' 41.2006" E	1705	WITHIN TAKE-OFF RWY 33	1690	15	1936.2
15	CHIMNEY	17° 36' 46.7541" N	075° 56' 42.6134" E	1704	WITHIN TAKE-OFF RWY 33	1699	4	2006.9
16	CHIMNEY	17° 36' 49.5307" N	075° 56' 48.7557" E	1810	WITHIN T.S.	1711	99	2053.9

**LEGEND**

AERODROME REFERENCE POINT 17°37'39.5483"N 075°56'02.5393"E	
RAILWAY TRACK	
ROADS	
WATERBODIES	
BUILD-UP AREA	
PARKS	

**ORDER OF ACCURACY**

TAKE-OFF AND APPROACH AREAS	
HORIZONTAL	5M AT POINT OF ORIGIN INCREASING AT A RATE OF 1 PER 500.
VERTICAL	0.5M IN THE FIRST 500M AND INCREASING AT A RATE OF 1 PER 1000.
OTHER AREAS	
HORIZONTAL	5M WITHIN 5000M OF THE ARP AND 12M BEYOND THAT AREA.
VERTICAL	1M WITHIN 1500M OF THE ARP INCREASING AT A RATE OF 1 PER 1000.

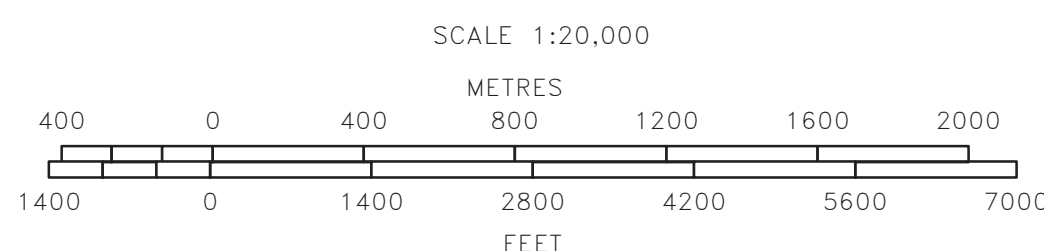

NOTE :

- OBSTACLES SHOWN ARE THOSE WHICH PENETRATE THE SURFACES SPECIFIED IN ANNEX 14, VOL-1, CHAPTER-4 & GSR.
- TORA FOR RWY 15 IS 1926M.
- TORA FOR RWY33 IS 2009M.
- TO BRING OUT THE CLARITY IN THE OBSTACLES DEPICTED IN THE APPROACH AND TAKE-OFF SURFACE, ONLY HIGHER OBSTACLES HAVE BEEN SHOWN FROM GROUP OF OBSTACLES.
- ALL OBSTACLES ARE SHOWN IN THE CHART BASED ON AERONAUTICAL SURVEY NOV. 2022.
- TOPOGRAPHICAL FEATURES SOURCE - WORLD TOPO MAP, ESRI.

AMENDMENT RECORD		
NO.	DATE	ENTERED BY