

TEL: +91-11-24632950 Extn: 2219/2233 AFS: VIDDYXAX FAX: +91-11-24615508 Email: gmais@aai.aero	INDIA AERONAUTICAL INFORMATION SERVICE AIRPORTS AUTHORITY OF INDIA RAJIV GANDHI BHAVAN SAFDARJUNG AIRPORT NEW DELHI – 110003	161/2025
		21 AUG 2025

File No. ATM-19013(19)/1/2025-ATM

Following supplement is issued for information, guidance and necessary action.

sd/-
विपिन कुमार
VIPIN KUMAR
अध्यक्ष/CHAIRMAN
भारतीय विमानपत्तन प्राधिकरण
AIRPORTS AUTHORITY OF INDIA

[EFFECTIVE DATE: 02 OCT 2025]

AERODROME DATA
CHITRAKOOT AIRPORT, CHITRAKOOT (VECT)

AD 2. AERODROMES

VECT AD 2.1 AERODROME LOCATION INDICATOR AND NAME

VECT – CHITRAKOOT / DOMESTIC

VECT AD 2.2 AERODROME GEOGRAPHICAL AND ADMINISTRATIVE DATA

1	Aerodrome reference point coordinates and its site	250929.00N 0805527.00E 222.86 DEG/ 983 M from physical extremity of RWY 06
2	Direction and distance of aerodrome reference point from the centre of the city or town which the aerodrome serves	6 km South-Southeast of Chittrakoot Dham Karwi Railway station.
3	Aerodrome elevation and reference temperature	983 ft/ 37.7 DEG C
4	Magnetic, date of information and annual change	0.25 DEG W/0.01667 DEG E As per Epoch chart 2010 (SOI)
5	Name of aerodrome operator, address, telephone, telefax, e-mail address, AFS address, website (if available)	Airports Authority of India Chittrakoot Dham Karwi, Sidhhpur, Devangna Hills, Chittrakoot (Uttar Pradesh)

		Tel	+91-5198-298726
		Email	apdchitrakoot@aai.aero
6	Types of traffic permitted (IFR/VFR)	VFR	
7	Remarks	Geoid Model: EGM 08	

VECT AD 2.3 OPERATIONAL HOURS

1	Aerodrome Operator	MON – FRI: 0400 to 1230 UTC (0930-1800 IST) SAT, SUN, HOL: NIL
2	Custom and immigration	Not Applicable
3	Health and sanitation	As ATS
4	AIS Briefing office	As ATS
5	ATS Reporting Office (ARO)	AS ATS
6	MET Briefing office	As ATS
7	Air Traffic Service	Refer NOTAM
8	Fuelling	As ATS
9	Handling	As ATS
10	Security	H24
11	De-icing	Not applicable
12	Remarks	NIL

VECT AD 2.4 HANDLING SERVICES AND FACILITIES

1	Cargo-handling facilities	NIL
2	Fuel and oil types	JET A1 available on demand
3	Fuelling facilities and capacity	01 Bowsers 15KL
4	De-icing facilities	NIL
5	Hanger space for visiting aircraft	NIL
6	Repair facilities for visiting aircraft	NIL
7	Remarks	Mooring Facility- Nil

VECT AD 2.5 PASSENGER FACILITIES

1	Hotel(s) at or in the vicinity of aerodromes	Available in the City
2	Restaurant(s) at or in the vicinity of aerodromes	Available in the City
3	Transportation possibilities	Taxi Available
4	Medical Facilities	First Aid in the terminal building and District Hospital located in City about 06 kms from the airport.
5	Bank and post office at or in the vicinity of aerodromes	Available in the City
6	Tourist office	Available in the City
7	Remarks	NIL

VECT AD 2.6 RESCUE AND FIRE FIGHTING SERVICES

1	Aerodrome category for fire fighting	CAT - IV
2	Rescue equipment	AVAILABLE
3	Capability for removal of disabled aircraft	<ol style="list-style-type: none">1. The Critical aircraft for the airport is B1900D.2. Primary responsibility for removal of disabled aircraft rests with concerned airline.3. The airlines may contact 'Aerodrome coordinator for Disabled Aircraft Removal operations' for co-coordinating with the agencies having Disabled Aircraft Recovery Kit.4. Contact Details of Aerodrome Coordinator for Disabled Aircraft Removal operation: Airport Director Chitrakoot Airport, Contact No.- +91-5198-298726 Email id. apdchitrakoot@aai.aero
4	Remarks	NIL

VECT AD 2.7 SEASONAL AVAILABILITY CLEARING

1	Type(s) of clearing equipment	NIL
2	Clearance priorities	NIL
3	Remarks	NIL

VECT AD 2.8 APRONS, TAXIWAYS AND CHECK LOCATIONS/POSITIONS DATA

1	Designation, surface and strength of aprons	Refer Aircraft Parking/ Docking Chart
2	Designation, width, surface and strength of taxiways	Refer Aircraft Parking/ Docking Chart
3	Location and elevation of altimeter checkpoints	NIL
4	Location of VOR checkpoints	NIL
5	Position of INS checkpoints	NIL
6	Remarks	NIL

VECT AD 2.9 SURFACE MOVEMENT GUIDANCE AND CONTROL SYSTEM AND MARKINGS

1	Use of aircraft stand identification signs, taxiway guidelines and visual docking/parking guidance system at aircraft stands	Taxing guidance signs at all intersections with TWY and RWY and at all holding position, Guidelines at apron. Taxiing guidance provided on R/T also.		
2	Runway and taxiway markings and lights	RWY	Markings	Runway designator, Threshold markings, Aiming point, Centre line, touchdown zone, runway side strip markings, turn pad markings
			Lights	NIL
		TWY	Marking	Taxiway side strip markings, centreline markings, RWY holding position markings
			Lights	NIL
3	Stop bars (if any)	NIL		
4	Remarks	PAPI lights are available at both ends.		

VECT AD 2.10 AERODORME OBSTACLES

RWY/AREA AFFECTED	OBSTACLE TYPE	CO-ORDINATES	ELEV. IN FT. (EGM 08)	MARKING/ LGT	REMARKS
1	2	3	4	5	6
06/APCH 24/TKOF	TREE	250950.89N 0805545.15E	1 006	NIL	Group of Trees
24/APCH 06/TKOF	TREE	251021.97N 0805636.64E	994	NIL	Group of Trees
24/APCH 06/TKOF	TREE	251021.93N 0805635.99E	995	NIL	Group of Trees
In Circling Area and at AD	TREE	251002.15N 0805610.48E	1 009	NIL	Tree
In Circling Area and at AD	TREE	251000.72N 0805608.27E	1 002	NIL	Tree
In Circling Area and at AD	TREE	251000.02N 0805607.22E	1 001	NIL	Tree
In Circling Area and at AD	TREE	250959.59N 0805606.18E	999	NIL	Tree
In Circling Area and at AD	TREE	250958.88N 0805557.65E	995	NIL	Group of Trees
In Circling Area and at AD	TREE	250958.82N 0805558.20E	991	NIL	Group of Trees
In Circling Area and at AD	TREE	251000.75N 0805601.20E	990	NIL	Tree
In Circling Area and at AD	TREE	251001.13N 0805601.72E	990	NIL	Tree
In Circling Area and at AD	TREE	250956.99N 0805553.70E	999	NIL	Group of Trees
In Circling Area and at AD	FENCE	250950.98N 0805552.22E	987	NIL	Airport Boundary Wall with Fencing on Top
In Circling Area and at AD	TREE	251004.90N 0805614.97E	1 007	NIL	Group of Trees
In Circling Area and at AD	TREE	251005.54N 0805615.94E	1 002	NIL	Group of Trees
In Circling Area and at AD	TREE	251010.57N 0805615.46E	1 003	NIL	Group of Trees
In Circling Area and at AD	TREE	251006.35N 0805617.09E	1 001	NIL	Group of Trees
In Circling Area and at AD	TREE	251007.14N 0805618.39E	1001	NIL	Group of Trees
In Circling Area and at AD	TREE	251008.03N 0805620.07E	1 003	NIL	Tree

RWY/AREA AFFECTED	OBSTACLE TYPE	CO-ORDINATES	ELEV. IN FT. (EGM 08)	MARKING/ LGT	REMARKS
In Circling Area and at AD	TREE	251008.10N 0805620.03E	1 002	NIL	Tree
In Circling Area and at AD	TREE	251008.92N 0805621.24E	1 002	NIL	Tree
In Circling Area and at AD	POLE	250950.96N 0805544.94E	999	NIL	Electric Pole
In Circling Area and at AD	TREE	250954.48N 0805550.14E	999	NIL	Tree
In Circling Area and at AD	TREE	250956.11N 0805552.02E	1 005	NIL	Group of Trees
In Circling Area and at AD	TREE	251002.16N 0805610.43E	1 010	NIL	Tree
In Circling Area and at AD	TREE	251002.90N 0805604.15E	991	NIL	Tree
In Circling Area and at AD	TREE	251004.87N 0805614.91E	1 008	NIL	Group of Trees
In Circling Area and at AD	OTHER	251005.92N 0805609.52E	1 002	LGT	WDI
In Circling Area and at AD	OTHER	251006.06N 0805608.83E	1 004	NIL	Machine Top
In Circling Area and at AD	TREE	251011.89N 0805617.26E	1 007	NIL	Tree
In Circling Area and at AD	OTHER	251021.80N 0805634.30E	996	NIL	Security Hut

VECT AD 2.11 METEOROLOGICAL INFORMATION PROVIDED

1	Name of the associated meteorological office	Chitrakoot (CLASS-3)
2	Hours of service and, where applicable, the designation of the responsible meteorological office outside these hours	During watch hours.
3	Office responsible for preparation of TAFs and periods of validity and interval of issuance of the forecasts	Lucknow, 9 hrs
4	Availability of the trend forecast for the aerodrome and interval of issuance	NIL
5	Information on how briefing and/or consultation is provided	NIL
6	Types of flight documentation supplied and language(s) used in flight documentation	Tabular from English

7	Charts and other information displayed or available for briefing or consultation	NIL
8	Supplementary equipment available for providing information on meteorological conditions, e.g. weather radar and receiver for satellite images;	Telephone
9	The air traffic services unit(s) provided with meteorological information	Chitrakoot ATC and ACS
10	Additional information, e.g. concerning any limitation of service.	Documentation provided as requested

VECT AD 2.12 RUNWAY PHYSICAL CHARACTERISTICS

Designations	True Bearings	Dimensions of RWY (M)	Strength of pavement (PCN) and associated data) and surface of runway and associated stopways	Geographical coordinates for threshold and runway end
1	2	3	4	5
06	55.61 DEG	1 398 x 23	17/F/B/X/T ASPHALT	THR: 250953.26N 0805552.07E RWY END: 251018.15N 0805632.05E
24	235.61 DEG	1 398 x 23	17/F/B/X/T ASPHALT	THR: 251017.16N 0805630.46E RWY END: 250952.49N 0805550.84E
THR elevation and highest elevation of TDZ of precision APP RWY	Slope of runway and associated stopway	Dimensions of stopway (M)	Dimensions of clearway (M)	Dimensions of strips (M)
6	7	8	9	10
THR: 978 ft TDZ: 981 ft	0.19%	NIL	NIL	1 518 X 80 m
THR: 979 ft TDZ: 982 ft	0.22%	NIL	NIL	1 518 X 80 m
Dimensions of runway end safety areas	Location and description of arresting system (if any)	Existence of an obstacle-free zone	Remarks.	
11	12	13	14	
30M x 46 m	NIL	NIL	Vertical Datum: EGM 08	
30M x 46 m	NIL	NIL	Vertical Datum: EGM 08	

VECT AD 2.13 DECLARED DISTANCES

RWY Designator	TORA (M)	TODA (M)	ASDA (M)	LDA (M)	Remarks (including runway entry or start point where alternative reduced declared distances have been declared)
1	2	3	4	5	6
06	1 398	1 398	1 398	1 356	THR displaced by 42 m
24	1 398	1 398	1 398	1 344	THR displaced by 54 m

VECT AD 2.14 APPROACH AND RUNWAY LIGHTING

Runway Designator	Type, length and intensity of approach lighting system	Runway threshold lights, colour and wing bars	Type of visual slope indicator system	Length of runway touchdown zone lights
1	2	3	4	5
06	NIL	NIL	PAPI/LEFT MEHT: 12.20 m	NIL
24	NIL	NIL	PAPI/LEFT MEHT: 12.20 m	NIL
Length, spacing, colour and intensity of runway centre line lights	Length, spacing, colour and intensity of runway edge lights	Colour of runway end lights and wing bars	Length and colour of stop way lights	Remarks
6	7	8	9	10
NIL	NIL	NIL	NIL	NIL
NIL	NIL	NIL	NIL	NIL

VECT AD 2.15 OTHER LIGHTING, SECONDARY POWER SUPPLY

1	Location, characteristics and hours of operation of aerodrome beacon/identification beacon (if any)	ABN	Installed on top of ATC Tower. Green and White flashes
		IBN	Available
2	Location and lighting (if any) of anemometer/landing direction indicator;	LDI	Available
		Anemometer	Not Available
3	Taxiway edge and taxiway centre line lights;	Edge	Not Available
		Centre line	Not Available
4	Secondary power supply including switch-over time;	Sub-station –I: 2 DG Sets of 250KVA each (Working), switch-over time- 15 Sec	
5	Remarks	NIL	

VECT AD 2.16 HELICOPTER LANDING AREA

1	Geographical coordinates of the geometric centre of touchdown and lift-off (TLOF) or of each threshold of final approach and take-off (FATO) area	Not Established
2	TLOF and/or FATO area elevation:	Not Established
3	TLOF and FATO area dimensions to the nearest metre or foot, surface type, bearing strength and marking;	Not Established
4	True bearings of FATO;	Not Established
5	Declared distances available,	Not Established
6	Approach and FATO lighting;	Not Established
7	Remarks	Not Established

VECT AD 2.17 AIR TRAFFIC SERVICES AIRSPACE

1	Airspace designation, geographical coordinates and lateral limits	CTR: Circular area centred on 250929N 0805527E within a 10 NM radius.
2	Vertical limits	FL 55
3	Airspace classification	Class D
4	Call sign and language(s) of the air traffic services unit providing service;	English
5	Transition altitude	4000 ft
6.	Hours of applicability	HO
7.	Remarks	1. CTR available only during notified operational hours of Chitrakoot. 2. Beyond operational hours the airspace classification is Class G.

VECT AD 2.18 AIR TRAFFIC SERVICES COMMUNICATION FACILITIES

Service Designation	Call sign	Channel(s)	SATVOICE Number(s), if available
1	2	3	4
TWR	Chitrakoot TWR	118.500 MHz	NIL
TWR	Chitrakoot TWR	122.250 MHz	NIL

Logon address, as appropriate	Hours of operation	Remarks
5	6	7
NIL	HO	1. Main Frequency 2. Functions of Approach combined with Tower
NIL	HO	1. Backup Frequency

VECT AD 2.19 RADIO NAVIGATION AND LANDING AIDS

Type of aids, magnetic and type of supported operation for ILS/MLS, basic GNSS, SBAS and GBAS, and for VOR/ILS/MLS station used for technical line-up of the aid	Identification	Frequency(ies), Channel number(s), Service provider, and reference path identifier(s) (RPI), as appropriate	Hours of operation, as appropriate
1	2	3	4
NIL	NIL	NIL	NIL
Geographical coordinates of the position of the transmitting antenna	Elevation of transmitting antenna of DME/ elevation of GBAS reference point	Service volume radius from the GBAS reference point	Remarks
5	6	7	8
NIL	NIL	NIL	NIL

VECT AD 2.20 LOCAL AERODROME REGULATIONS:

NIL

VECT AD 2.21 NOISE ABATEMENT PROCEDURES:

NIL

VECT AD 2.22 FLIGHT PROCEDURES:

NIL

VECT AD 2.23 ADDITIONAL INFORMATION:

NIL

VECT AD 2.24 CHARTS RELATED TO AN AERODROME

1. Aerodrome Chart
2. Aircraft Parking / Docking Chart
3. Aerodrome Obstacle Chart - Type A (Obstacle Limitations) RWY 06
4. Aerodrome Obstacle Chart - Type A (Obstacle Limitations) RWY 24
5. Aerodrome Obstacle Chart Type B

CANCELLATION:

1. **Cancel** NOTAM G0959/23, VIDPYNXX
2. **Cancel** NOTAM G0284/23, VIDPYNXX

AERODROME CHART

25°09'29.00"N
080°55'27.00"E

AD.ELEV.983ft.

TWR 118.50
BACK-UP 122.25

CHITRAKOOT, INDIA
CHITRAKOOT AIRPORT

RWY	DIRECTION	THR. COORDINATES	THR.ELEV. IN FT.	BEARING STRENGTH
06	056°	25°09'53.26" N 80°55'52.07" E	978	17/F/B/X/T
24	236°	25°10'17.16" N 80°56'30.46" E	979	

- DATUM : HORIZONTAL-WGS - 84;
VERTICAL- EGM-08.
- BEARINGS ARE MAGNETIC.
- DIMENSION IN METRE.
- ELEVATION IN FEET.
- TWY 15m. Wide.

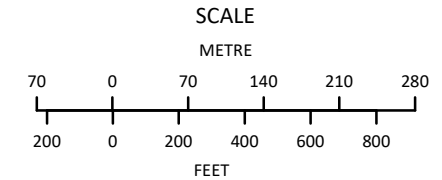
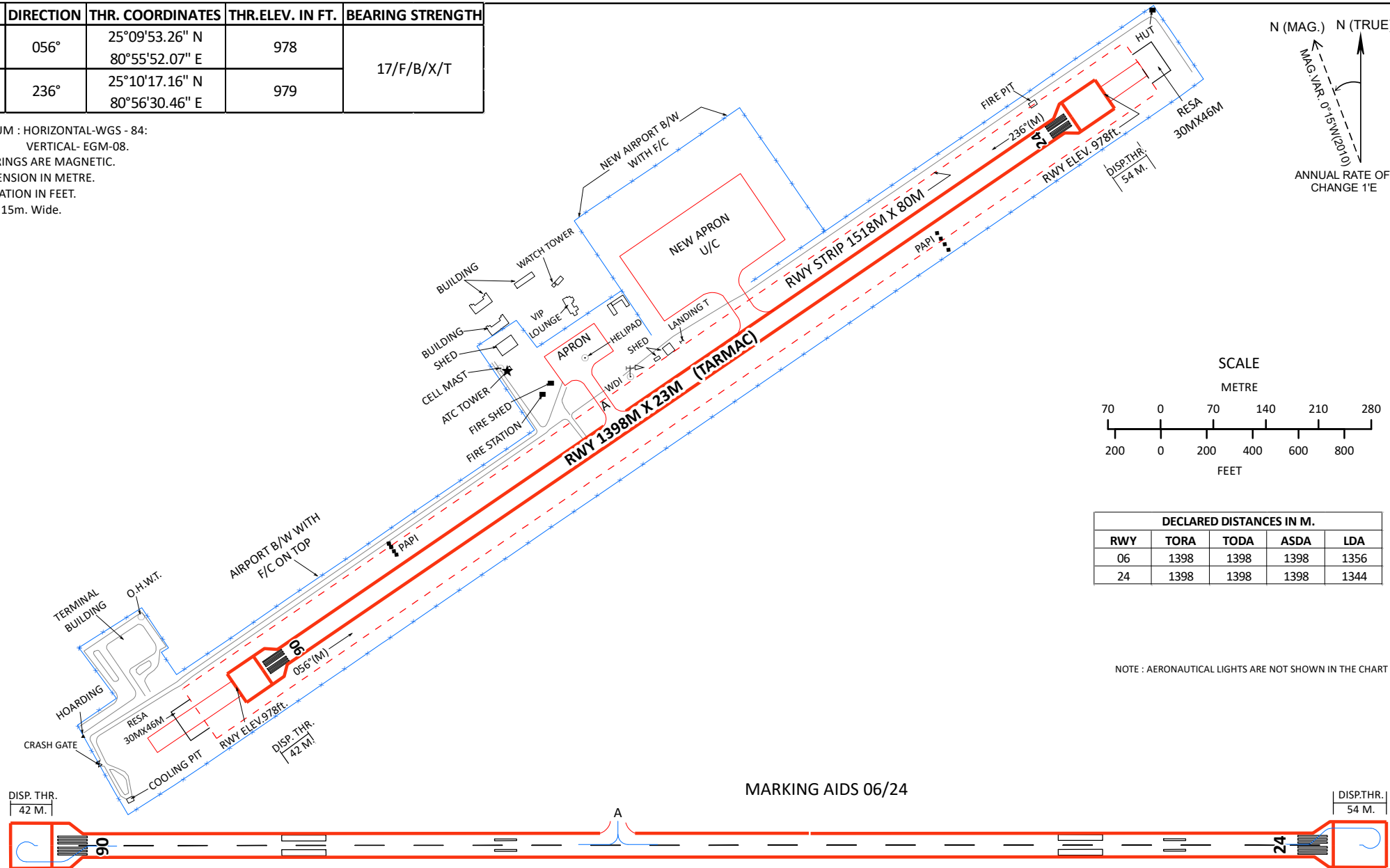

DECLARED DISTANCES IN M.				
RWY	TORA	TODA	ASDA	LDA
06	1398	1398	1398	1356
24	1398	1398	1398	1344

NOTE : AERONAUTICAL LIGHTS ARE NOT SHOWN IN THE CHART

DATE OF AERONAUTICAL INFORMATION
JUNE 2023

DRG.NO.AAI - 23/AC/2023(CARTO)

(UPDATED ON 20.06.2024)

**AIRCRAFT PARKING/
DOCKING CHART**

APRON ELEV.979ft.

**TWR 118.50
BACK-UP 122.25**

**CHITRAKOOT, INDIA
CHITRAKOOT AIRPORT**

- DATUM : HORIZONTAL-WGS - 84:
VERTICAL- EGM-08.
- BEARINGS ARE MAGNETIC.
- DIMENSION IN METRE.
- ELEVATION IN FEET.

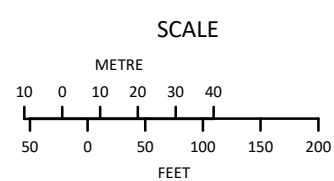
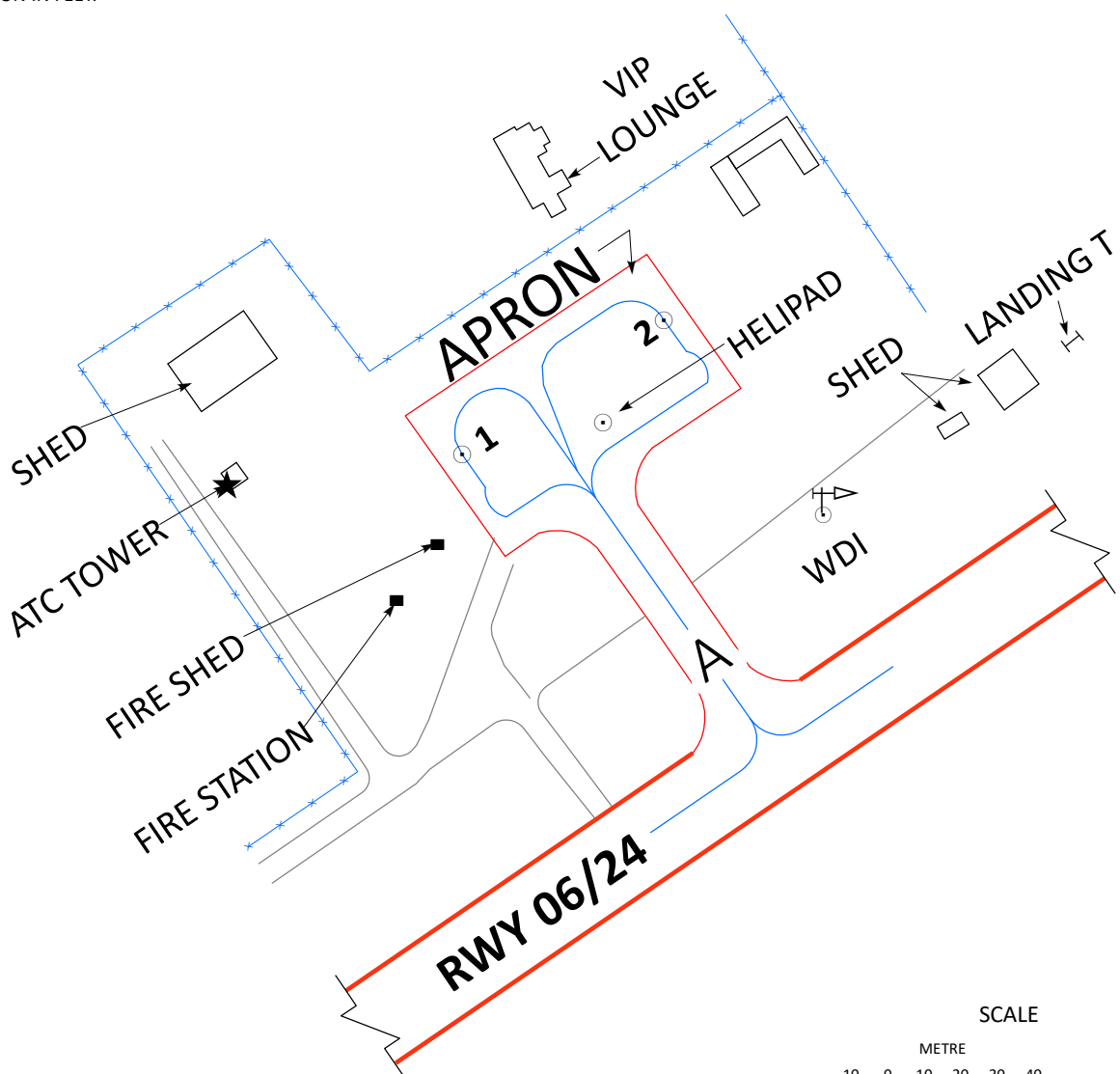
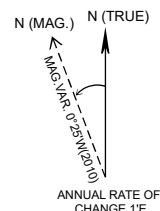

LEGEND	
AIRCRAFT STAND	⊙2

STAND NO.	WGS CO-ORDINATES FOR AIRCRAFT STANDS	ELEV.IN FEET	SUITABILITY	PCN	STATUS
1	25°10'07.66792"N 080°56'07.96023"E	978	-	19/F/B/X/T	POWER IN/POWER OUT
2	25°10'06.46834"N 080°56'05.98566"E	978	-	19/F/B/X/T	POWER IN/POWER OUT

TWY	PCN	WIDTH
A	19/F/B/X/T	15M.

STAND NO.	WGS CO-ORDINATES FOR AIRCRAFT STANDS	ELEV.IN FEET
HELICOPTER PARKING POINT	25°10'06.75646"N 080°56'07.36811"E	979

DATE OF AERONAUTICAL INFORMATION
JUNE 2023

DRG.NO.AAI - 24/PDC/2023(CARTO)

(UPDATED ON 20.06.2024)

ELEVATIONS IN FEET AND EGM-08
ALL OTHER DIMENSIONS IN METRES

AERODROME OBSTACLE CHART

TYPE -A (OPERATING LIMITATIONS)

INDIA/CHITRAKOOT
CHITRAKOOT AIRPORT/RWY 06

MAGNETIC VARIATION 0°, (2010)

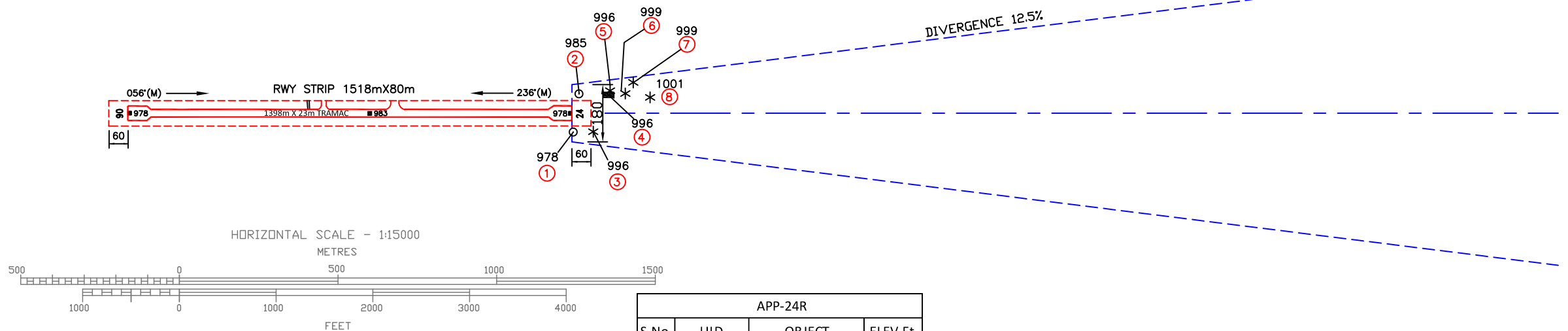
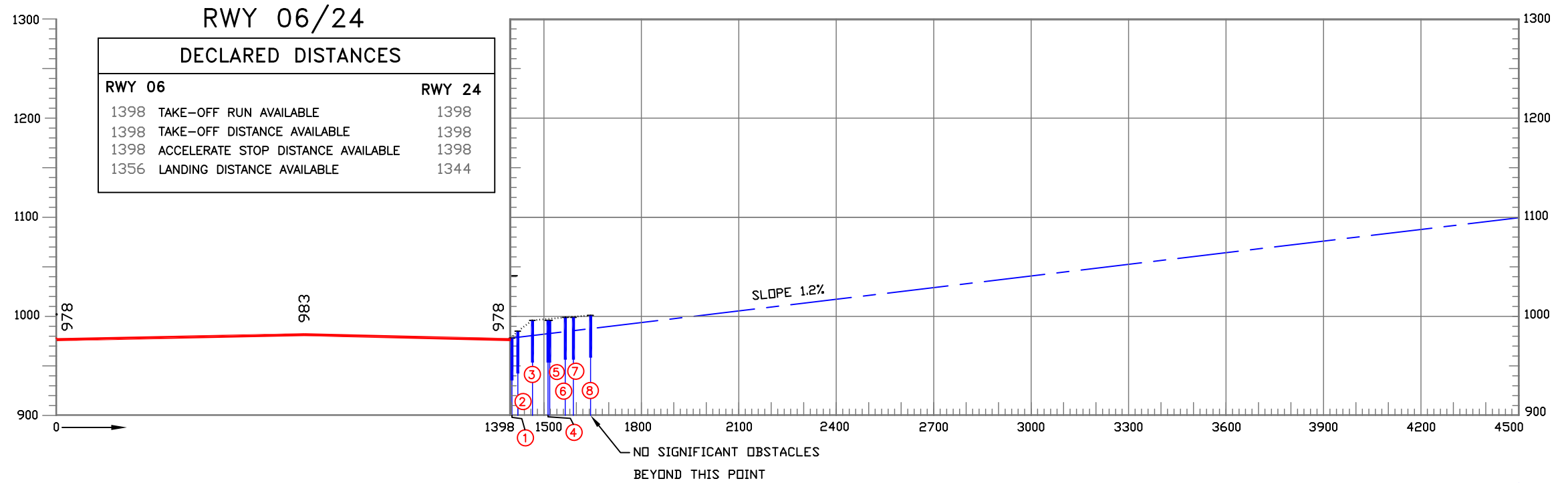
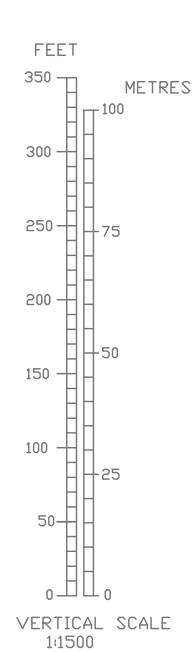

LEGEND		
	PLAN	PROFILE
RWY.ELEV.(SPOT)	■ 983	—
IDENTIFICATION NUMBER	①	①
POLE, TOWER, SPIRE, ANTENNA ETC..	○	○
BUILDING OR HUT	■	■
TREE	*	*

ORDER OF ACCURACY
HORIZONTAL - 3.0m
VERTICAL - 1ft.

APP-24R			
S.No.	UID	OBJECT	ELEV Ft.
1P	VECT_8030	ARPT BNDRY WALL WITH FENC	978
2P	VECT_8008	ARPT BNDRY WALL WITH FENC	985
3T	VECT_6345	TREE	996
4P	VECT_5031	SECURITY HUT	996
5T	VECT_6020	GROUP OF TREES	996
5T	VECT_6262	GROUP OF TREES	999
7T	VECT_6115	GROUP OF TREES	999
8T	VECT_6117	GROUP OF TREES	1001

NOTES:-

- The objects that have been shielded due to presence of other higher objects have not been shown in this chart.
- Datum - All Elevations are in EGM-08.
- Periphery road without traffic is no obstacle.
- Consult Notam for latest information.
- Rwy directions rounded to nearest degree.(Magnetic)
(In degree minute : Rwy 06/24 =055°52'/235°52')(2010)
(In degree minute : Rwy 06/24 =055°39'/235°39')(2023)
- Magnetic variation rounded to nearest degree 0.15°E,
Annual rate of change 01'E(2010).
- All obstacles shown in this chart are based on aeronautical obstacle Survey Oct..-2022.
- Chart prepared based on DGCA CAR Section 9AS & ATM series 'G' Part-1.

AMENDMENT RECORD		
No	Date	DESCRIPTION

AERONAUTICAL INFORMATION UPTO APRIL 2023
वैमानिक सूचना : अप्रैल 2023 तक

COMPILED BY- CARTO, AIRPORTS AUTHORITY OF INDIA
संग्रहित किया : कार्टो, भारतीय विमानपत्तन प्राधिकरण

CHART No.AAI/25-OBS/CARTO/2023
चार्ट सं. भा.वि.प्रा./25-अव/कार्टो/2023

MAGNETIC VARIATION 0°,(2010)

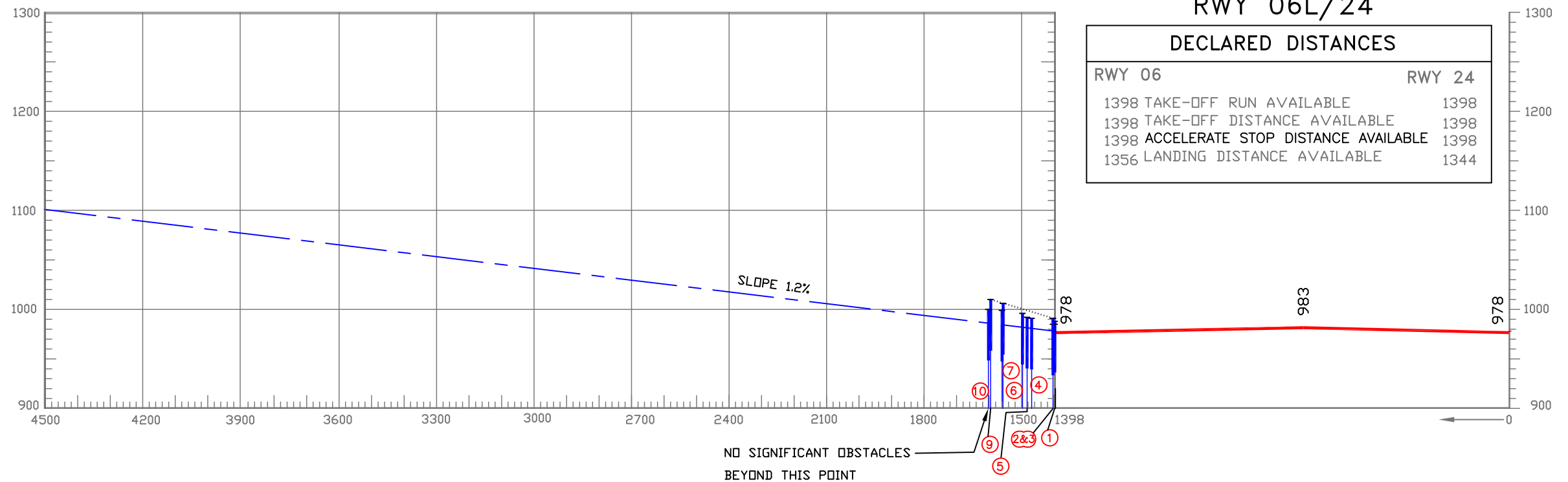
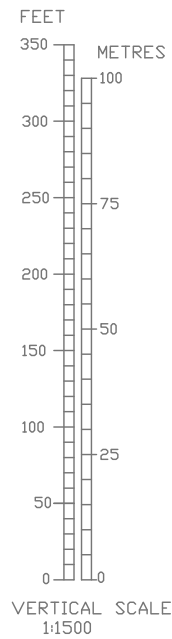

RWY 06L/24	
DECLARED DISTANCES	
RWY 06	RWY 24
1398 TAKE-OFF RUN AVAILABLE	1398
1398 TAKE-OFF DISTANCE AVAILABLE	1398
1398 ACCELERATE STOP DISTANCE AVAILABLE	1398
1356 LANDING DISTANCE AVAILABLE	1344

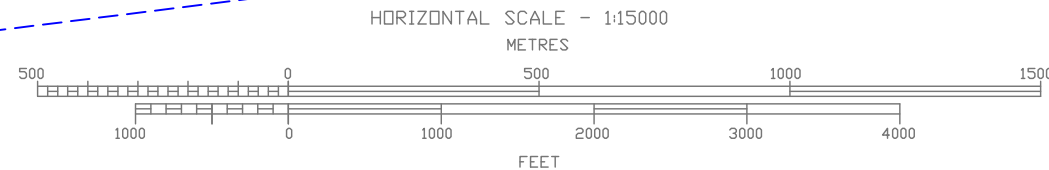
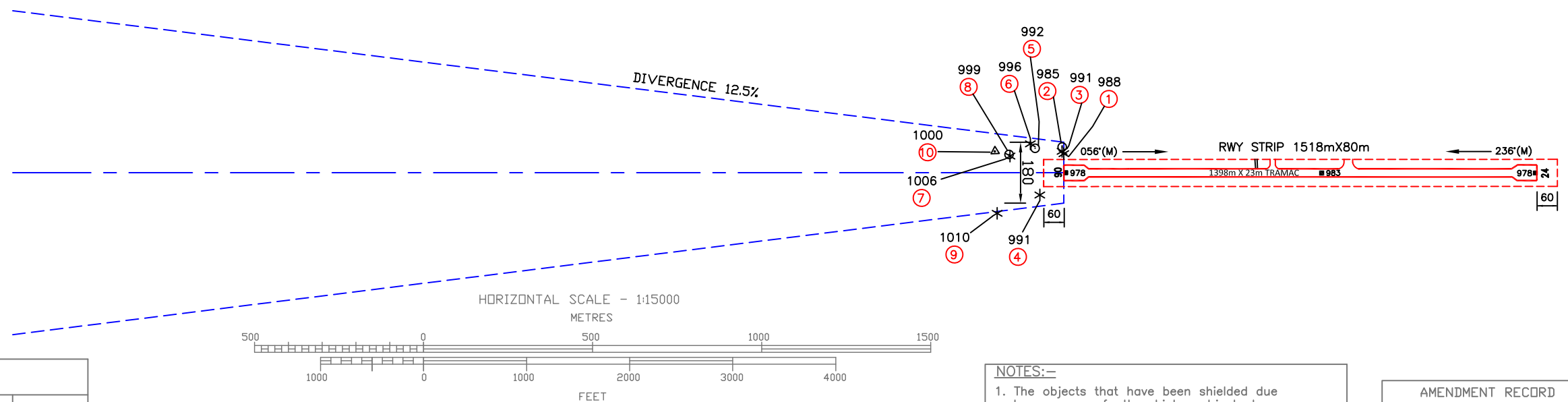

LEGEND		
	PLAN	PROFILE
IDENTIFICATION NUMBER	①	—
RWY ELEV. SPOT	■ 983	—
TREE OR SHRUB	*	①
HOARDING	▲	—
POLE, TOWER, SPIRE, ANTENNA ETC.	○	—

ORDER OF ACCURACY
HORIZONTAL - 3.0m
VERTICAL - 1ft.

APP-06L			
S.No.	UID	OBJECT	ELEV Ft.
1T	VECT_6311	TREE	988
2P	VECT_7037	ELECTRIC POLE	985
3T	VECT_6230	GROUP OF TREES	991
4T	VECT_6306	TREE	991
5P	VECT_7036	ELECTRIC POLE	992
6T	VECT_6185	GROUP OF TREES	996
7T	VECT_6182	GROUP OF TREES	1006
8P	VECT_7035	ELECTRIC POLE	999
9T	VECT_6175	GROUP OF TREES	1010
10P	VECT_9030	HOARDING	1000

- NOTES:-
- The objects that have been shielded due to presence of other higher objects have not been shown in this chart.
 - Datum - All Elevations are in EGM-08.
 - Periphery road without traffic is no obstacle.
 - Consult Notam for latest information.
 - Rwy directions rounded to nearest degree.(Magnetic)
(In degree minute : Rwy 06/24 =055°52'/235°52')(2010)
(In degree minute : Rwy 06/24 =055°39'/235°39')(2023)
 - Magnetic variation rounded to nearest degree 0.15°E, Annual rate of change 01'E(2010).
 - All obstacles shown in this chart are based on aeronautical obstacle Survey Oct.-2022.
 - Chart prepared based on DGCA CAR Section 9AS & ATM series 'G' Part-1.

AMENDMENT RECORD		
No.	Date	DESCRIPTION

AERODROME ELEVATION 983FT.
 DISTANCE IN METRE.
 ELEVATION IN FEET(EGM-08).
 GRID LINES AND CO-ORDINATES SHOWN ARE BASED ON WGS-84 DATUM.
 UTM ZONE-44N

AERODROME OBSTACLE CHART

TYPE - B

CHITRAKOOT,INDIA
CHITRAKOOT AIRPORT

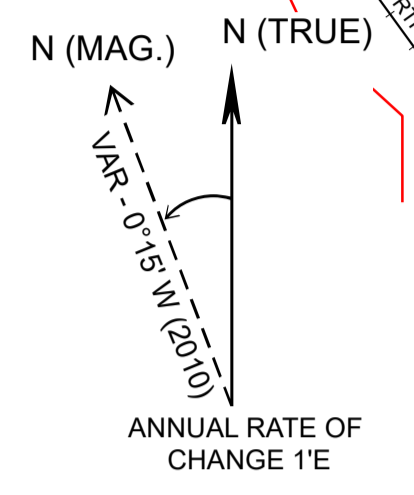
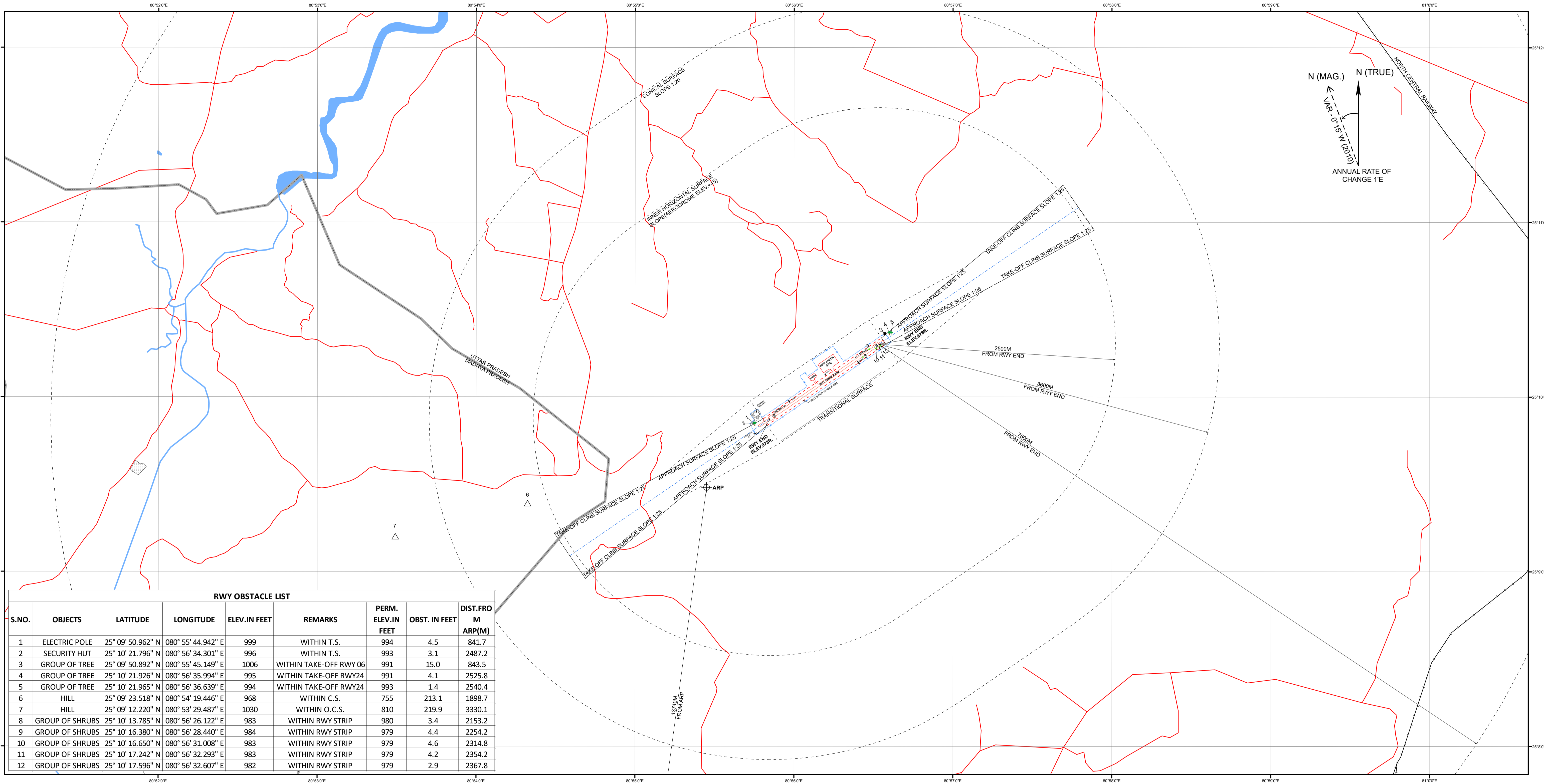

RWY OBSTACLE LIST

S.NO.	OBJECTS	LATITUDE	LONGITUDE	ELEV.IN FEET	REMARKS	PERM. ELEV.IN FEET	OBST. IN FEET	DIST.FRO M ARP(M)
1	ELECTRIC POLE	25° 09' 50.962" N	080° 55' 44.942" E	999	WITHIN T.S.	994	4.5	841.7
2	SECURITY HUT	25° 10' 21.796" N	080° 56' 34.301" E	996	WITHIN T.S.	993	3.1	2487.2
3	GROUP OF TREE	25° 09' 50.892" N	080° 55' 45.149" E	1006	WITHIN TAKE-OFF RWY 06	991	15.0	843.5
4	GROUP OF TREE	25° 10' 21.926" N	080° 56' 35.994" E	995	WITHIN TAKE-OFF RWY24	991	4.1	2525.8
5	GROUP OF TREE	25° 10' 21.965" N	080° 56' 36.639" E	994	WITHIN TAKE-OFF RWY24	993	1.4	2540.4
6	HILL	25° 09' 23.518" N	080° 54' 19.446" E	968	WITHIN C.S.	755	213.1	1898.7
7	HILL	25° 09' 12.220" N	080° 53' 29.487" E	1030	WITHIN O.C.S.	810	219.9	3330.1
8	GROUP OF SHRUBS	25° 10' 13.785" N	080° 56' 26.122" E	983	WITHIN RWY STRIP	980	3.4	2153.2
9	GROUP OF SHRUBS	25° 10' 16.380" N	080° 56' 28.440" E	984	WITHIN RWY STRIP	979	4.4	2254.2
10	GROUP OF SHRUBS	25° 10' 16.650" N	080° 56' 31.008" E	983	WITHIN RWY STRIP	979	4.6	2314.8
11	GROUP OF SHRUBS	25° 10' 17.242" N	080° 56' 32.293" E	983	WITHIN RWY STRIP	979	4.2	2354.2
12	GROUP OF SHRUBS	25° 10' 17.596" N	080° 56' 32.607" E	982	WITHIN RWY STRIP	979	2.9	2367.8

LEGEND

AERODROME REFERENCE POINT 25°09'29.00"N 080°55'27.00"E	
STATE BOUNDARY	
ROADS	
RIVER	
BUILD-UP AREA	

ORDER OF ACCURACY	
TAKE-OFF AND APPROACH AREAS	
HORIZONTAL	REMARK
5M	AT POINT OF ORIGIN INCREASING AT A RATE OF 1 PER 500.
VERTICAL	REMARK
0.5M	IN THE FIRST 300M AND INCREASING AT A RATE OF 1 PER 1000.
OTHER AREAS	
HORIZONTAL	REMARK
5M	WITHIN 5000M OF THE ARP AND 12M BEYOND THAT AREA.
VERTICAL	REMARK
1M	WITHIN 1500M OF THE ARP INCREASING AT A RATE OF 1 PER 1000.

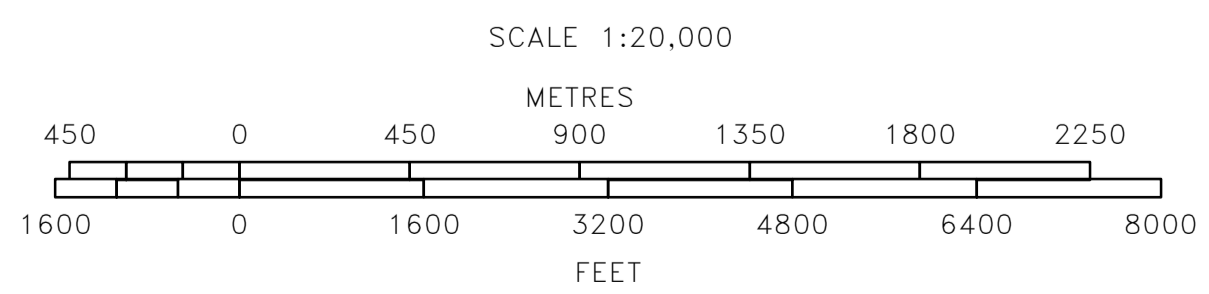

NOTE :

- 1.OBSTACLES SHOWN ARE THOSE WHICH PENETRATE THE SURFACES SPECIFIED IN ANNEX 14, VOL-1, CHAPTER-4 & GSR.
- 2.TORA FOR RWY 06 IS 1398M.
- 3.TO BRING OUT THE CLARITY IN THE OBSTACLES DEPICTED IN THE APPROACH AND TAKE-OFF SURFACE, ONLY HIGHER OBSTACLES HAVE BEEN SHOWN FROM GROUP OF OBSTACLES.
- 4.ALL OBSTACLES ARE SHOWN IN THE CHART BASED ON AERONAUTICAL SURVEY OCTOBER,2022
- 5.TOPOGRAPHIC FEATURES SOURCE- WORLD TOPO MAP, ESRI

AMENDMENT RECORD		
NO.	DATE	ENTERED BY