

TEL: +91-11-24632950 Extn: 2219/2233 AFS: VIDDYXAX FAX: +91-11-24615508 Email: gmais@aai.aero	INDIA AERONAUTICAL INFORMATION SERVICE AIRPORTS AUTHORITY OF INDIA RAJIV GANDHI BHAVAN SAFDARJUNG AIRPORT NEW DELHI – 110003	69/2026
		16 MAR 2026

File No. ATM-19013(19)/1/2026-ATM

Following supplement is issued for information, guidance and necessary action.

sd/-

विपिन कुमार

VIPIN KUMAR

अध्यक्ष/CHAIRMAN

भारतीय विमानपत्तन प्राधिकरण

AIRPORTS AUTHORITY OF INDIA

[EFFECTIVE DATE: 14 MAY 2026]

COMMISSIONING OF NEW AIRCRAFT STANDS ON APRON 1
CHAUDHARY CHARAN SINGH INTERNATIONAL AIRPORT
LUCKNOW (VILK)

INTRODUCTION

The purpose of this AIP supplement is to inform all the stakeholders (Airline, ANSP, and Regulator, etc.), pertaining to the following changes at Chaudhary Charan Singh International Airport Limited.

- i) Commissioning of new aircraft stands on Apron 1 with MARS stand 101 & 102.
- ii) Pushback and startup procedures for Aircraft Stand 101L, 101, 101R, 102L, 102 and 102R.

1. COMMISSIONING NEW AIRCRAFT STANDS ON APRON 1: STANDS 101L, 101, 101R 102L, 102 & 102R.

At Chaudhary Charan Singh International Airport Lucknow, new aircraft stands designated as 101L, 101, 101R, 102L, 102, 102R are commissioned in Apron 1. The details of new aircraft stand in Apron 1 are as shown below:

Stand No.	Coordinates	Suitability	PCR	Elevation (FT)	Aircraft Type	Remarks	Contact/Remote
101L	264548.787N 0805233.775E	A321/ B739	1460/R/C/W/T	403	Code C	Power-in/ Pushback	Remote
101	264549.508N 0805234.533E	A359/ B773	1460/R/C/W/T	403	Code D/E	Power-in/ Pushback	Remote
101R	264549.544N 0805235.228E	A321/ B739	1460/R/C/W/T	403	Code C	Power-in/ Pushback	Remote
102L	264548.826N 0805236.707E	A321/ B739	1460/R/C/W/T	404	Code C	Power-in/ Pushback	Remote
102	264549.549N 0805237.528E	A359/ B773	1460/R/C/W/T	404	Code D/E	Power-in/ Pushback	Remote
102R	264549.586N 0805238.162E	A321/ B739	1460/R/C/W/T	404	Code C	Power-in/ Pushback	Remote

Note: All stands have been provided with aircraft stand identification signs and AVDGS.

- **Insert** details of aircraft stands of Apron 1 in VILK AD 2.23 of eAIP India as shown above.

AMENDMENT/CANCELLATIONS

The text of the amendments is arranged as under:

1	Text to be deleted is shown with a line through it.	Text to be deleted
2	The new text to be inserted is highlighted with yellow shading.	New text to be inserted
3	Text to be deleted is shown with a line through it Followed by the replacement text which is highlighted with yellow shading	New text to replace existing text

1. **Amend** VILK AD 2.15 OTHER LIGHTING, SECONDARY POWER SUPPLY in eAIP India As Follows.

5	Remarks	Aircraft stand maneuvering guidance light provided from Aircraft stand 103L 101L up-to aircraft stand 14 and stand 212 to stand 216.
---	---------	--

2. **AMEND** VILK AD 2.20 (LOCAL AERODROME REGULATIONS) in eAIP India as follows.

I. PUSHBACK PROCEDURES:

Pushback and taxi Procedure for stand **101L, 101, 101R, 102L, 102, 102R, 103L, 103, 103R, 104L, 104, 104R, 105L, 105R, 106L, and 12, 7 to 14 and 212 to 216.**

i. Stand No. 103L

... ..

... ..

ii. **Stand No. 103R. (~~CODE C/D/E ACFT~~)**

... ..

xxxiv. Stand 101L

a) Pushback and Startup may be given facing west on TXL L. Taxi out via TWY P1. TWY P3 and TRP 3 will be blocked.

b) Pushback not permitted on Stand 101R, 102 and 102L.

c) Docking not permitted on Stand 101R.

d) Pushback and Startup may be given facing East on TXL L. Taxi out via TWY E/ D/ C/ B. TWY P3 will be blocked.

e) Pushback not permitted on Stand 101R, 102, 102L and 103.

f) Docking not permitted on Stand 101 and 101R.

xxxv. Stand 101

a) Pushback and Startup may be given facing west on TXL L. Taxi out via TWY P1. TWY P3 and TRP 3 will be blocked.

b) Pushback not permitted on Stand 102L, 102 and 102R.

c) Docking not permitted on Stand 101L, 101R, 102L and 102.

d) Pushback and Startup may be given facing East on TXL L. Taxi out via TWY E/ D/ C/ B. TWY P3 and TRP 3 will be blocked.

e) Pushback not permitted on Stand 102L, 102, 102R, 103L and 103.

f) Docking not permitted on Stand 101L and 101R.

xxxvi. Stand 101R

- a) Pushback and Startup may be given facing west on TXL L. Taxi out via TWY P1/ P3. TWY P3 and TRP 3 will be blocked.**
- b) Pushback not permitted on Stand 101L, 102L, 102 and 102R.**
- c) Docking not permitted on Stand 101, 102L and 102.**
- d) Pushback and Startup may be given facing East on TXL L. Taxi out via TWY E/ D/ C/ B. TWY P3 and TRP 3 will be blocked.**
- e) Pushback not permitted on Stand 101L, 102L, 102, 102R, 103L and 103.**
- f) Docking not permitted on Stand 101, 101L and 102L.**

xxxvii. Stand 102L

- a) Pushback and Startup may be given facing west on TXL L. Taxi out via TWY P1/ P3. TRP 3 will be blocked.**
- b) Pushback not permitted on Stand 101L, 101, 101R, and 102R.**
- c) Docking not permitted on Stand 102 and 102R.**
- d) Pushback and Startup may be given facing East on TXL L. Taxi out via TWY E/ D/ C/ B. TRP 3 will be blocked.**
- e) Pushback not permitted on Stand 101L, 101, 101R, 102R, 103L and 103.**
- f) Docking not permitted on Stand 101, 101R and 102.**

xxxviii. Stand 102

- a) Pushback and Startup may be given facing west on TXL L, pull abeam stand 102L. Taxi out via TWY P1/ P3. TRP 3 will be blocked.**
- b) Pushback not permitted on Stand 101, 102R, 103L and 103.**
- c) Docking not permitted on Stand 102R.**
- d) Pushback and Startup may be given facing East on TXL L. Taxi out via TWY E/ D/ C/ B.**
- e) Pushback not permitted on Stand 101L, 101, 101R, 103L and 103.**
- f) Docking not permitted on Stand 101L, 101 and, 101R , 102L and 102R.**

xxxix. Stand 102R

- a) **Pushback and Startup may be given facing west on TXL L, pull abeam stand 102L. Taxi out via TWY P1/ P3. TRP 3 will be blocked.**
- b) **Pushback not permitted on Stand 101, 101R, 102L and 103L.**
- c) **Docking not permitted on Stand 102, 102L and 102R.**
- d) **Pushback and Startup may be given facing East on TXL L. Taxi out via TWY E/ D/ C/ B. TRP 3 will be blocked.**
- e) **Pushback not permitted on Stand 101, 101R, 102L, 103L and 103.**
- f) **Docking not permitted on Stand 102 and 102L.**

II. PRECAUTIONS TO BE TAKEN WHILE GIVING PUSHBACK:

- Stand **101L, 101, 101R, 102L, 102, 102R,** 103L, 103, 103R, 104L, 104, 104R, 105L, 105R, 106L, ~~13 and 14~~ **212, 213, 214, 215 and 216** have been provided with AVDGS. A-VDGS will be operational, **24X7.**
- **When a Code E aircraft is parked on stand 101, code C aircraft cannot be parked on Stand 101L and 101R.**
- **When a Code E aircraft is parked on stand 102, code C aircraft cannot be parked on Stand 102L and 102R.**
- When a Code E aircraft is parked on stand 103, code C aircraft cannot be parked on Stand 103L and 103R.
- When a Code E aircraft is parked on stand 104, code C aircraft cannot be parked on Stand 104L and 104R.
- Stand 12 is interdependent with Stand 13, if Code D/E parked on stand 12 only Code C can be parked on Stand 13 and vice versa.

3. **Amend** the following paragraphs of VILK AD 2.22 (FLIGHT PROCEDURES) in eAIP India as shown below:

I. LOW VISIBILITY PROCESS:

4.4 Low Visibility Procedure Taxi Route

- 4.4.3 The following taxi routes should be used for arrivals-

- a) After landing on RWY 27 via TWY D, E, P1 or P3 and then taxi to parking stands ~~103L~~ **101L** to 14 as applicable.
- b) Taxi routing for departures - Taxi to CAT II/ III holding position RWY 27 via TWY 'B' or 'C' from stand No. ~~103L~~ **101L** to 14:

5.2 Aerodrome Ground Lighting System

5.2.4 Parking stands from ~~103L~~ **101L** to 14 **and stand 212 to 216** have been provided with CAT III Centerline lighting system.

7.9 Action by CISF and LIAL Security

7.9.2.1 APRON CONTROL shall coordinate with CISF to close barrier on perimeter road near glide path and Bay No. ~~103L~~ **101L** for stopping the vehicular movement except Follow Me Jeep, ARFF vehicles and AAI vehicles fitted with RT and VELO. Prior permission of ATC and Apron Control is essential to permit other vehicle on this perimeter road.

4. **Replace** *Aerodrome Chart* in VILK AD 2.24 of eAIP India with the *Aerodrome Chart* of this AIP supplement.
5. **Replace** *Aircraft Parking/Docking Chart – Apron 1* in VILK AD 2.24 of eAIP India with the *Aircraft Parking/Docking Chart – Apron 1* of this AIP Supplement.

AERODROME CHART

ARP
26° 45' 42.682" N
080° 53' 00.351" E

ELEV. : 406 ft.

TWR 118.6
STAND BY 122.5

LUCKNOW, INDIA
CHAUDHARY CHARAN SINGH INTL. AIRPORT

RWY	DIRECTION	THR. CO-ORDINATES	THR. ELEV.	BEARING STRENGTH (PCR)
09	089°	26° 45' 37.36100"N	405	1181/F/C/W/T
		080° 52' 36.12600"E		
27	269°	26° 45' 38.62463"N	400	1181/F/C/W/T
		080° 54' 09.75108"E		

DATUM: WGS 84
GEOID MODEL: EGM 2008
ELEVATIONS IN FEET
DIMENSIONS IN METRES
RWY BEARINGS ARE MAGNETIC
TAXIWAYS 23m WIDE

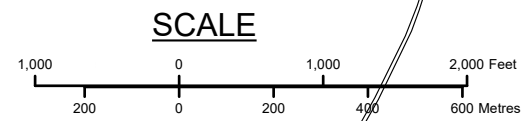
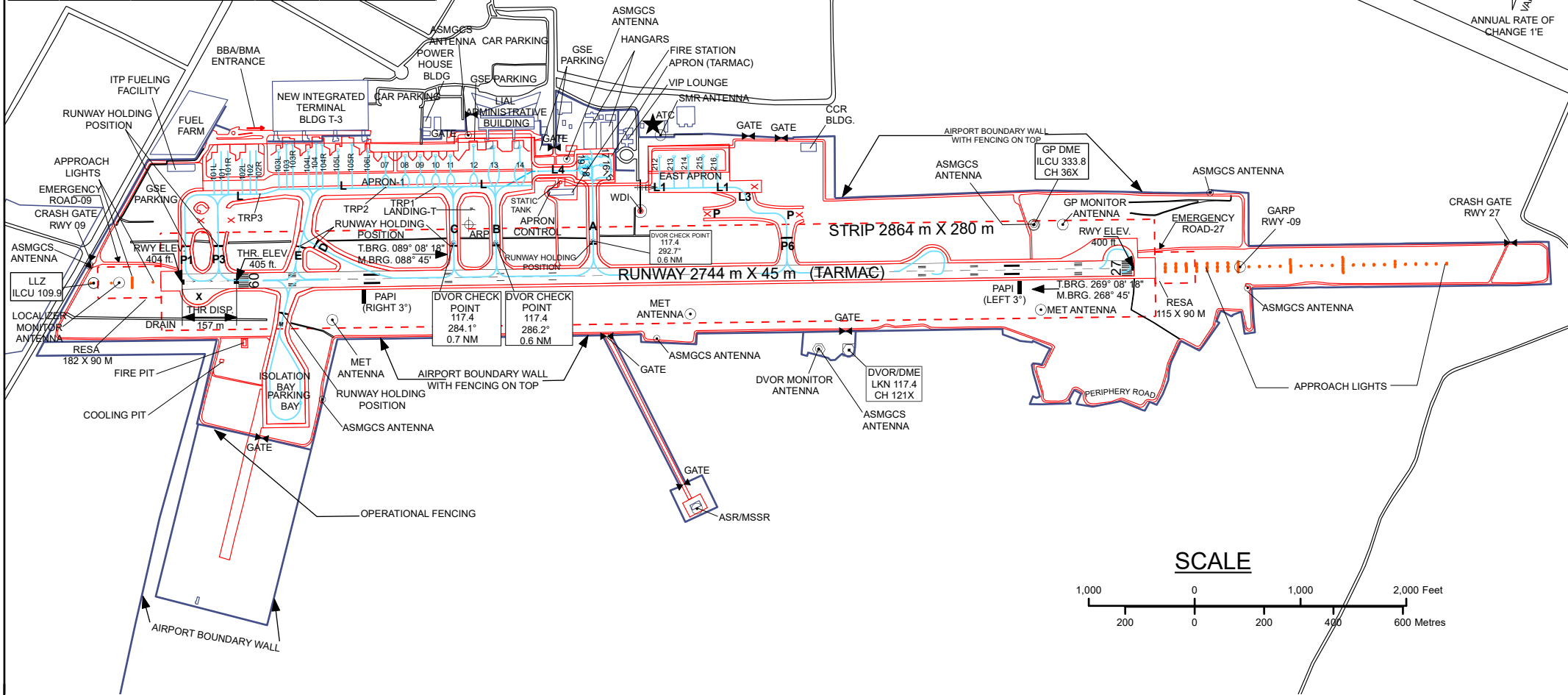
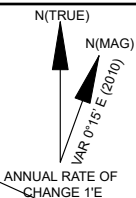

MARKING AIDS RUNWAY 09/27

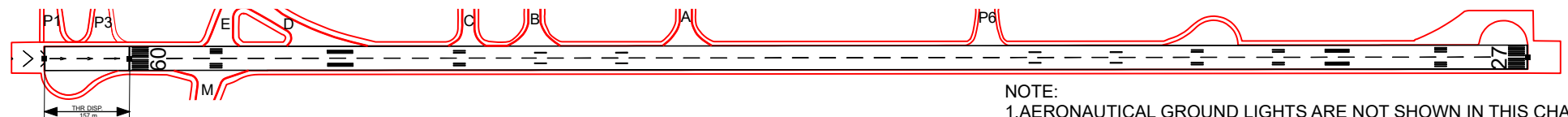

NOTE:
1. AERONAUTICAL GROUND LIGHTS ARE NOT SHOWN IN THIS CHART.

AERONAUTICAL INFORMATION UPTO MAR 2026

MAP REF: OAL/KW/ADC/2026/N 1/3
DATE OF ISSUE : 16.03.2026
SUPERSEDES DATE : 12.03.2026

AIRCRAFT PARKING /DOCKING CHART
APRON -1

APRON ELEV.406 ft.

TWR 118.6
STAND BY 122.5

LUCKNOW, INDIA
CHAUDHARY CHARAN SINGH INTL. AIRPORT

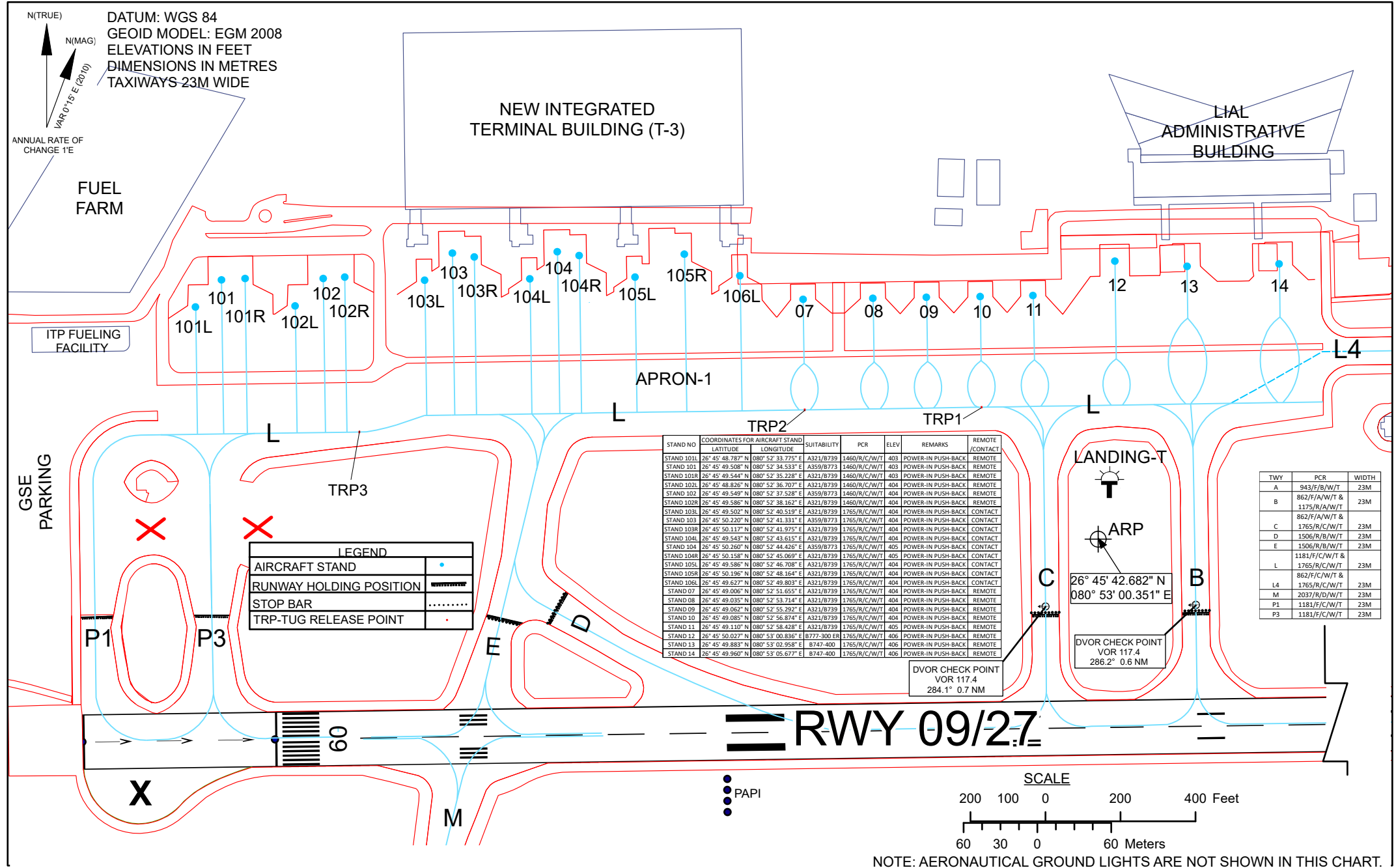

DATE OF AERONAUTICAL INFORMATION UPTO MAR 2026

MAP REF : QAL/KW/POC-A1/2026 IN 1/2
DATE OF ISSUE : 12.03.2026
SUPERSEDES DATE : 11.03.2026