

TEL: +91-11-24632950 Extn: 2219/2233 AFS: VIDDYXAX FAX: +91-11-24615508 Email: gmais@aai.aero	INDIA AERONAUTICAL INFORMATION SERVICE AIRPORTS AUTHORITY OF INDIA RAJIV GANDHI BHAVAN SAFDARJUNG AIRPORT NEW DELHI – 110003	78/2026
		02 APR 2026

File No. ATM-19013(19)/1/2026-ATM

Following supplement is issued for information, guidance and necessary action.

sd/-
विपिन कुमार
VIPIN KUMAR
अध्यक्ष/CHAIRMAN
भारतीय विमानपत्तन प्राधिकरण
AIRPORTS AUTHORITY OF INDIA

[EFFECTIVE DATE: 14 MAY 2026]

COMMISSIONING OF NEW APRON
SURAT AIRPORT, SURAT (VASU)

1. **INTRODUCTION**

The purpose of this AIP Supplement is to inform external and internal stakeholders of Surat Airport regarding the commissioning part parallel Taxiway “E” and New Aircraft Parking stands at Surat Airport as per following details:

2. **COMMISSIONING OF NEW STANDS:**

STAND NO	COORDINATES	SUITABILITY	ELEV FEET	PCR	REMARKS
16	210714.021N 0724443.135E	A321/B739	20	800/R/B/W/T	POWER IN/PUSH BACK
17	210713.059N 0724442.190E	A321/B739	18	800/R/B/W/T	POWER IN/PUSH BACK
18	210711.857N 0724441.002E	A321/B739	18	800/R/B/W/T	POWER IN/PUSH BACK
19	210710.896N 0724443.135E	A321/B739	18	800/R/B/W/T	POWER IN/PUSH BACK
20	210714.021N 0724443.135E	A321/B739	18	800/R/B/W/T	POWER IN/PUSH BACK

AMENDMENT/CANCELLATIONS

The text of the amendments is arranged as under:

1.	Text to be deleted is shown with a line through it.	Text to be deleted
2.	New text to be inserted is highlighted with yellow shading.	New text to be inserted
3.	Text to be deleted is shown with a line through it Followed by the replacement text which is highlighted with yellow shading	New text to replace existing text

1. **Amend VASU AD 2.8 (APRONS, TAXIWAYS AND CHECK LOCATIONS/ POSITIONS DATA) of eAIP India as shown below:**

1	Designation, surface and strength of aprons	Refer Aircraft parking/Docking Chart	
2	Designation, width, surface and strength of taxiways	Refer Aircraft parking/Docking Chart	
3	Location and elevation of Altimeter checkpoints	Location	On the TWYs 'A' & 'B'. All aircraft Stands
		Elevation	Elevation: 25 FT Refer Aircraft Parking/Docking Chart
4	Location of VOR checkpoints	TWY A: 210707.40N 0724441.58E/ELEV: 17 FT TWY B: 210713.09N 0724446.97E/ELEV: 17 FT TWY E1: 210733.509N 0724507.889E / ELEV: 22 FT TWY E2: 210713.092N 0724446.969E / ELEV: 17 FT TWY E3: 210707.404N 0724441.579E / ELEV: 17 FT TWY E4: 210648.639N 0724422.943E / ELEV: 17 FT TWY E6: 210624.925N 0724359.782E / ELEV: 18 FT	
6	Remarks	i. Isolated Aircraft parking Position details: a) Location: NE of THR RWY 04 b) Dimensions: 75MX65M c) Link TWY: TWY D, 228M 70.35M X 23M d) Surface: Concrete e) Strength (PCN): 66/R/A/W/T	

ii. Coordinates of RWY Holding Position

TWY	COORDINATES	ELEVATION(FT)
-----	-------------	---------------

~~a) TWY A: 210707.2733N 0724441.7291E ELEV: 17FT~~

~~b) TWY B: 210712.8413N 0724447.2570E ELEV: 17FT~~

~~c) TWY C: 210648.5155N 0724423.1050E ELEV: 17FT~~

~~d) TWY D: 210642.8965N 0724417.5178E ELEV: 17 FT~~

~~e) TWY E1: 210733.374N 0724508.047E ELEV: 22.63 FT~~

a) TWY E1: 210733.374N 0724508.0466E / ELEV: 22 FT

b) TWY E2: 210712.841N 0724447.257E / ELEV: 17FT

c) TWY E3: 210707.273N 0724441.729E / ELEV: 17FT

d) TWY E4: 210648.516N 0724423.105E / ELEV: 17 FT

e) TWY E5: 210642.897N 0724417.518E / ELEV: 17 FT

f) TWY E6: 210624.765N 0724359.964E / ELEV: 18 FT

iii. Coordinates of RWY & Taxi Intersection

TWY	COORDINATES	ELEVATION(FT)
-----	-------------	---------------

~~a) TWY A: 210705.0732N 0724444.2476E ELEV: 19FT~~

~~b) TWY B: 210719.6429N 0724449.7823E ELEV: 18FT~~

~~c) TWY C: 210646.4716N 0724425.7696E ELEV: 19FT~~

~~d) TWY D: 210640.6897N 0724420.0337E ELEV: 19FT~~

~~e) TWY E1: 210731.353N 0724510.350E ELEV: 24.93FT~~

a) TWY E1: 210731.353N 0724510.350E / ELEV: 25 FT

b) TWY E2: 210710.643N 0724449.782E / ELEV: 18 FT

c) TWY E3: 210705.073N 0724444.248E / ELEV: 19 FT

d) TWY E4: 210646.472N 0724425.770E / ELEV: 18 FT

e) TWY E5: 210640.690N 0724420.034E / ELEV: 18 FT

f) TWY E6: 210622.743N 0724402.217E / ELEV: 20 FT

iv. Gravity Model: EGM-08

2. **Amend VASU AD 2.20 LOCAL AERODROME REGULATIONS** of eAIP India as shown below:

~~1. Pushback Procedures on Main Apron:~~

~~i. Only one aircraft from set of stands nos. 1, 2, 14 and 15 shall be allowed to pushback facing SW direction and be instructed to remain clear of taxilanes from TWY B to any of the stand nos. 3 to 10.~~

~~ii. Aircraft on stand no.3 may be allowed to pushback either in the SW direction or NE direction~~

- a. when pushback is allowed facing SW direction, the aircraft shall pushback deep and remain clear of taxi lanes from TWY B to Stand Nos. 3 to 10.
- b. when pushback is allowed facing NE direction, the aircraft shall pushback deep and remain clear of taxi lanes from TWY B to Stand Nos. 1, 2, 14 and 15.
- iii. ~~Only one Aircraft from Stand No. 4 or 5 should be allowed to pushback facing NE direction and to remain clear of taxi lanes from TWY B to Stand Nos. 1, 2, 3, 14 and 15, if-~~
- a. the arriving Aircraft is to be parked on either of the Stands no. 1, 2, 3, 14 and 15,
- b. any aircraft from stands No. 1, 2, 14 and 15 is to be given pushback clearance keeping itself clear of TWY B.
- iv. ~~Only one aircraft from Stand No. 5, 6, 7, 8 and 9 will be allowed pushback facing SW direction and be instructed to pull ahead to remain clear of TWY B. Taxi-out clearance to enter RWY for such aircraft will be via TWY A.~~
- v. ~~Simultaneous Pushback from the set of bays (4, 5, 6) and (1, 2, 14, 15) may be allowed facing NE and SW directions respectively with instructions to remain clear of TWY B. Taxiout instructions for each such aircraft will be given via TWY B.~~
- vi. ~~Only one aircraft from the set of stands nos. (9, 10, 21) shall be allowed to pushback facing NE direction and be instructed to remain clear of taxi lanes from TWY B to stand no. 8 to 1.~~
- vii. ~~Aircraft on stand no. 8 may be allowed to push back either in the SW direction or NE direction.~~
- a) ~~When pushback is allowed facing the SW direction, the aircraft shall be instructed to push back deep and remain clear of taxi lanes from TWY A to stand Nos. 8, 9, 10 and 21.~~
- b) ~~When pushback is allowed facing NE direction, the aircraft shall be instructed to push back deep and remain clear off taxi lanes from TWY A to stand Nos. 8 to 1.~~
- viii. ~~Only one aircraft from stands Nos. 6 and 7 shall be allowed to pushback facing SW direction and remain to clear off taxi lanes from TWY A to stand Nos. 8, 9, 10 and 21, ifa)~~
- ~~The arriving aircraft is to be parked on stands No. 8, 9, 10 and 21.~~
- b) ~~Any aircraft from stands No. 9, 10 and 21 is to be given pushback clearance keeping itself clear of TWY A.~~

1 Push back procedure on the main apron

i) All stands are power -in and push back stands in the Main Apron.

For Runway 04

I. Push back from stand 1,2,3,14 and 15 shall be facing the south-west direction only.

II. Aircraft from stand 2,3 and 15 shall be deep push abeam stand 1 to keep taxiway A clear (if required)

III. Push back from stand 4,5,6,7,8,16,17,18, and 19 should facing south-west direction only.

IV. Aircraft from stands 4 and 16 shall pull abeam stand 5 to keep taxiway A clear (if required)

V. Aircraft from stand 8 shall push abeam 6 to keep taxiway B clear (if required).

VI. Push back from stand 9,10,20 and 21 shall be facing the north -east direction only.

For Runway 22

I. Push back from stand 1,2,3,14 and 15 shall be facing the south-west direction only.

II. Aircraft from stands 2,3 and 15 shall be deep push abeam stand 1 to keep taxiway A clear (if required).

III. Push back from stand 4 to 10 and 16 to 21 shall be facing the north-east direction only. Aircraft from stands 7,8, and 19 shall deep push abeam stand 10 to keep taxiway B clear (if required).

2.

3. Amend VASU AD 2.23 ADDITIONAL INFORMATION eAIP India as shown below:

RWY	From TWY Intersection	TORA (M)
RWY 22	TWY A TWY E3	1790
RWY 22	TWY A TWY E2	2025

4. **Replace** Aerodrome Chart in VASU AD 2.24 of eAIP India with the Aerodrome Chart of this AIP supplement.

5. **Replace** Aircraft Parking/Docking Chart in VASU AD 2.24 of eAIP India with the Aircraft Parking/Docking Chart of this AIP supplement.

AIRCRAFT PARKING/
DOCKING CHART

MAIN APRON ELEV 20ft
OLD APRON ELEV 17ft

TWR 118.550
BACKUP 118.050

SURAT, INDIA

SURAT AIRPORT

- * DATUM :
- HORIZONTAL : WGS-84
- VERTICAL : EGM-08
- * DIMENSIONS IN METRES
- * ELEVATIONS IN FEET.

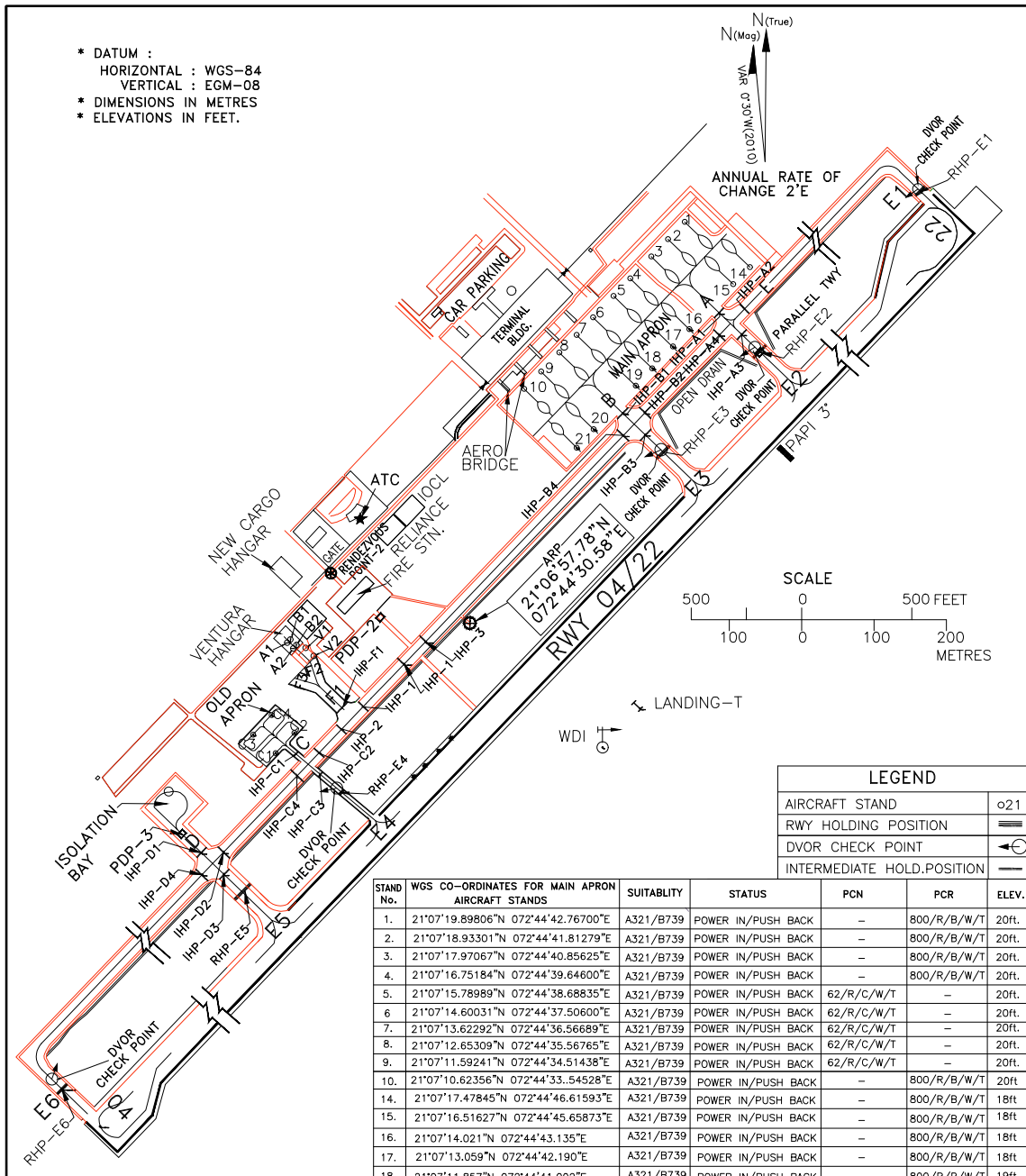

TAXIWAY	PCN	PCR	WIDTH
A	62/R/C/W/T	-	23M
B	62/R/C/W/T	-	23M
C	26.2/F/C/W/T	-	10.5M
D	66/R/A/W/T	-	23M
E	-	800/R/B/W/T	23M
E1	74/R/B/W/T	-	23M
E2	62/R/C/W/T	-	23M
E3	62/R/C/W/T	-	23M
E4	26.2/F/C/W/T	-	10.5M
E5	66/R/A/W/T	-	23M
E6	-	780/R/B/W/T	23M
F1	18/R/B/W/T	-	23M
F2	18/R/B/W/T	-	23M
F3	18/R/B/W/T	-	23M

STAND No.	WGS CO-ORDINATES FOR MAIN APRON AIRCRAFT STANDS	SUITABILITY	STATUS	PCN	PCR	ELEV.
1.	21°07'19.89806"N 072°44'42.76700"E	A321/B739	POWER IN/PUSH BACK	-	800/R/B/W/T	20ft.
2.	21°07'18.93301"N 072°44'41.81279"E	A321/B739	POWER IN/PUSH BACK	-	800/R/B/W/T	20ft.
3.	21°07'17.97067"N 072°44'40.85625"E	A321/B739	POWER IN/PUSH BACK	-	800/R/B/W/T	20ft.
4.	21°07'16.75184"N 072°44'39.64600"E	A321/B739	POWER IN/PUSH BACK	-	800/R/B/W/T	20ft.
5.	21°07'15.78989"N 072°44'38.68835"E	A321/B739	POWER IN/PUSH BACK	62/R/C/W/T	-	20ft.
6.	21°07'14.60031"N 072°44'37.50600"E	A321/B739	POWER IN/PUSH BACK	62/R/C/W/T	-	20ft.
7.	21°07'13.62292"N 072°44'36.56689"E	A321/B739	POWER IN/PUSH BACK	62/R/C/W/T	-	20ft.
8.	21°07'12.65309"N 072°44'35.56765"E	A321/B739	POWER IN/PUSH BACK	62/R/C/W/T	-	20ft.
9.	21°07'11.59241"N 072°44'34.51438"E	A321/B739	POWER IN/PUSH BACK	62/R/C/W/T	-	20ft.
10.	21°07'10.62356"N 072°44'33.54528"E	A321/B739	POWER IN/PUSH BACK	-	800/R/B/W/T	20ft.
14.	21°07'17.47845"N 072°44'46.61593"E	A321/B739	POWER IN/PUSH BACK	-	800/R/B/W/T	18ft.
15.	21°07'16.51627"N 072°44'45.65873"E	A321/B739	POWER IN/PUSH BACK	-	800/R/B/W/T	18ft.
16.	21°07'14.021"N 072°44'43.135"E	A321/B739	POWER IN/PUSH BACK	-	800/R/B/W/T	18ft.
17.	21°07'13.059"N 072°44'42.190"E	A321/B739	POWER IN/PUSH BACK	-	800/R/B/W/T	18ft.
18.	21°07'11.857"N 072°44'41.002"E	A321/B739	POWER IN/PUSH BACK	-	800/R/B/W/T	19ft.
19.	21°07'10.896"N 072°44'40.049"E	A321/B739	POWER IN/PUSH BACK	-	800/R/B/W/T	18ft.
20.	21°07'08.497"N 072°44'37.640"E	A321/B739	POWER IN/PUSH BACK	-	800/R/B/W/T	18ft.
21.	21°07'07.45851"N 072°44'36.65095"E	A321/B739	POWER IN/PUSH BACK	-	800/R/B/W/T	19ft.

OLD APRON						
C1.	21°06'50.51765"N 072°44'19.35182"E	BEECH200T	POWER IN/POWER OUT	33/R/B/W/T	-	17ft.
C2.	21°06'51.62786"N 072°44'20.42726"E	BEECH200T	POWER IN/POWER OUT	33/R/B/W/T	-	17ft.
C3.	21°06'51.50791"N 072°44'18.01885"E	BEECH200T	POWER IN/POWER OUT	33/R/B/W/T	-	17ft.
C4.	21°06'52.62018"N 072°44'19.09674"E	BEECH200T	POWER IN/POWER OUT	33/R/B/W/T	-	17ft.
ISOL. BAY	21°06'48.29224"N 072°44'13.18252"E	A321	POWER IN/POWER OUT	66/R/A/W/T	-	18ft.

VENTURA HANGAR						
A1.	21°06'56.556"N 072°44'19.934"E	C208B	POWER IN/PUSH BACK	-	-	21ft.
A2.	21°06'56.250"N 072°44'20.290"E	C208B	POWER IN/PUSH BACK	-	-	20ft.
B1.	21°06'56.738"N 072°44'20.117"E	C208B	POWER IN/PUSH BACK	-	-	20ft.
B2.	21°06'56.434"N 072°44'20.467"E	C208B	POWER IN/PUSH BACK	-	-	20ft.
V1.	21°06'56.286"N 072°44'21.010"E	C208B	POWER IN/PUSH BACK	18/R/B/W/T	-	20ft.
V2.	21°06'55.863"N 072°44'21.493"E	C208B	POWER IN/PUSH BACK	18/R/B/W/T	-	20ft.

DATE OF AERONAUTICAL INFORMATION
MARCH 2025

DRG. No.-AAI/12-PDC/2022
UPDATED ON 05-02-2026

AERODROME CHART

21°06'57.78"N
072°44'30.58"E

AD.ELEV 25ft.

TWR 118.550
BACKUP 118.050

SURAT, INDIA

SURAT AIRPORT

RWY	DIRECTION	THR CO-ORDINATES	THR ELEV.	BEARING STRENGTH
04	043°	21°06'22.49"N 072°44'01.97"E	20ft.	FROM BEGINNING OF RWY 04 TO 655M : 73/R/B/W/T FROM 655M OF RWY 04 TO 2755M : 71/F/C/W/T FROM 2755M OF RWY 04 TO 2906M : 73/R/B/W/T
22	223°	21°07'16.97"N 072°44'56.07"E	19ft.	FROM BEGINNING OF RWY 22 TO 151M : 73/R/B/W/T FROM 151M OF RWY 22 TO 2251M : 71/F/C/W/T FROM 2251M OF RWY 22 TO 2906M : 73/R/B/W/T

* DATUM :
HORIZONTAL : WGS-84
VERTICAL : EGM-08
* DIMENSIONS IN METRES
* ELEVATIONS IN FEET.

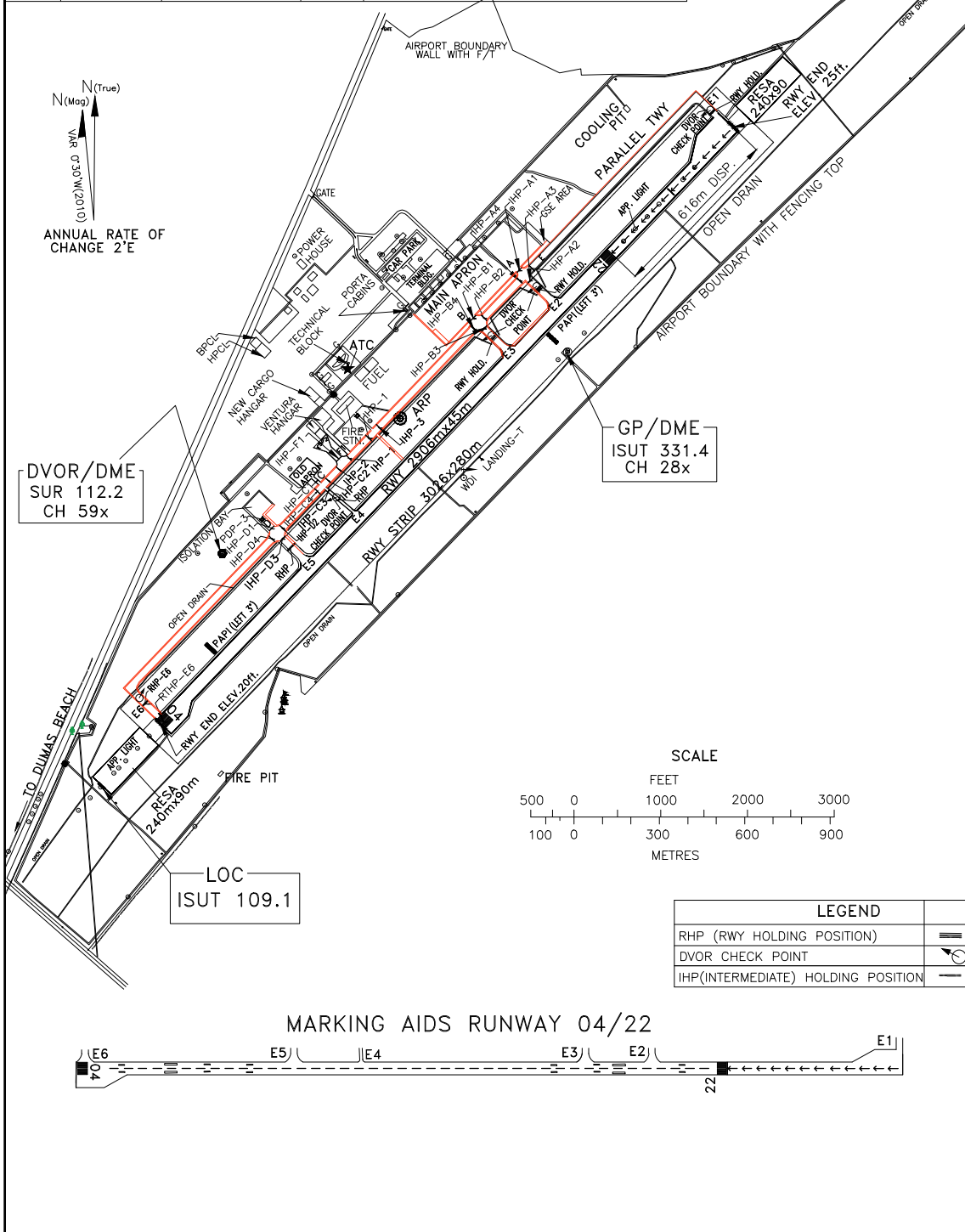

DATE OF AERONAUTICAL INFORMATION
MARCH 2025

DRG. NO. -AAI/11-AC/2022
UPDATED ON 05-01-2026

Airports Authority of India, Carto.